

Optional Equipment

Control Panel (161029)

Single phase simplex control panel for wall mounting Hoffman condensate and boiler feed stock units

- NEMA 4 X and JIC rated
- DIN rail mounting makes replacement easy
- IEC contactor with 120V coil and 1 normally open axillary contact
- Includes mounting plate
- Numbered terminal strip
- Pump pilot light indicates operation
- Waterproof On - Off switch
- Fuse protect contactor coil
- 20 Amp maximum full load amp current draw

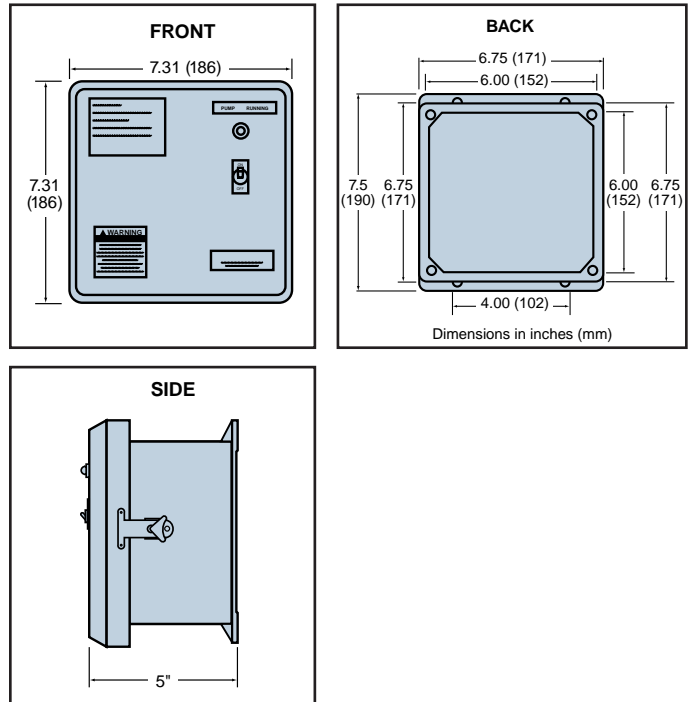

Y-Strainers (Stock)

Part Number DA0036

- 2" (50mm) NPT cast iron body
- Maximum body pressure 250 psig (17.3 bar)

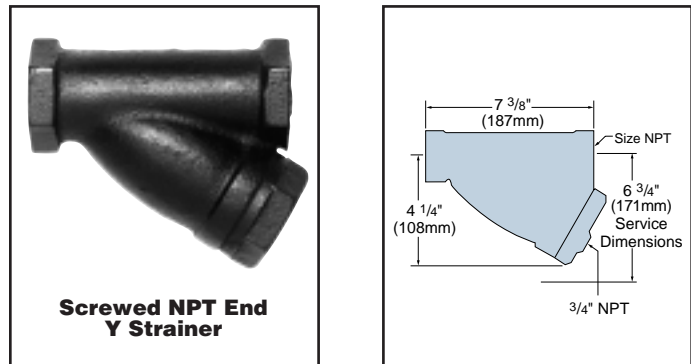

Inlet Basket Strainer (Stock)

Part Number DA0180

- 2" (50mm) NPT cast iron body*
- Top bolted cover allows easy servicing of the screen
- Large dirt pocket minimizes frequency of maintenance
- 1/2" (15mm) NPT side tapping allows easy installation of thermometer
- 3/4" (20mm) NPT cover tapping allows installation of vacuum breaker

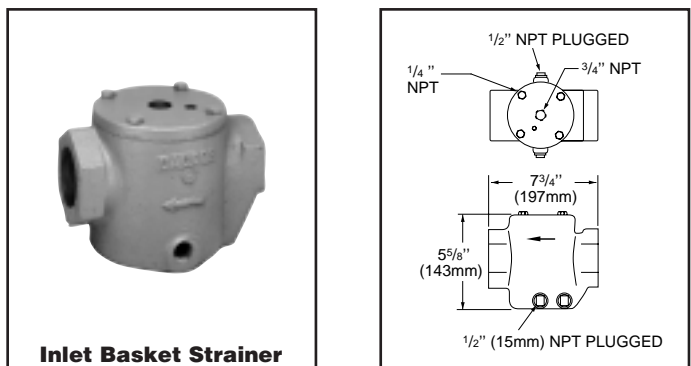

* For larger inlet basket strainers, contact your Hoffman representative.