



automotive booths

EZ PAINT MIXING ROOMS

- EZ TO INSTALL
- EZ TO OPERATE
- EZ TO MAINTAIN
- EZ TO QUICK SHIP

Air flows in through the filtered air intake plenum (located in the ceiling toward one end of the booth) downward through the work area and into the exhaust chamber located in the lower opposite end of the room. Filtered exhaust air is drawn through the exhaust plenum and is discharged upward into the atmosphere through the exhaust stack.

LIGHTING FEATURES

Bright full booth illumination is provided by four-tube, 48", 32-watt, fluorescent light fixtures in the ceiling panels. Each is sealed behind clear tempered safety glass. All fixtures are UL listed and approved for their intended use and placement. The light tubes are not furnished with the fixtures.

CONSTRUCTION FEATURES AND QUALITY STANDARDS

All cabin and plenum sections are made with 18-gauge steel. The personnel access door is prehung in heavy gauge steel galvanized frames for easy installation. Brixon™ latches are provided for the door opening. One 14" x 48" observation window is standard in all paint mix room personnel doors.



Fire suppression and controls are not included.

The exhaust system is driven by a 14" diameter tubeaxial fan with a 1/2 HP motor, producing 1930 SCFM at 1/2" static pressure.

All hardware, filters and sealants needed for installation are included. The control panel and other electrical components may be purchased separately.

Col-Met Spray Booth products comply with all OSHA and NFPA regulations.

EZ PAINT MIXING ROOMS

Model Number	Interior Dimensions			Exterior Dimensions			Access Doors	Lights		Air Flow SCFM	Fan Spec.		Filters	
	Width	Height	Length	Width	Height	Length		Open	S&G		Dia.	HP	Int.	Exh.
PMR-0808	8'-0"	8'-0"	8'-0"	8'-4"	8'-2"	10'-6"	1 with Window	1	0	1930	14"	1/2 HP	4	2
PMR-0810	8'-0"	8'-0"	10'-0"	8'-4"	8'-2"	12'-6"	1 with Window	1	1	1930	14"	1/2 HP	4	2
PMR-0812	8'-0"	8'-0"	12'-0"	8'-4"	8'-2"	14'-6"	1 with Window	1	1	1930	14"	1/2 HP	4	2
PMR-0815	8'-0"	8'-0"	15'-0"	8'-4"	8'-2"	17'-6"	1 with Window	2	1	1930	14"	1/2 HP	4	2

MIXING ROOM CHART WITH DIMENSIONS AND DRAWINGS ON REVERSE SIDE

MIXING ROOM CHART WITH DIMENSIONS AND SPECIFICATIONS

EZ PAINT MIXING ROOM

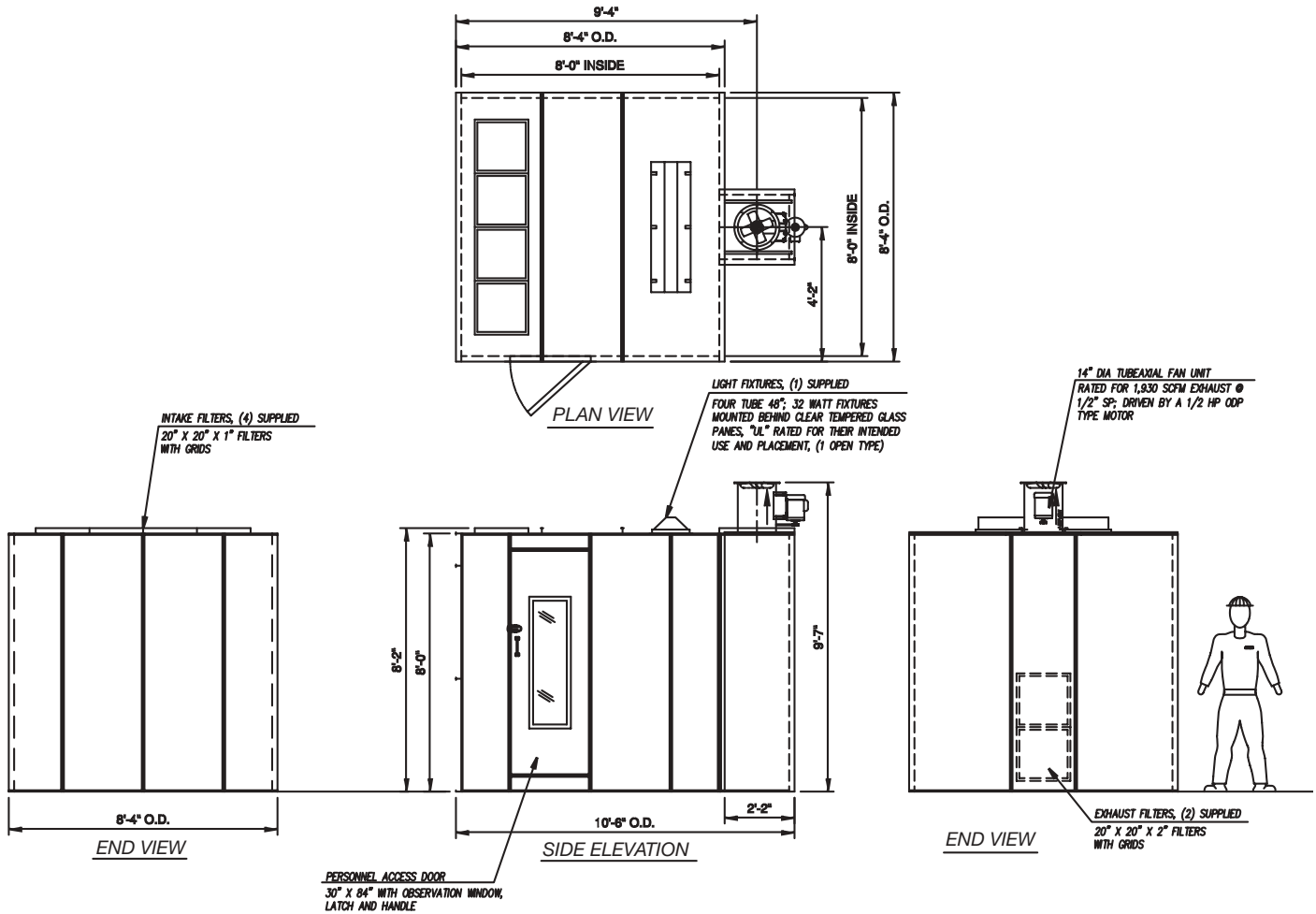

Col-Met Spray Booths

Dallas, TX // e-mail: sales@colmetsb.com

toll free: 888.452.6684 // www.colmetsb.com

02/06 CA

