



# C22000 SERIES

## 3 - 7-1/2 HP Single or Three Phase Single and Two Stage Centrifugal Pumps

- The C22000 Series is a rugged pump built for extra performance.
- Nationally known NEMA JM motors. Nationwide service available from local authorized service stations.
- 3, 5 and 7-1/2 HP sizes with single or three phase options.
- Brass impellers electronically balanced.
- Capacities to 9,200 gallons per hour. Pressures to 85 PSI



**For Extra Performance**

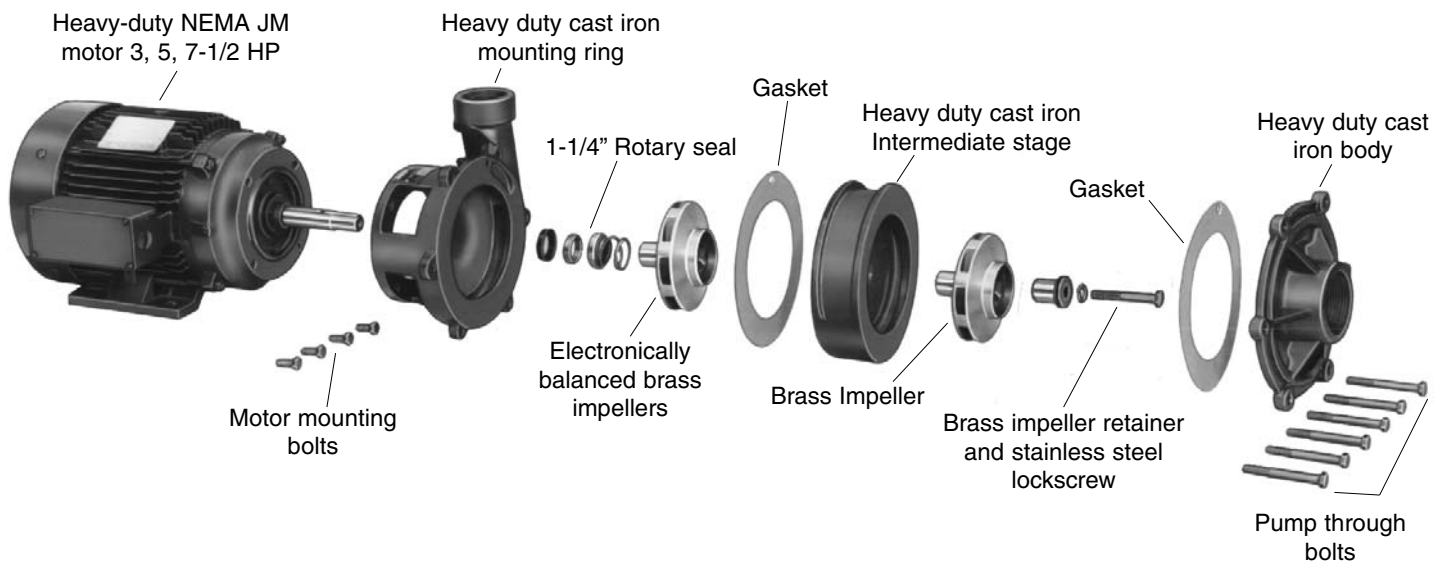



# C22000 SERIES

FEATURE FOR FEATURE THE FINEST

MODEL NUMBER		H.P.	STAGES	SUCTION LIFT FEET	CAPACITY—U.S. GALLONS PER MINUTE							SUCT. PIPE TAP	DISCH. PIPE TAP
1 PHASE	3 PHASE				DISCHARGE PRESSURES								
					20	30	40	50	60	70	80		
C22131	C22133	3	1	15	120	96						2 1/2"	2"
C22151	C22153	5	1	15	146	140	86					2 1/2"	2"
C22231	C22233	3	2	15	82	76	68	56	40			2 1/2"	2"
C22251	C22253	5	2	15	140	130	114	96	70			2 1/2"	2"
	C22273	7 1/2	2	15	140	138	136	134	116	95	56	2 1/2"	2"

MOTOR VOLTAGE: 3 HP 1 Phase 115/208-230V 60 Hz, 5 HP 1 Phase 208-230V 60Hz, 3-7-1/2 HP 3 Phase 208-230/460V 60 Hz.  
120 PSI Maximum Case Pressure

