

**Huebsch®**

# Huebsch

50 & 75 lb  
On-Premises  
Drying Tumblers



*A Classic Laundry Solution*





*Because on-premises laundries don't have time to deal with the hassles of maintenance and down time, Huebsch drying tumblers deliver reliable performance and much more. Innovative energy-saving features provide a more economical way to get the job done. With so many user-friendly features like a simple push-to-start button, Huebsch is an easy choice for your laundry facility.*

## **U**nmatched Warranty

At Huebsch, we're so confident that our quality drying tumblers are built to last, we offer a **THREE**-year warranty\* on the entire machine.

\* Parts only, labor not included. See Huebsch Warranty Bond for specifics.

**3** year limited warranty\*

## **P**erformance & Efficiency

The name Huebsch is synonymous with top performing drying tumblers. By balancing airflow and heat input, Huebsch can deliver fast drying without wasting energy. Our **fast drying** will save you hours of extra work and our **superior energy efficiency** will give your utility budget a break.

## **C**onstruction & Features

Huebsch dryers feature an **all-belt drive system** with a self adjusting tension idler. The drive system is constructed with metal pulleys and permanently sealed bearings for super quiet operation and low maintenance.



The operating controls are connected to the **modular control panel** by a single plug for reliability and convenient servicing. The wire cover eliminates the need for conduit; making the wiring easy to trace.



Our extra-large doors are constructed of top-quality **stainless steel** to stand up to use in the toughest laundry environments. The large **reversible** door opening provides for efficient loading and unloading.

Huebsch tumblers feature a **self-cleaning lint screen** made of fine mesh. Lint is deposited into a large storage area for easy removal. The self-cleaning action maintains maximum airflow and promotes fast, efficient drying.



## C.A.R.E.<sup>®</sup> System\*\* (Combustion Auto Response Equipped)



Huebsch offers an important new option in fire suppression. Our **Combustion Automated Response Equipped (C.A.R.E.)** system provides an initial response to suppress laundry combustion inside the tumbler cylinder and also can provide immediate notification to property management. **C.A.R.E.** is an independent sub-system that continually monitors the cylinder temperature as long as power is provided to the unit. If the **C.A.R.E.** system detects an excessive rise in temperature it will spray the load with water and provide a “system active” output signal. This signal may be connected to your property’s alarm system, a light or other security alarm to ensure that even though you may not be on site, **C.A.R.E.** is still monitoring your operation.

\*\* Option available on 50 & 75 lb models.

## Optional Features

Huebsch dryers feature many different options:

### Narrow width (50 lb models only)

- Bolt-on angle option for narrow width access.
- For clearance through 34 1/2" door opening.

### Reversing cylinder (3 phase only)

- Optional reversing cylinder drive helps eliminate tangling during the drying cycle.
- Perfect for drying oversized items such as sheets and table linens.

### Bright annealed stainless steel cylinder

- Attractive mirror-like smooth surface reduces fabric abrasion.

To ensure the comfort of your laundry workers, Huebsch models are built with an **automatic backdraft damper**. This helps prevent air from entering the user area.

## Additional Features

- Galvanized steel cylinder for long life
- Integrated motor overload protection
- Solid steel cap over top of the dryer
- Embossed steel cabinet for easy cleaning
- All major components easily accessible
- High temperature limit control
- Instant electronic ignition
- Superior exterior finish

## User Friendly Controls

Because different businesses have different requirements, Huebsch offers a variety of controls to meet your needs.

Our **microprocessor control** is state-of-the-art. Computerized models feature four preset automatic drying cycles with an option to further customize four additional automatic drying cycles. A fifth setting (no heat) also is available for items requiring special care.



Our **dual digital timer control** models enable operators to set drying time (0-60 minutes), cool down time (0-15 minutes) and temperature (High, Medium, Low, No Heat). New features include **one-touch cycle repeat**, **automatic extended tumble**, and **large digital time countdown display**.



## Made In The USA



Huebsch tumblers are manufactured in Ripon, WI, and are sold and serviced by top quality distributors worldwide.

# 50 & 75 lb On-Premises Drying Tumbler Specifications

	50 lb Tumbler	75 lb Tumbler
Width - in (mm)	38 5/8" (981)	38 5/8" (981)
Depth - in (mm)	47" (1194)	53" (1346)
Height - in (mm)	<b>Gas and Elec:</b> 76 5/8" (1946) <b>Steam:</b> 80" (2032)	<b>Gas and Elec:</b> 76 5/8" (1946) <b>Steam:</b> 80" (2032)
Cylinder Depth - in (mm)	30" (762)	36" (914)
Cylinder Diameter - in (mm)	37" (939)	37" (939)
Cylinder Volume - cu. ft. (liters)	18.7 (528)	22.4 (634)
Door Opening - in (mm)	26 7/8" (683)	26 7/8" (683)
Dry Weight Capacity - lb (kg)	50 (23)	75 (34)
Airflow - cfm (liters/sec.)	750 (354)	<b>60 Hz Gas and Steam:</b> 920 (434) <b>All Electric and 50 Hz Gas &amp; Steam:</b> 750 (354)
Water Inlet Size (C.A.R.E.® System)	(1) 3/4-11 1/2 NH Hose Connection	(1) 3/4-11 1/2 NH Hose Connection
Energy Data	<b>Gas Models:</b> 120,000 Btu/hr (30,240 kcal/hr) <b>Steam Models:</b> At 100 psi (6.9 bar): 5.1 BHP, 178,000 Btu/hr (52.0 kW) At 15 psi (1.0 bar): 3.4 BHP, 119,000 Btu/hr (34.8 kW)	<b>Gas Models:</b> 165,000 Btu/hr (41,580 kcal/hr) <b>Steam Models:</b> At 100 psi (6.9 bar): 6.1 BHP, 210,000 Btu/hr (61.6 kW) At 15 psi (1.0 bar): 4.1 BHP, 141,000 Btu/hr (41.2 kW)
Electrical Specifications	<b>Gas and Steam Models:</b> <b>VOLT/FREQ/PH Amps</b> Non-Rev Rev 120/60/1 9.3 - 200-208/240/60/1 5.1 - 200-208/240/60/3 2.8 4 380/60/3 1.6 2 440/60/3 (Steam) 1.4 1.9 460-480/60/3 1.4 1.9 200/50/3 3.3 4.2 230-240/50/1 6.3 6.9 230-240/50/3 3.1 4.3 380/400-415/50/3 1.6 2 <b>Electric Models:</b> <b>30 kW</b> 200-208/60/3 89 88 240/60/3 79 78 380/60/3 47 48 440/60/3 41 41 480/60/3 38 38 200/50/3 84 85 230/50/3 73 75 240/50/3 79 78 380/50/3 47 48 400-415/50/3 43 44 <b>Electric Model:</b> <b>21 kW</b> 240/50/1 93 95	<b>Gas and Steam Models:</b> <b>VOLT/FREQ/PH Amps</b> Non-Rev Rev 120/60/1 13.8 - 200-208/240/60/1 7.6 - 200-208/240/60/3 3.8 4.3 380/60/3 1.8 2.1 440/60/3 (Steam) 1.9 2.1 460-480/60/3 1.9 2.1 200/50/3 3.5 4.5 230-240/50/1 6.7 7 230-240/50/3 3.5 4.9 380/400-415/50/3 1.8 2.1 <b>Electric Models:</b> <b>30 kW</b> 200-208/60/3 89 88 240/60/3 79 78 380/60/3 47 48 440/60/3 41 41 480/60/3 38 38 200/50/3 84 85 230/50/3 73 75 240/50/3 79 78 380/50/3 47 48 400-415/50/3 43 44
Plumbing Connections	Gas: 1/2" - NPT Steam: 3/4" - NPT	Gas: 1/2" - NPT Steam: 3/4" - NPT
Net Weight - lb (kg)	545 (247)	615 (279)
Shipping Weight - lb (kg)	602 (273)	677 (307)
Shipping Dimensions - in (mm)	W 41 1/2" (1054)	41 1/2" (1054)
	D 52 1/8" (1323)	56 3/8" (1433)
	H 84 5/8" (2149) (steam)	84 5/8" (2149) (steam)
	H 81" (2057) (gas/electric)	81" (2057) (gas/electric)
Agency Approvals	<b>Gas Models:</b> CSA Star, CSA Flame, cCSA <sub>US</sub> , CE <b>Electric and Steam Models:</b> cCSA <sub>US</sub> , CE	<b>Gas Models:</b> CSA Star, CSA Flame, cCSA <sub>US</sub> , CE <b>Electric and Steam Models:</b> cCSA <sub>US</sub> , CE

## Roughing in Dimensions

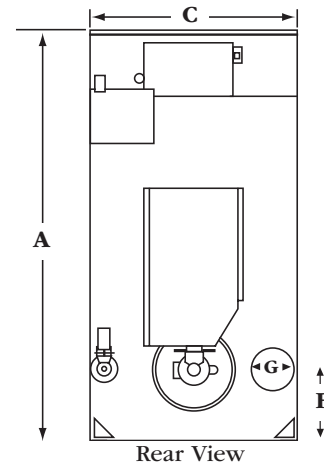
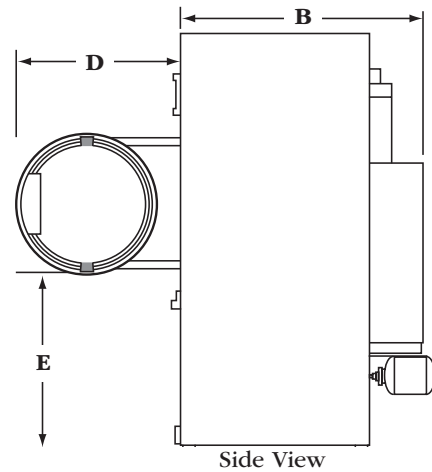

Dimensions	50 lb	75 lb
A. Height (gas and electric) - in (mm)	76 5/8" (1946)	76 5/8" (1946)
A. Height (steam) - in (mm)	80" (2032)	80" (2032)
B. Depth - in (mm)	47" (1194)	53" (1346)
C. Width - in (mm)	38 5/8" (981)	38 5/8" (981)
D. Door Opening - in (mm)	26 7/8" (683)	26 7/8" (683)
E. Door Clearance - in (mm)	28 5/8" (726)	28 5/8" (726)
F. Exhaust Height - in (mm)	13 3/8" (340)	13 3/8" (340)
G. Exhaust Vent - in (mm)	8" (203)	8" (203)

Tumbler models are made to suit a variety of electrical service characteristics. See your Huebsch distributor for specifications. For further details on installation, refer to Installation, Operation and Maintenance instructions supplied with the tumbler. USA and Canada models are certified by C.S.A. International.

For the most accurate information, the installation guide should be used for all design and construction purposes. Due to continuous product improvements, design and specifications subject to change without notice. The quality management systems at all Alliance Laundry Systems manufacturing facilities are registered as ISO 9001:2000 compliant.

© Copyright 2007 Alliance Laundry Systems LLC

AH07-210

Alliance Laundry Systems Shepard Street, Ripon, WI 54971 Telephone: 1-800-553-5120

Printed in the U.S.A.



Printed on paper manufactured with virgin pulp from certified sources and a minimum of 10% post-consumer recovered fiber.

# www.huebsch.com