

# Paper Machine Gauge



- Hinged Ring Case for Easy Recalibration
- Designed to Fit Existing Paper Machine Panels
- Moisture Proof Weep Hole Prevents Condensation Buildup

## Description

Winters Paper Machine Gauge features a heavy duty steel case with a front flange and a hinged ring design with weep hole. This configuration allows for easy access to the recalibrator, and prevents condensation buildup.

This instrument is available in 3.5" (90mm) dial size, with a 1/4" NPT lower back mount connection. Standard pressure ranges up to 1,000 psi are available.

Winters Paper Machine Gauge is specifically designed to fit existing paper machine panels.

## Specifications

<b>Dial:</b>	3.5" (90mm) aluminum dial with black markings
<b>Case:</b>	Chrome-plated steel, hinged ring case, front flange, 3 mounting holes, moisture proof weep hole
<b>Lens:</b>	Glass lens
<b>Ring:</b>	Chrome plated brass ring with weather-tight seal
<b>Pointer:</b>	Non-adjustable
<b>Socket:</b>	Brass
<b>Bourdon Tube:</b>	Phosphor Bronze
<b>Movement:</b>	Stainless steel
<b>Connection:</b>	1/4" NPT lower back mount
<b>Ranges:</b>	Standard ranges up to 1,000 psi
<b>Over Pressure Limit:</b>	25% of full scale value
<b>Working Pressure:</b>	Maximum 75% of full range
<b>Ambient/Process Temperature:</b>	-40°F - 158°F (-40°C - 70°C)
<b>Recalibrator:</b>	Standard
<b>Restrictor Screw:</b>	Standard
<b>Accuracy:</b>	* /-2%-1%-2% ASME Grade A



Corporate Office: 121 Railside Road • Toronto • ON • M3A 1B2 • (416) 444-2345 • Fax: (416) 444-8979

U.S.A. Office: 600 Ensminger Road • Buffalo • NY • 14150 • (716) 874-8700 • Fax: (716) 874-8800

[www.winters.com](http://www.winters.com) • 1-800-WINTERS (946-8377)

# Paper Machine Gauge

How to order: Specify Product Code  
**PRODUCT CODES**

Pressure Range	3 1/2" (90mm) dial size 1/4" NPT Lower Back
0 - 30 psi	PMG30
0 - 60 psi	PMG60
0 - 100 psi	PMG100
0 - 160 psi	PMG160
0 - 200 psi	PMG200
0 - 300 psi	PMG300
0 - 400 psi	PMG400
0 - 600 psi	PMG600
0 - 1000 psi	PMG1000

Options:

- Custom dials available upon request
- Other configurations available

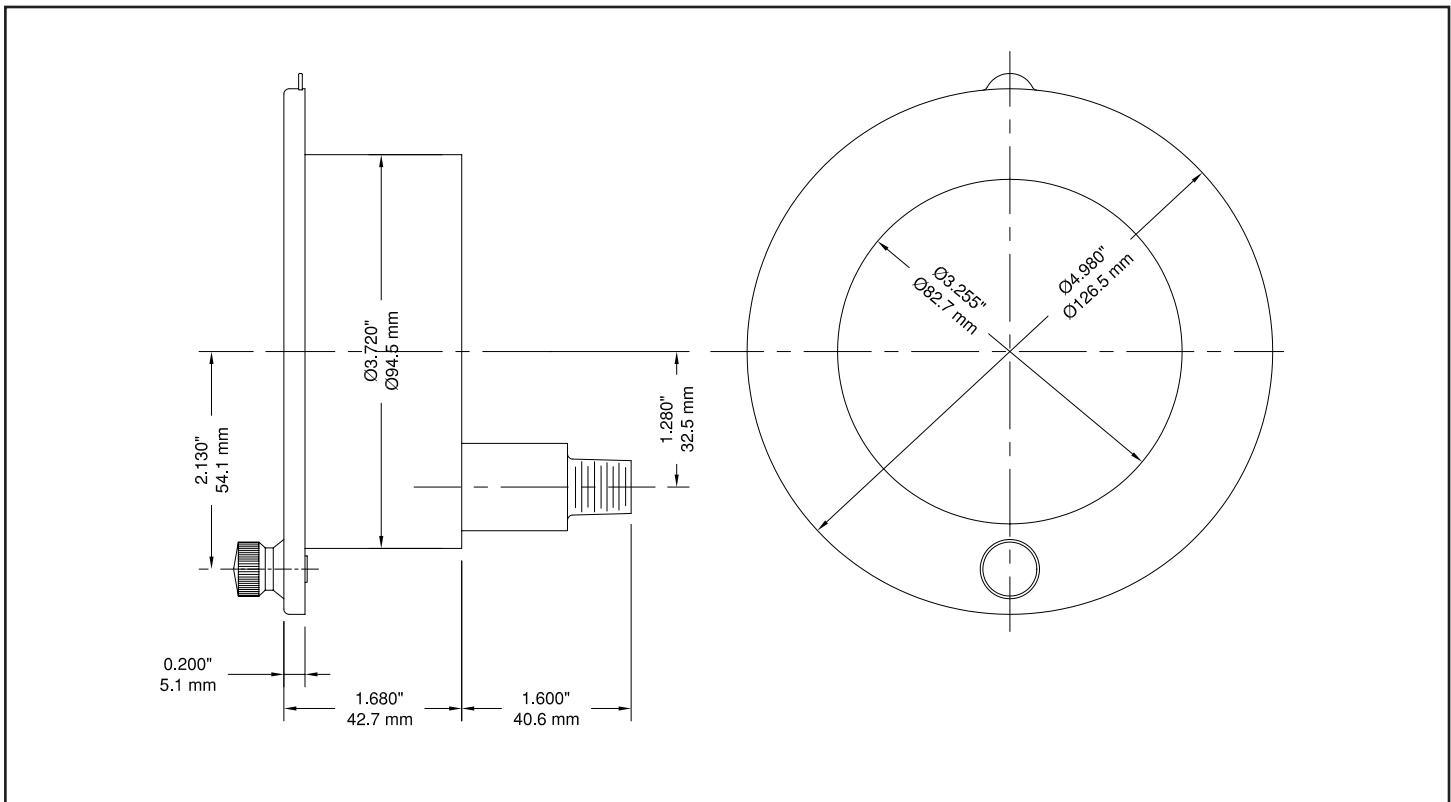

Corporate Office: 121 Railside Road • Toronto • ON • M3A 1B2 • (416) 444-2345 • Fax: (416) 444-8979

U.S.A. Office: 600 Ensminger Road • Buffalo • NY • 14150 • (716) 874-8700 • Fax: (716) 874-8800

[www.winters.com](http://www.winters.com) • 1-800-WINTERS (946-8377)

06/03