



# SourceFlex™ System

## Model SAS-SM8A Sonic Mushroom™

### Tabletop Listening Station

## Installation/Operation



EN55103-1 E1-E5; EN55103-2 E1-E4  
 Typical Performance reflects product at publication time exclusive of EMC data, if any, supplied with product. Specifications are subject to change without notice.

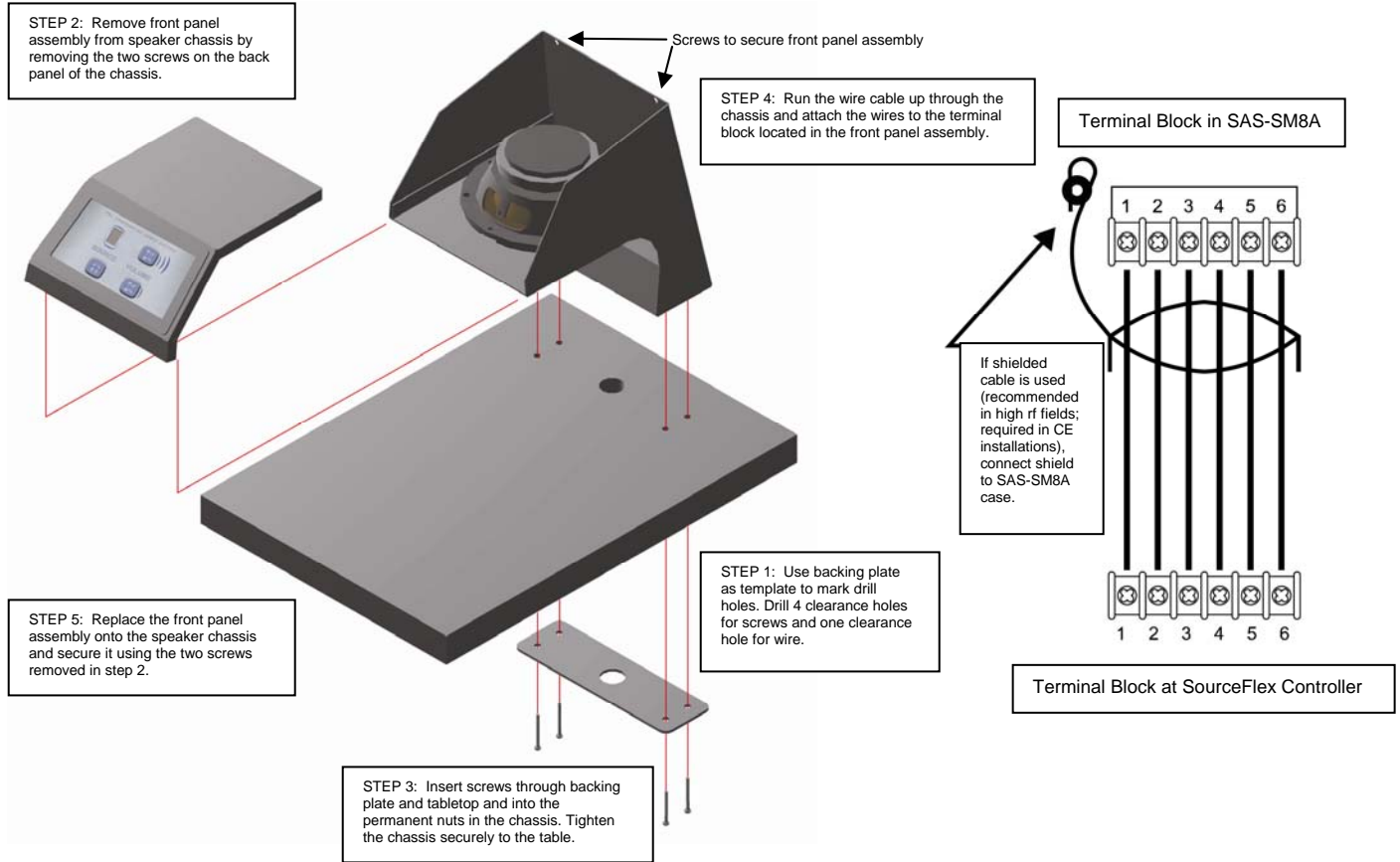

### TYPICAL PERFORMANCE

Input terminals driven from SourceFlex controller:

Frequency Response:

SPL:

Controls (3):

Volume Adjustment Range:

Ramp Rate:

Display:

Control buttons:

Construction:

Mounting:

Color:

Power Requirement:

Interconnection Cable:

Wire Gauge / Distance:

Dimensions:

Balanced audio, display data, switching logic, power

Maximum intelligibility on table top installation

85 dBA @ 1 meter

Momentary pushbuttons: channel select, volume ramp UP, volume ramp DOWN

40 dB

5 seconds nominal for 40 dB

7-segment red LED ("0" = OFF or paging, "1" through "8" = selected channel)

Recessed beneath moisture-sealed user-replaceable polycarbonate

Industrial quality tamper-resistant steel

4-point mounting in tabletops up to 1.2" (3.0cm)

RDL Granite (neutral appearance, masks fingerprints)

24 to 33 Vdc @ 225 mA, Ground-referenced (power provided from SourceFlex controller)

6 conductors from controller (twisted pair cable may be used)

22 AWG / 0.35 mm<sup>2</sup>: Up to 200 ft. (61 m)

20 AWG / 0.5 mm<sup>2</sup>: Up to 325 ft. (100 m)

20 AWG / 0.5 mm<sup>2</sup>: Up to 500 ft. (150 m)

Height: 6.75 in 17.2 cm

Width: 6.25 in 15.9 cm

Depth: 7.75 in 19.7 cm

### Radio Design Labs Technical Support Centers

U.S.A. (800) 933-1780, (928) 778-3554; Fax: (928) 778-3506

Europe [NH Amsterdam] (+31) 20-6238 983; Fax: (+31) 20-6225-287