

# SHURE®

 PERSONAL MONITORS

## PSM® 400 Personal Monitors



Versatile systems for working musicians.



### Sound Quality

Hear yourself perfectly.

### Mobility

Your mix moves with you onstage.

### Control

Create your own monitor mix.

### Portability

Easy to load in and out.

## Hear clear for a change

### Quality sound.

Shure E3 Low Mass/High Energy™ Earphones help you hear yourself perfectly and perform better. Enjoy high-fidelity stereo sound, great isolation from outside noise and exceptional signal-to-noise ratio.

# The PSM® 400

## Expand your range onstage

### Go anywhere.

With Shure PSM®, the sweet spot moves with you. You hear yourself perfectly wherever you go, not just that spot where the monitor mix sounds best. Visit the drummer or the audience. Nothing will interfere with your mix.

### Plug in.

The sleek Wireless Bodypack Receiver (or Hardwired Personal Monitor) clips easily to a belt, guitar strap or pocket. So lightweight, you'll forget it's there.





**E3 Earphones**  
Low Mass/High Energy™ Earphones. Standard for all PSM® 400 systems.



**E5 Earphones**  
Dual-driver, Low Mass/High Energy™ Earphones. The ultimate step-up for In Ear performance.

### Lower onstage volume.

When a band goes In Ear, there's no more fighting over onstage monitor volume. Unlike floor wedges, PSM® Personal Monitors send the mix directly to your ears. Get the volume you need without blasting sound all over the stage.

### Consistent volume levels.

This personalized mix is for your ears only. So you don't have to crank the volume to dangerous levels to hear your voice or your instrument. A switchable limiter setting reduces the potential for ear strain.

The right way to listen. Precision Shure earphones are designed specifically for use with PSM® systems. Headphones and earbuds pale in comparison to professional earphones developed for the In Ear experience. Don't go In Ear without them.

## Create your own personal mix

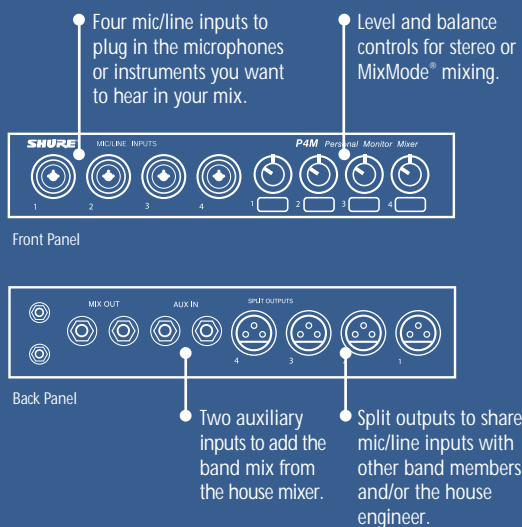

### P4M Personal Monitor Mixer



No more nightmare gigs. Remember the night everything went wrong with the sound? A rookie engineer gave an awful mix. The house sound gear couldn't compensate for bad room acoustics. You spent the whole night wondering what you sounded like. It doesn't have to be that way.

### Set it yourself.

Get the same mix at every show without annoying setup hassles. Combine up to six inputs from the stage, the house mixer or both. Even make quick adjustments to your mix levels onstage, without getting the engineer's attention.

### Wireless Bodypack Receiver

- LCD display shows mode, limiter and EQ selections, and tracks battery life.
- Volume control.
- Balance knob adjusts left/right balance in stereo or MixMode®.

### Control it yourself.

One knob on the bodypack conveniently raises or lowers your overall mix volume. Another knob adjusts left/right balance in stereo or sets the relative levels in Shure's proprietary MixMode®.



MixMode® control. Adjust the level of two signals – a vocal and band mix for example – at the same time. You hear both signals in both earphones, and set the relative levels of each with the balance control on the bodypack.

### Wired Personal Monitor



Wired solutions too. Hardwired systems give stationary performers as much mobility as they need, plus the convenience of body-mounted controls, personal onstage mixers and a wedge-free stage.

### Wireless Transmitter

16 UHF frequencies (8 compatible)



## Shure Personal Monitor Systems

### PSM® 200

Affordable, full-featured entry to personal monitoring.

### PSM® 400

Versatile systems for working musicians.

### PSM® 600

Professional wired | wireless systems.

### PSM® 700

Advanced wireless touring gear.

# Lose the wedges

The days of floor wedges are numbered. Professional musicians and performers worldwide are going In Ear with the clear alternative for monitoring their sound: Shure Personal Monitor Systems (PSM®).

With the PSM® 400, Shure brings affordable personal monitoring control to more performers than ever before. Hear what you want, how you want, wherever you want. It's no contest.

## The PSM Advantage

	Sound Quality	Stage Mobility	Personal Control	Lightweight	Clutter-free
PSM®	You hear a clearer mix at lower volume levels.	Your mix sounds great and goes where you go.	Create your own mix and adjust it onstage, on the fly.	Never lug another wedge. One case holds the PSM® system for a whole band.	You work a wedge-free stage. Audiences see more you and less gear.
Wedges	Loud. Very loud. Vocal strain.	One sweet spot. You're grounded!	Muddy mix. Nasty feedback.	Heavy to load in. Heavy to load out.	Ugly stage clutter. Obscures your're performance.



# Getting started.

## Choose from three complete systems.

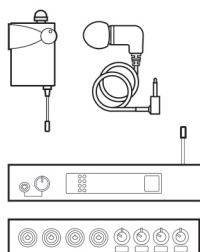

P4MTR E3

### PSM® 400 **Wireless** Personal Monitor System With Onstage Mix Control

- 1 Wireless Transmitter
- 1 Wireless Bodypack Receiver
- 1 P4M Personal Monitor Mixer
- 1 E3 Earphones

**IDEAL FOR**

Individual vocalists or musicians who want the freedom of complete wireless mobility and the convenience of onstage monitor mixing.

Includes everything you need for your own personal wireless monitor system in one box.

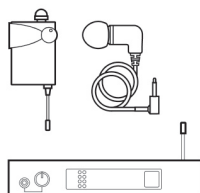

P4TRE3

### PSM® 400 **Wireless** Personal Monitor System

- 1 Wireless Transmitter
- 1 Wireless Bodypack Receiver
- 1 E3 Earphones

**IDEAL FOR**

Individual vocalists or musicians who want the freedom of complete wireless mobility.

Includes everything you need for your own personal wireless monitor system in one box.

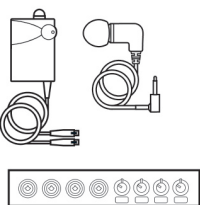

P4MHW E3

### PSM® 400 **Wired** Personal Monitor System With Onstage Mix Control

- 1 Wired Personal Monitor
- 1 P4M Personal Monitor Mixer
- 1 E3 Earphones

**IDEAL FOR**

Individual vocalists or musicians who remain in one location onstage but want the clarity of In Ear sound and the convenience of onstage monitor mixing.

Includes everything need for your own personal wired monitor system in one box.

## Or build your own system.

PSM® 400 Components *sold separately*

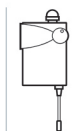

**P4R**  
Wireless Bodypack Receiver



**P4T**  
Wireless Transmitter

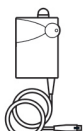

**P4HW**  
Wired Personal Monitor



**P4M**  
Personal Monitor Mixer



**E3**  
Single-Driver Earphones



**E5**  
Dual-Driver Earphones

## System Example

### Band Starter System

The least expensive wireless starter system for a 4-piece band sharing one stereo or two mono monitor mixes.

### Start with Everyone In Ear

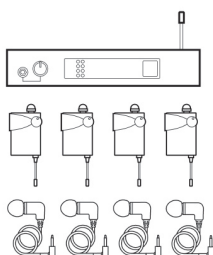

### Add

A Personal Monitor Mixer for an individual or the band



### Then

Additional transmitters (for stereo mixes) and mixers (to create/control the mix) for each band member

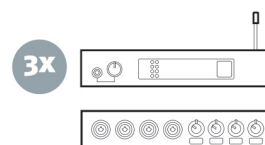

## Hear and believe. Go In Ear.

Nothing beats a real test drive. Ask for a PSM® demonstration at your local music store.

# Specifications

## Wireless Personal Monitor System

RF Carrier Frequency Range	722 to 865 MHz (country dependent)
Frequency Selection	16 per system, up to 8 compatible (country dependent)
Operating Range	300 ft. (environment dependent)
Signal-to-Noise Ratio	80 dB typical (A-weighted)

Audio Frequency Response	50 to 15 kHz (+0, -3 dB re 1 kHz); earphone dependent
Channel Separation	35 dB typical
Earphone Connectors	3.5mm stereo (left=tip, right=ring, ground=sleeve)

## Wireless Transmitter P4T | EP4T

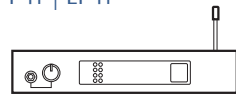

RF Output Power	50 mW (+17 dBm) typical conducted (country dependent)
Power Requirements	Table-Top AC Adapters P4T: PS40 (Input: 120 Vac, 60Hz, 14w; Output: 15 Vdc, 600 mA, 9w) EP4T: PS40E (Input 230 Vac, 50 Hz/60Hz; Output: 15 Vdc, 600 mA, 9w)
Input Connectors	1/4" TRS electronically balanced

Modulation Limiter	Internal peak limiter (>10:1 compression)
Input Impedance	>10 kΩ
Maximum Input Level	P4T: +10 dBV EP4T: +12 dBV
Loop-out Connectors	1/4" TRS electronically balanced

## Wireless Bodypack Receiver P4R

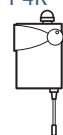

Power Requirements	9V Alkaline battery
Battery Life	Up to 8 hours, volume dependent
Net Weight	125 g (.28 lb.)
Overall Dimensions	82.6mm X 63.5mm X 26.2mm (HWD) (3 1/4 X 2 1/2 X 1 1/32 in.)

Output Level	+4 dBV
--------------	--------

## Wired Personal Monitor P4HW

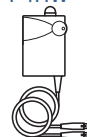

Frequency Response	20 to 20,000 kHz
Signal-to-Noise Ratio	85 dB
Power Requirements	9V Alkaline battery
Battery Life	Up to 8 hours, volume dependent

Channel Separation	35 dB	Audio Output Connector	3.5mm stereo (left=tip, right=ring, ground=sleeve)
Maximum Output Level	+3 dBV	Phantom Power Protection	Up to 60 VDC
Maximum Input Level	+5 dBV, input pad OFF +18 dBV, input pad ON		
Input Impedance	>40 kΩ		

## Personal Monitor Mixer P4M | P4ME

Measurement Conditions (unless otherwise specified): full gain: 1 kHz, one channel activated; source impedances: Mic 150 Ω, Aux level 150 Ω; terminations: Line 600 Ω



Frequency Response (Ref 1 kHz, controls centered)	20 Hz to 20 kHz ±2 dB
Impedance (at 1 kHz)	Mic/Line Inputs: 5800 Ω Aux. Ins: 18 kΩ (each) 9100 Ω (1/L mono)
Operating Voltage	14-18 VDC nominal at 120 mA max current <i>Note: Courtesy DC connector is protected from short by a self-resetting "Polyfuse." Maximum recommended load is 250 mA (two P4Ms or one P4T)</i>
Phantom Power	The P4M does not produce phantom power, but phantom power is allowed to pass through split outputs 1-4 to inputs 1-4 respectively.
Net Weight	1.20 Kg (2 lb., 10 oz.)
Overall Dimensions	44 mm x 218 mm x 162 mm (HWD) (1.72 x 8.60 x 6.37 in)

Gain (Maximum 10 kΩ load)	Mic/Line Inputs: 43 dB Aux Ins: 0 dB	Distortion (THD at 1 kHz)	Split Outs: .0005% Mix Outs: >.05% (0 dBV output)
Input Clipping Level	Mic/Line Inputs: +12 dBV Aux Ins: +12 dBV	Noise (100 Hz to 22 kHz)	Split Outs: -110 dBV Mix Outs: -100 dBV (all controls CCW) -62 dBV (all controls CW)
Crosstalk	Mic/Line Inputs: -100 dB Aux Ins: -90 dB	LEDs: Resultant Mix Out Level (10 kΩ load)	Green: -30 dBV Yellow: -10 dBV Red: 0 dBV
Common Mode Rejection	Mic/Line Inputs: >75 dB Aux Ins: >70 dB	Polarity	All outputs in polarity with all inputs. XLR pin 2 is "hot" with respect to pin 3; pin 1 is ground. 1/4" TRS tip is "hot" with respect to ring; sleeve is ground.
Impedance	Mix Outs: 500 Ω	Temperature Range	Operating: -7° to 49° C (20° to 120° F) Storage: -29° to 74° C (-20° to 165° F)
Output Clipping Level	Mix Outs: +5 dBV (10 kΩ balanced load, -30 dBV input ch. 1-4.)		
Crosstalk	Split Outs: -100 dB Mix Outs: -70 dB		

## Earphones with Low Mass/High Energy™ Drivers

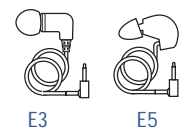

<b>E3 Single-Driver</b>	
Sensitivity	115 dB SPL/mW
Impedance	26 Ω
<b>E5 Dual-Driver</b>	
Sensitivity	122 dB SPL/mW
Impedance	110 Ω

Optional Accessories	PA750 Foam Sleeves PA755 Triple Flange Sleeves PA756S Small Flex Sleeves PA756M Medium Flex Sleeves PA756L Large Flex Sleeves	PA758S Small Soft Flex Sleeves PA758M Medium Soft Flex Sleeves PA758L Large Soft Flex Sleeves
----------------------	---	---



www.shure.com

**United States:**  
Shure Incorporated  
5800 West Touhy Avenue  
Niles, IL 60714-4608 USA  
Phone: 847-600-2000  
Fax: 847-600-1212  
E-mail: info@shure.com

**Europe, Middle East, Africa:**  
Shure Europe GmbH  
Wannenäckerstr. 28,  
74078 Heilbronn, Germany  
Phone: 49-7131-72140  
Fax: 49-7131-721414  
E-mail: info@shure.de

**Asia, Pacific:**  
Shure Asia Limited  
Unit 301, 3rd Floor  
Citicorp Centre  
18, Whitfield Road  
Causeway Bay, Hong Kong  
Phone: 852-2893-4290  
Fax: 852-2893-4055  
E-mail: info@shure.com.hk

**Canada, Latin America, Caribbean:**  
Shure Incorporated  
5800 West Touhy Avenue  
Niles, IL 60714-4608 USA  
Phone: 847-600-2000  
Fax: 847-600-6446  
E-mail: international@shure.com