

# ELECTRUCK®

## Zero-emissions Electric Vehicle

| MODELS                  | ET-150-72 | ET-150-48 |
|-------------------------|-----------|-----------|
| TYPE                    | Electric  | Electric  |
| SPEED (MAX MPH)         | 25        | 18        |
| RANGE (MILES)           | 40        | 20        |
| LOAD CAPACITY (lbs)     | 1,500     | 1,500     |
| PASSENGER CAPACITY      | 2         | 2         |
| BED SIZE (W"xL")        | 62x85     | 62x85     |
| VOLTAGE                 | 72        | 48        |
| TURNING RADIUS (INCHES) | 210"      | 210"      |



## Tough and Dependable Product Solutions

The Electruck® product line is designed to provide an electric alternative to your current fleet of full sized utility pickup trucks. Powered by an electric drive train, Electruck can reach speeds of up to 25 mph, while providing over 40 miles in range. Full size deck provides over 147 cu. ft. of cargo space to carry loads up to 1,500 pounds.

Electruck equipped with DC motor and lead acid batteries provide one of the most cost effective and reliable designs in its class of vehicles. Specifically designed for off-road applications, the vehicle can reduce your operating and maintenance costs by over 40%.

The Electruck product line is available in 48 volt or 72 volt configurations. Electrucks with 48 volt drive trains can travel at the speed of 18 mph and provide a range of over 50 miles when equipped with a dual pack of batteries. Electruck models equipped with 72 volt drive trains can travel at speeds up to 25 mph while providing over 40 miles in range on a single charge.

Electruck, like all other Taylor-Dunn products, can be customized with cargo boxes, tool cabinets, ladder racks, etc. to meet your specific application needs. Call on your local Taylor-Dunn dealer to customize your Electruck with factory installed options to ensure the most cost effective solution.

With over 130,000 vehicles in service and over 50 years of experience in the industry, Taylor-Dunn products are the best way to go about your business.



**TAYLOR-DUNN®**  
Commercial and Industrial Vehicles Since 1949

*The best way to go about your business*

**PERSONNEL CARRIERS**



**Aristocrat**



**Roadmaster**

**BURDEN CARRIERS**



**Taylortruck**



**Loadmaster**



**Model B Series**



**Electruck**



**Maintenance Expediter**



**Stepsaver**



**Stockchaser**

**TOW TRACTORS**



**Towmaster**



**Mule**



**Pullmaster**



**Model E**



**Huskey**

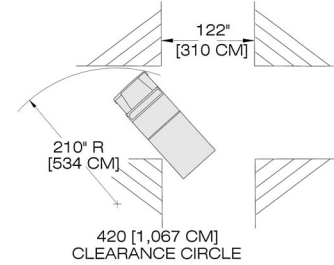
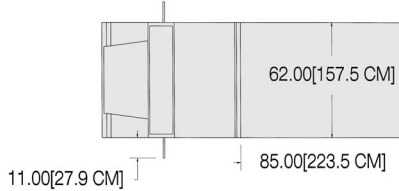
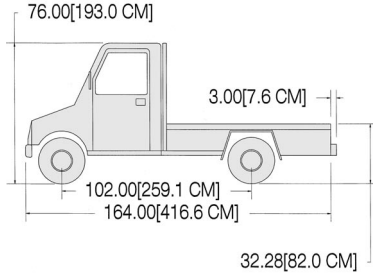

**ELECTRUCK® STANDARD SPECIFICATIONS**

**Product Line:** ET-150-72  
**Wheels:** 4 wheels  
**Unit Weight:** 2,700 lbs (1,227 kg)  
**Load Capacity:** 1,500 lb.  
**Battery Type (Lead Acid):** 244 amp hours, 6 volts  
**System Voltage:** 72 volt  
**Travel Distance (Unloaded):** 40 miles  
**Energy Consumption:** 264 watt/hr. per mile  
**Drive Axle:** Automotive type differential and housing  
**Transmission:** Power traction in oil bath; 14:1 reduction  
**Motor:** NEMA rated 72V, 22 hp @ 2820 rpm intermittent duty; 11.5 hp @ 4000 rpm normal duty  
**Speed (Unloaded):** 25 mph  
**Gradeability:** 10% empty, 5% fully loaded  
**Tires Pneumatic:** P195/75R14 pneumatic  
**Brakes:** 11" hydraulic front (disc) & rear (drum)  
**Steering:** Automotive steering 24:1  
**Frame:** All steel tubular chassis  
**Cabin:** Fiberglass cab with rear & side view mirrors and aluminum doors, windshield wiper

**Bumper:** Heavy duty steel front & rear bumper  
**Suspension:** Leaf springs front and rear, with shock absorbers  
**Color:** White cabin  
**Seats:** Individual seats, driver & passenger with seatbelts  
**Controller:** Solid state speed controller 400 amp 72 volts  
**Wiring:** Modular harness design with weather protected connectors  
**Instrumentation:** Battery discharge indicator, forward/reverse selector, key switch, speedometer, odometer, power cutoff switch  
**Light Accessories:** Headlight, taillight, reverse light, turn signals, hazard light  
**Charger:** 25 amp, 72 volt built in automatic charger  
**Charge Time:** 10 hours for charge on batteries 80% discharged  
**Input Voltage:** 110 volt/220 volt, 50 Hz./60Hz.  
**Charging Energy Requirements:** 17.6 kw hr. @ 80% efficiency  
**Conformance Standards:** Type E OSHA requirements 1910.178, ANSI B56.8 requirements  
**MODEL ET 1-50, 48 volts**  
 2,500 lbs. unit weight; 6 volt 220 ah batteries, built-in electronic 48V 25 amp 110V AC 60 Hz charger; 15 hp DC series wound motor; 18 mph speed (empty); 20 mile range; hydraulic front & rear brakes, fiberglass cabin (less doors), dual tail light, stop light, headlight.

**ELECTRUCK® OPTIONAL FEATURES**

**Charger**  
 • Portable 25 amp charger or 40 amp charger  
 • Built in 110v/220v 50 Hz

**Deck**  
 • Stake sides, removable end gate, 14" high  
 • Steel panel cargo box with windows  
 • Steel panel cargo box with rollup side/rear curtains  
 • Steel sides and end gates, fold down  
 • Utility option - ladder rack, tool cabinet, tool box

**Cabin**  
 • Special paint colors  
 • Decals

**Hitches**  
 • Hitch automatic coupling, trailer  
 • Hitch pintle trailer  
 • Hitch 1-7/8" ball and bracket

**Accessories**  
 • Strobe light on top of cabin  
 • Reverse alarm  
 • Heater/defroster (battery operated - 24 volt)  
 • Battery watering system  
 • Hour meter



**TAYLOR-DUNN CORPORATION**  
 Commercial and Industrial Vehicles Since 1949



2114 West Ball Road, Anaheim, CA 92804 • (714) 956-4040 • FAX (714) 956-3130  
 Toll Free (800) 688-8680 Visit our website: [www.taylor-dunn.com](http://www.taylor-dunn.com)