



# Boiler Controls

McDonnell & Miller

## Low Water Cut-Offs – Mechanical For Steam and Hot Water Boilers

### Series 64 Low Water Cut-Offs



- For residential, commercial, and industrial boiler applications of any steaming capacity
- Heavy Duty
- Adjustable BX outlet for easy installation
- Dual precision switches for dependable operation of the low water cut-off and alarm or electric water feeder
- Packless bellows
- Optional manual reset available
- 1" (25mm) NPT equalizing pipes required
- Maximum boiler pressure 50 psi (3.5 kg/cm<sup>2</sup>)
- Use with TC-4 on hot water systems



SERIES 64

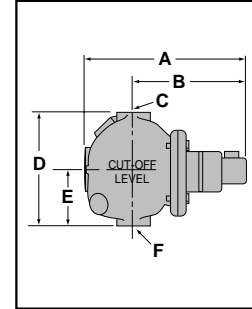

### Dimensions, in. (mm)

A	B	C NPT	D	E	F NPT
9 <sup>15</sup> / <sub>16</sub> (252)	7 <sup>7</sup> / <sub>16</sub> (65)	1	6 <sup>1</sup> / <sub>2</sub> (165)	3 <sup>1</sup> / <sub>8</sub> (79)	1

Boiler Controls

### Model 64-A Low Water Cut-Offs



- Quick hook-up fittings provided for installation directly into gauge glass tapings



Model 64-A

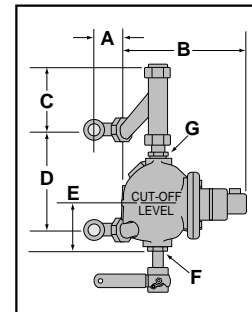

### Dimensions, in. (mm)

A	B	C	D		E	F NPT	G NPT
			min.	max.			
2 <sup>5</sup> / <sub>8</sub> (66)	9 <sup>15</sup> / <sub>16</sub> (252)	4 <sup>1</sup> / <sub>2</sub> (113)	6 <sup>7</sup> / <sub>8</sub> (172)	13 <sup>3</sup> / <sub>8</sub> (339)	3 <sup>1</sup> / <sub>8</sub> (79)	1	1

### Ordering Information

Model Number	Part Number	Description	Weight lbs. (kg)
64	143600	Low water cut-off	11.3 (5.1)
64-A	143700	64 w/quick hook-up fittings	18.3 (8.3)
64-B	143800	64 w/float block	11.5 (5.2)
64-M	144250	64 w/manual reset	12.5 (5.7)

### Electrical Ratings

Voltage	Motor Switch Rating (Amperes)		Pilot Duty 125 VA at 120 or 240 VAC
	Full Load	Locked Rotor	
120 VAC	7.4	44.4	
240 VAC	3.7	22.2	