

## V5197 Integrated Valve Train Butterfly Gas Valve



The V5197A is a firing rate valve used to provide variable flow control of air, natural gas, liquefied petroleum (LP), and manufactured gases. The V5197A is actuated by a firing rate motor that can be mounted directly on the valve. The V5197A is not applicable as a safety shutoff valve. The V5197A is specially designed to provide fine control of gas flow in applications where a high turn down ratio is required. The maximum flow adjustment screw on the bottom of the

valve allows adjusting the maximum flow of gas through the V5197 while maintaining the linear modulating characteristics and stroke. The V5197A is part of the Honeywell Integrated Valve Train System that allows gas train components to be directly bolted together.

- Used with air, natural, manufactured or liquefied petroleum (LP) gases.
- For modulating applications that do not require final shutoff service of firing rate valve.
- Two valve body types (small and large) applicable to seven pipe sizes:
- Small body type for 3/4 in. (19 mm), 1 in. (25 mm), 1-1/4 in. (32 mm), 1-1/2 in. (38 mm) and 2 in. (51 mm) pipes, NPT or ISO 7 threads.
- Large body type for 2 in. (51 mm), 2-1/2 in. (64 mm) and 3 in. (76 mm) pipes, NPT or ISO 7 threads.
- Two downstream 1/4 in. NPT threaded pressure taps available.
- Accepts C6097 Pressure Switch mounted directly to flange (downstream pressure tap only).
- Unpainted cast aluminum body.
- Suitable for electric or pneumatic operators with the appropriate linkage.
- May be used with manufacturers own linkage and drive motor.
- Flow adjustment screw on bottom of valve controls maximum flow.
- Visual position indicator.

### Dimension Diagrams

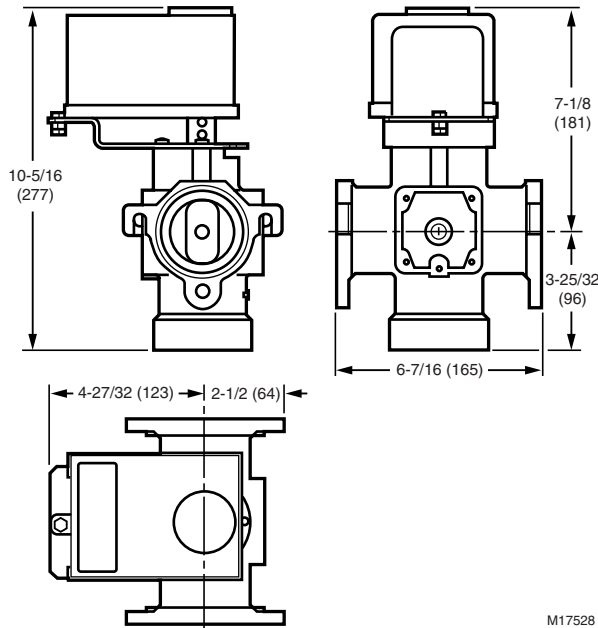

**Body Material:** Die-cast aluminum

**Temperature Ratings:** -40 F to 150 F (-40 C to 66 C)

**Inlet and Outlet Pressure Tapping:** Two downstream 1/4 in. NPT taps

**Approvals:**

**Canadian Standards Association:** Design Certified

**Industrial Risk Insurers:** Acceptable

Product Number	Type of Gas	Pipe Size		Capacity		Integrated Valve Train Body Size	Mounting	Pressure Ratings	
		(inch)	(mm)	cfh	m <sup>3</sup> /hr			(psi)	(kPa)
V5197A1003	Air, natural, manufactured, and LP	3/4 in.	19 mm	3570 cfh for 3/4 in.	19 mm =101	Small body	Directly bolted to Integrated Valve Train (IVT) components or IVT adapters	15 psi max	1 Bar
		1 in.	25 mm	4500 cfh for 1 in.	25 mm =127				
		1 1/4 in.	32 mm	6470 cfh for 1 1/4 in.	32 mm = 183				
		1 1/2 in.	38mm	7310 cfh for 1 1/2 in.	38 mm =207				
		2 in.	51 mm	8000 cfh for 2 in.	51 mm =226				
V5197A1011	Air, natural, manufactured, and LP	2 in.	51 mm	12,600 cfh for 2 in.	51 mm=356	Large body	Directly bolted to Integrated Valve Train (IVT) components or IVT adapters	15 psi max	1 Bar
		2 1/2 in.	64 mm	14,800 cfh for 2 1/2 in.	64 mm=419				
		3 in.	76 mm	16,900 cfh for 3 in.	76 mm=478				