

PRINT

E-250GT



The E-250GT personnel carrier combines the stability of 4-wheel vehicles with the maneuverability of 3-wheelers thanks to its exclusive steering design.

At a cruising speed of 10 mph, it transports you and your stock three times as fast as by foot! Save four hours over every eight hours of walking work, and increase your time for value-added service!

Its powerful 6 hp motor excels at trailer towing, hauling 7000 lbs with the 6 mph speed option.

Benefits

SAFETY. Four-wheel stability.

VERSATILITY. Powerful 6 hp motor for trailer towing.

RUGGEDNESS. Automotive ring gear differential, axle shafts on roller bearings.

DEPENDABILITY. Dual self-adjusting drum brakes.

COMFORT. Bucket seat on slide adjusters.

DURABILITY. Bolt-on bumpers and side bars.

BATTERY EFFICIENCY. 24V accessory option to equalize cells, extend battery life.

ROUND-THE-CLOCK OPERATION. Optional lift-out battery box.

MOTREC
Industry driven
www.motrec.com



E-250GT

Dimensions

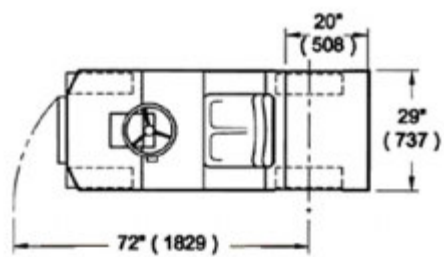
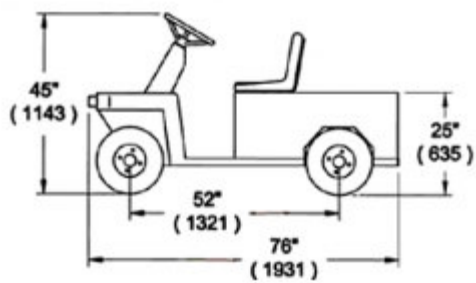

Technical specs

Type	24-volt Personnel carrier
Capacity	*500 lb. (227 kg)
Speed (Max)	10 mph (16 km/h)
Motor	6 hp
Controller	Electronic speed controller
Battery	Four 6V-220AH batteries
Charger	25 amp, built-in automatic
Transmission	Dual V-belt drive
Drive axle	Differential with automotive ring gear
Brakes	Dual self-adjusting mechanical drum brakes on rear, hand lever parking brake.
Steering	Automotive steering wheel
Suspensions	Dual coil springs and shock absorber on rear, rigid axle on front.
Seats	Bucket seat on slide adjusters
Indicators	Battery status indicator
Safeties	Optional reverse alarm, deadman seat switch
Lights	Headlight, tail/brake light
Accessories	Horn
Wheels	4.8x8 LRB pneumatic tires
Unit Weight	850 lb. (386 kg)
Options	Reverse alarm. 4.5, 6, 8 mph differential ratios. Hitch. 24-volt accessories. 6V-244AH batteries. Digital battery status indicator, hour meter. Maintenance meter. Strobe light. Convertible backrest for two passengers.
Standard	Conforms to requirements for type E as stated in UL 583 and ANSI B56.8
Notes	*includes 200 lb. per passenger. Specifications and standard equipment are subject to change without notice.



MOTREC
Industry driven
www.motrec.com