

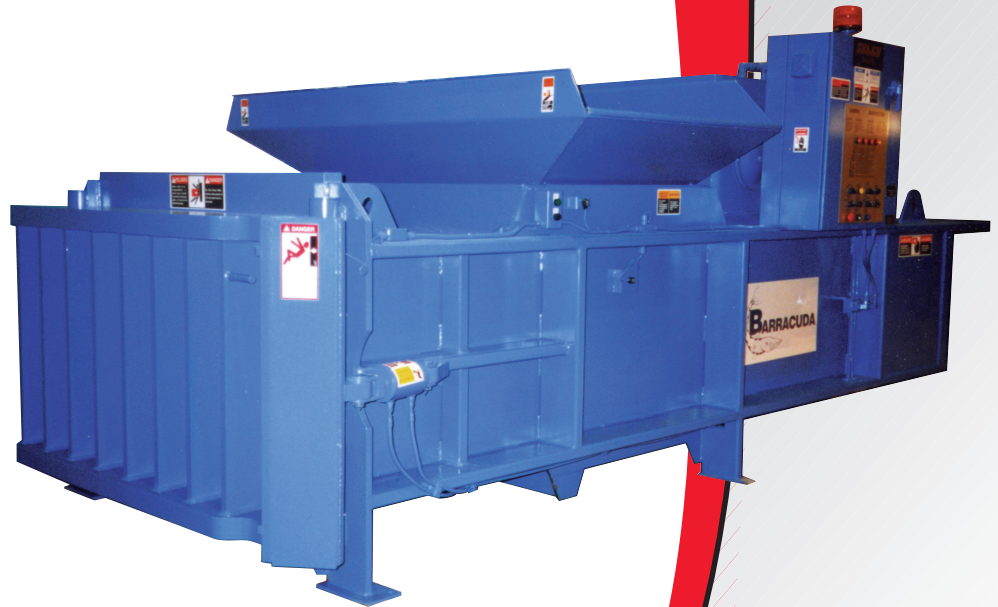

## Features Include:

- Heavy duty shear
- Allen-Bradley controls
- 31 second cycle time
- Extra heavy duty door
- Long-lasting wear pads on platen
- Auto material adjust
- Highest ram face pressure in its class
- No lube cylinder bushing
- Error diagnostics
- Full bale ejection
- Hydraulic Door Latch
- Fully lined T21 replaceable liners
- Largest chamber opening in its class
- Upper & lower photo eyes
- Low oil level float switch
- Optional tank heater



- Full flow pressure filtration
- Quick-Grab tying system
- Conveyor controls with starter
- Temperature switches, high/low/warm-up

## Processes:

- Non-Ferrous Metals
- Steel Cans
- Aluminum Cans
- Paper stock
- Secondary Fibers
- PET
- HDPE



200 Clover Reach Drive  
Peachtree City, GA 30269

[www.harriswaste.com](http://www.harriswaste.com)

(800) 373-9131 • (770) 631-7290 • (770) 631-7299 fax



## Horizontal Baling Press

Press Box Dimensions	<b>60"W x 30"D x 92"L</b> (152cm x 76cm x 234cm)		
Charging Box Opening	56.75"W x 45"L (144cm x 114cm)		
Hopper Opening	92"W x 54.75"L (manual feed) (234cm x 139cm)		
Compression Chamber Size	60"W x 30"D x 40"L (152cm x 76cm x 102cm)		
Approx. Expanded Bale Size	45"W x 30"D x 60"L (114cm x 76cm x 152cm)		
Bale Weight (average)			
	Non-Ferrous	1100-2000 lbs.	(499-907 kg)
	Steel Cans	1200-1300 lbs.	(544-590 kg)
	Aluminum UBC	650-800 lbs.	(295-363 kg)
	OCC	1000-1200 lbs.	(454-544 kg)
	ONP	1200-1400 lbs.	(544-635 kg)
	Office	1200-1300 lbs.	(544-590 kg)
	Magazines	1600-2000 lbs.	(726-907 kg)
	PET	700-900 lbs.	(318-408 kg)
	HDPE	950-1050 lbs.	(431-476 kg)
<small>PERFORMANCE RATES, BALE WEIGHTS, AND BALE DENSITIES ARE SUBJECT TO MOISTURE CONTENT, MATERIAL PRE-BALE DENSITY, FEED RATES, AND OTHER VARIABLES IN BALING.</small>			
<small>TIES,</small>			
Bale Volume	42 cubic ft. (1.2 cubic m)		
Approx. Expanded Bale Volume	47 cubic ft. (1.3 cubic m)		
Baling Cycle	approx. 31 sec. dry cycle time (10" from door)		
Ram Face Pressure	117 PSI 10" from door (8 bars 25cm from door)		
Electric Motors	One (1) 40 HP, 1750 RPM, 208/230/460v, 3 phase, 60 Hz, TEFC enclosure.		
Main Pump	One (1) 47 GPM, 5000 p.s.i. ((1) 178 LPM, 345 bars)		
Cylinders	(2) 5.5" bore, 118 tons total ((2) 14cm bore, 107 tonne total)		
Filtering	3 micron pressure filter.		
Shipping Weight	12.5 tons, approx. (11.3 tonnes, approx.)		

M00006

Revised 6/01

Performance Rates, Bale Weights, and Bale Densities are Subject to Moisture Content, Material Pre-bale Densities, Feed Rates, and Other Variables in Baling.

(SPECIFICATIONS ARE SUBJECT TO CHANGE WITHOUT NOTICE)

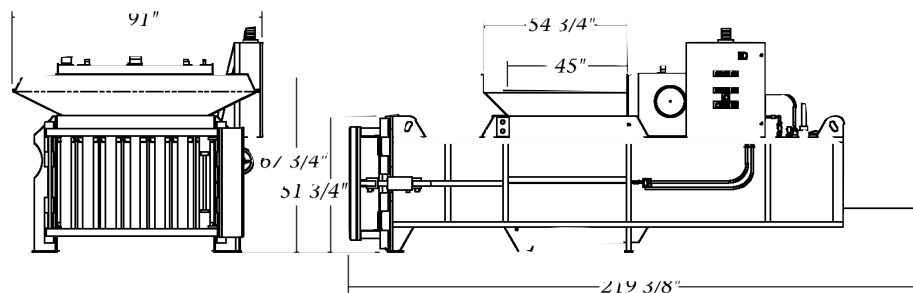

**Sales and Service By:**