

PRINT

E-480TT



The E-480TT electric vehicle, with 18 mph speed and 3000-lb. capacity, provides an efficient replacement for gas vehicles to move around your plant. It allows you to keep pace with new environmental laws while enjoying significantly lower operating costs – like all our electric burden carriers, it requires very little maintenance.

Benefits

ENDURANCE. Powerful 25 hp motor, 600 amp controller.

RUGGEDNESS. Automotive ring gear differential. Axle shafts on roller bearings.

DEPENDABILITY. Automotive 11" diameter disc brakes, bolt-on discs.

LONG RANGE. Optional dual battery pack.

MANEUVERABILITY. Short turning radius. Rear battery, less weight on front.

COMFORT. Bucket seats on slide adjusters.

STURDINESS. 14-G diamond-plate steel, tubular frame.

DURABILITY. Optional bolt-on bumpers.

BATTERY EFFICIENCY. DC/DC converter to equalize cells, extend battery life.

MOTREC
Industry driven
www.motrec.com



E-480TT

Dimensions

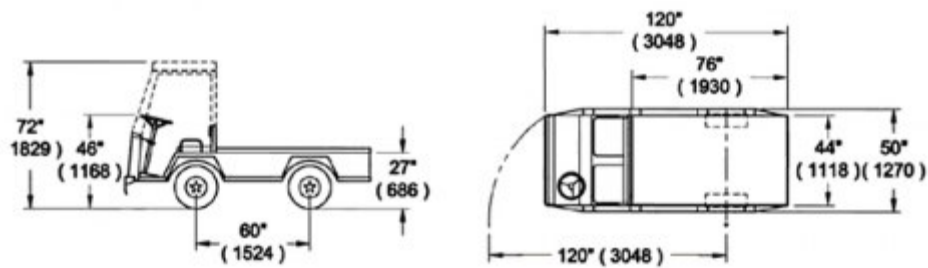

Technical specs

Type	48-volt burden carrier.
Capacity	*3,000 lb. (1 364 kg).
Speed (Max)	18 mph (28 km/h).
Motor	25 hp shunt motor.
Controller	SEPEX electronic speed controller.
Battery	Eight 6V-244AH batteries.
Charger	25 amp, built-in, automatic.
Transmission	GOODYEAR Eagle Synchronous drive.
Drive axle	Differential with automotive ring gear.
Brakes	Four-wheel hydraulic brakes, 11" diameter automotive discs.
Steering	Automotive steering wheel.
Suspensions	Dual leaf springs and shock absorbers on front and rear.
Seats	Two bucket seats on slide adjusters.
Indicators	Digital battery status indicator, hour meter.
Safeties	Deadman seat switch, reverse alarm, reverse lights.
Lights	48V/12V converter for accessories, dual halogen headlights, tail/brake lights, reverse lights, turn signals.
Accessories	Horn, fold down sides, tailgate, central storage compartment.
Wheels	20.5 x 8 x10, LRE
Unit Weight	1,800 lb. (818 kg) with batteries
Options	Maintenance meter Dual battery pack, sixteen 6V-244AH batteries Roll-out battery box Steel cab and doors, panel box.
Standard	Conforms to requirements for type E as stated in UL 583 and ANSI B56.8
Notes	*includes 200 lb. per passenger. Specifications and standard equipment are subject to change without notice.



MOTREC
Industry driven
www.motrec.com