

PRINT

E-302

E-302 is a genuine industrial vehicle, designed for rugged applications.

It's built to last with a sturdy 14-G diamond-plate steel body, high-strength tubular frame and optional bolt-on bumpers.

Optional 4-passenger configuration, with a foldaway rear seat, allows you to carry personnel or cargo.

Dual headlights and reverse alarm options improve safety.

Hydraulic brake option reduces maintenance costs.

Benefits

ENDURANCE. Powerful 10 hp motor for trailer towing.

COMFORT. Bucket seats on slide adjusters.

STURDINESS. 14-G diamond-plate steel body, tubular frame.

DURABILITY. Optional bolt-on bumpers.

LOW MAINTENANCE COST. Optional hydraulic brakes.

SECURITY. Optional dual headlights and reverse alarm.

BATTERY EFFICIENCY. Optional DC/DC converter to equalize battery cells.

MOTREC
Industry driven
www.motrec.com



E-302

Dimensions

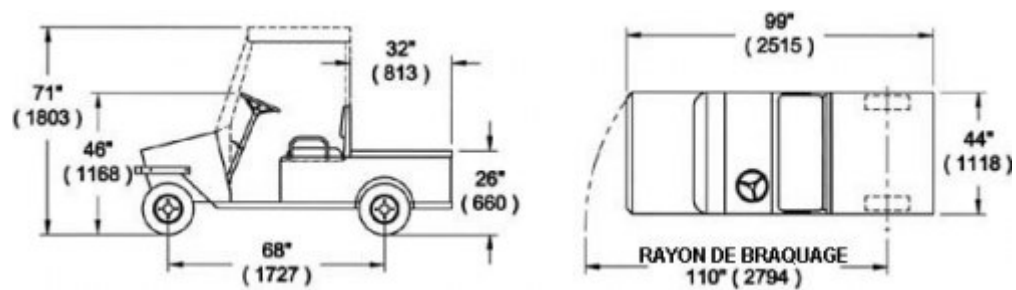

Technical specs	
Type	36-volt Personnel Carrier
Capacity	*1,200 lb. (545 kg)
Speed (Max)	10 mph (16 km/h)
Motor	10 hp
Controller	Electronic speed controller
Battery	Six 6V-220AH batteries
Charger	25 amp, built-in, automatic
Transmission	Direct drive
Drive axle	Helical gear differential
Brakes	Rear mech. drum brakes, hand lever parking brake
Steering	Automotive steering wheel
Suspensions	Dual leaf springs on front and rear
Seats	Two bucket seats on slide adjusters
Indicators	Battery status indicator
Safeties	Deadman seat switch, optional reverse alarm
Lights	Dual tail/brake lights, optional dual headlights
Accessories	Horn
Wheels	4.8x8 LRC pneumatic tires
Unit Weight	1,200 lb. (545 kg) with batteries
Options	Dual headlights. Reverse alarm. Hydraulic brakes. Bolt-on bumpers. 36VDC/12VDC converter for accessories. 6V-244AH batteries. Strobe light. Turn signals. Digital battery status indicator, hour meter. Maintenance meter. Rear flip-up seat for four passengers.
Standard	Conforms to requirements for type E as stated in UL 583 and ANSI B56.8
Notes	*includes 200 lb. per passenger. Specifications and standard equipment are subject to change without notice.



MOTREC
Industry driven
www.motrec.com