

PRINT

# E-250



The E-250 personnel carrier combines the stability of 4-wheel vehicles with the maneuverability of 3-wheelers thanks to its exclusive steering design.

Powerful 6 hp motor excels at trailer towing, hauling 7000 lbs with the 6 mph speed option.

Low maintenance is guaranteed by rugged automotive differential and larger self-adjusting drum brakes.

E-250 is built to last with 14-G diamond-plate body, high-strength tubular steel frame, bolt-on bumpers.

## Benefits

**SAFETY.** Four-wheel stability.

**ENDURANCE.** Powerful 6 hp motor for trailer towing.

**RUGGEDNESS.** Automotive ring gear differential, axle shafts on roller bearings.

**DEPENDABILITY.** Dual self-adjusting drum brakes, larger drums.

**COMFORT.** Bucket seat on slide adjusters.

**DURABILITY.** Bolt-on bumpers and side bars.

**BATTERY EFFICIENCY.** 24V accessory option to equalize cells, extend battery life.

**ROUND-THE-CLOCK OPERATION.** Optional lift-out battery box.

**MOTREC**  
Industry driven  
[www.motrec.com](http://www.motrec.com)



## E-250

### Dimensions

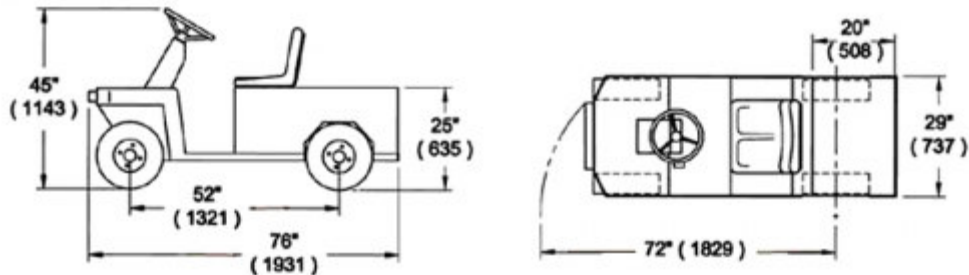

### Technical specs

<b>Type</b>	24-volt Personnel Carrier
<b>Capacity</b>	*500 lb. (227 kg)
<b>Speed (Max)</b>	10 mph (16 km/h)
<b>Motor</b>	6 hp
<b>Controller</b>	Electronic speed controller
<b>Battery</b>	Four 6V-220AH batteries
<b>Charger</b>	25 amp, built-in automatic
<b>Transmission</b>	Dual V-belt drive
<b>Drive axle</b>	Differential with automotive ring gear
<b>Brakes</b>	Dual self-adjusting mechanical drum brakes on rear, hand lever parking brake.
<b>Steering</b>	Automotive steering wheel
<b>Suspensions</b>	Dual coil springs and shock absorber on rear, rigid axle on front.
<b>Seats</b>	Bucket seat on slide adjusters
<b>Indicators</b>	Battery status indicator
<b>Safeties</b>	Optional reverse alarm, deadman seat switch
<b>Lights</b>	Headlight, tail/brake light
<b>Accessories</b>	Horn
<b>Wheels</b>	4.8x8 LRB pneumatic tires
<b>Unit Weight</b>	850 lb. (386 kg)
<b>Options</b>	Reverse alarm. 4.5, 6, 8 mph differential ratios. Hitch. 24-volt accessories. 6V-244AH batteries. Digital battery status indicator, hour meter. Maintenance meter. Strobe light. Convertible backrest for two passengers. MX maintenance kit with toolbox and storage cabinets.
<b>Standard</b>	Conforms to requirements for type E as stated in UL 583 and ANSI B56.8
<b>Notes</b>	*includes 200 lb. per passenger. Specifications and standard equipment are subject to change without notice.



**MOTREC**  
Industry driven  
www.motrec.com