



Boiler Controls

McDonnell & Miller

Low Water Cut-Offs – Electronic For Hot Water and Steam Boilers

Series 750

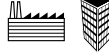

Low Water Cut-Offs with Remote Sensor

- For commercial or industrial applications
- Primary or secondary control on hot water boilers
- Secondary control (manual reset models only) on steam boilers
- Manual reset models meet the requirements of **ASME Standard CSD-1**. If the control is in a low water condition when there is an interruption of power, the control will remain in a low water condition when power is restored. The reset button will need to be pressed when the water level is restored to a level above the probe to allow the burner to fire.
- Green LED power indicating light
- Red LED low water indicating light
- Test switch
- 20,000 ohms sensitivity
- Options:
 - Manual reset button
 - 750P-MT model includes PA-800 probe
 - 750P-MT-U model includes PA-800-U probe
- NEMA 1 enclosure
- Maximum ambient temperature 120°F (49°C)



Series 750 Control Unit



750P-MT-120
750P-MT-U-120

NOW WITH SELF-CLEANING PROBE!

Ordering Information

(Remote sensor must be ordered separately ((see page 72-74)

Model Number	Part Number	Description	Weight lbs. (kg)
750-T-120	176206	Auto reset	2 (.9)
750-MT-120	176207	Manual reset	2 (.9)
750P-MT-120	176234	Manual reset and PA-800 probe	2.5 (.9)
750P-MT-U-120	176214	Manual reset and PA-800-U probe	2.5 (.9)

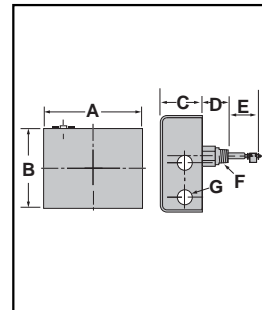

Electrical Ratings

Voltage	Motor Switch Rating (Amperes)		Pilot Duty
	Full Load	Locked Rotor	
120 VAC	7.2	43.2	125 VA at 120 or 240 VAC 50 or 60 Hz
240 VAC	3.6	21.6	

Dimensions, in. (mm)

A	B	C	D		E		F NPT	G
			Std.	U	Std.	U		
6 ³ / ₈ (162)	5 ⁷ / ₈ (130)	2 ⁵ / ₁₆ (65)	1 ¹ / ₁₆ (40)	3 ¹ / ₁₆ (78)	2 ⁷ / ₈ (54)	1 ¹ / ₁₆ (40)	³ / ₄	³ / ₄ (20)

Boiler Controls