

## 950 Stylemate® Bathtub Walls

Thermoplastic ■ Economy



### 950 STYLEMATE®

- Fit Standard 5 ft. (or less) Bathtub, Adhesive Mount
- 5 White Panels, Seamless Corners, 4 Shelves
- Adapt to Uneven Walls
- Smooth Satin Finish, Mildew Resistant, Uniform Color
- Can be Cut Out for Window
- DURATRIM™ Window Trim Kit Available, Model 52.600W

### SPECIFICATIONS

Model No.	Color	UPC
950	White	6 71031 00235 8

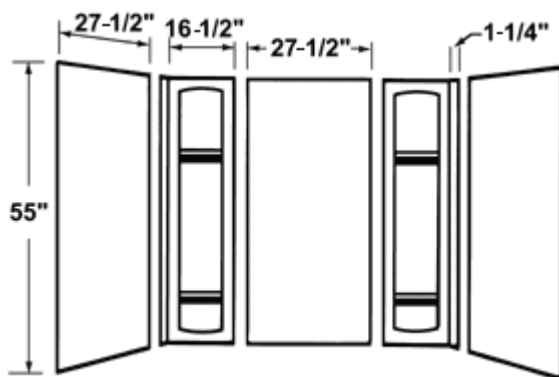

General: Furnish and install per plans, Stylemate® Bathtub Walls model 950, as manufactured by E.L. Mustee & Sons, Inc. The white thermoplastic wall system shall be 5-piece construction with four built-in shelves and seamless, overlapping corner panels.

Carton Contains: Three flat and two corner panels. Carton is 56"x28"x3", weight 20 lbs., cubic ft. 3.3.

Requires three 11 oz. cartridges of top-grade panel adhesive for bonding polystyrene or polystyrene foam materials. Don't use adhesive containing tar, asphalt, lacquer thinner or toluene.