

# Vertical Hollow Shaft Three-Phase Motors

---



## Now Your Best Alternative!

- ▶ **For All Deep Well -  
High Thrust Load  
Pumping Applications**
- ▶ **Meets NEMA MG-1 Standard**
- ▶ **CSA Approved And Certified**
- ▶ **50 HP - 250 HP (460 Volt)  
Suitable For Part Wind Start**
- ▶ **Class F Insulation  
With 1.15 Service Factor**
- ▶ **Standard NEMA Vertical  
P Base Frames Will Allow  
Drop-In Replacement For  
Major Competitors**
- ▶ **Ultra-Heavy Duty  
Pin Coupling Design**
- ▶ **All Cast Iron Frame  
Including The Top Hat!**
- ▶ **Anti-Corrosion / Rust Resistant  
Primer With "Extra-Tough"  
Poly Paint Finish Coat**





# Vertical Hollow Shaft Three-Phase Motors



## Motor Construction

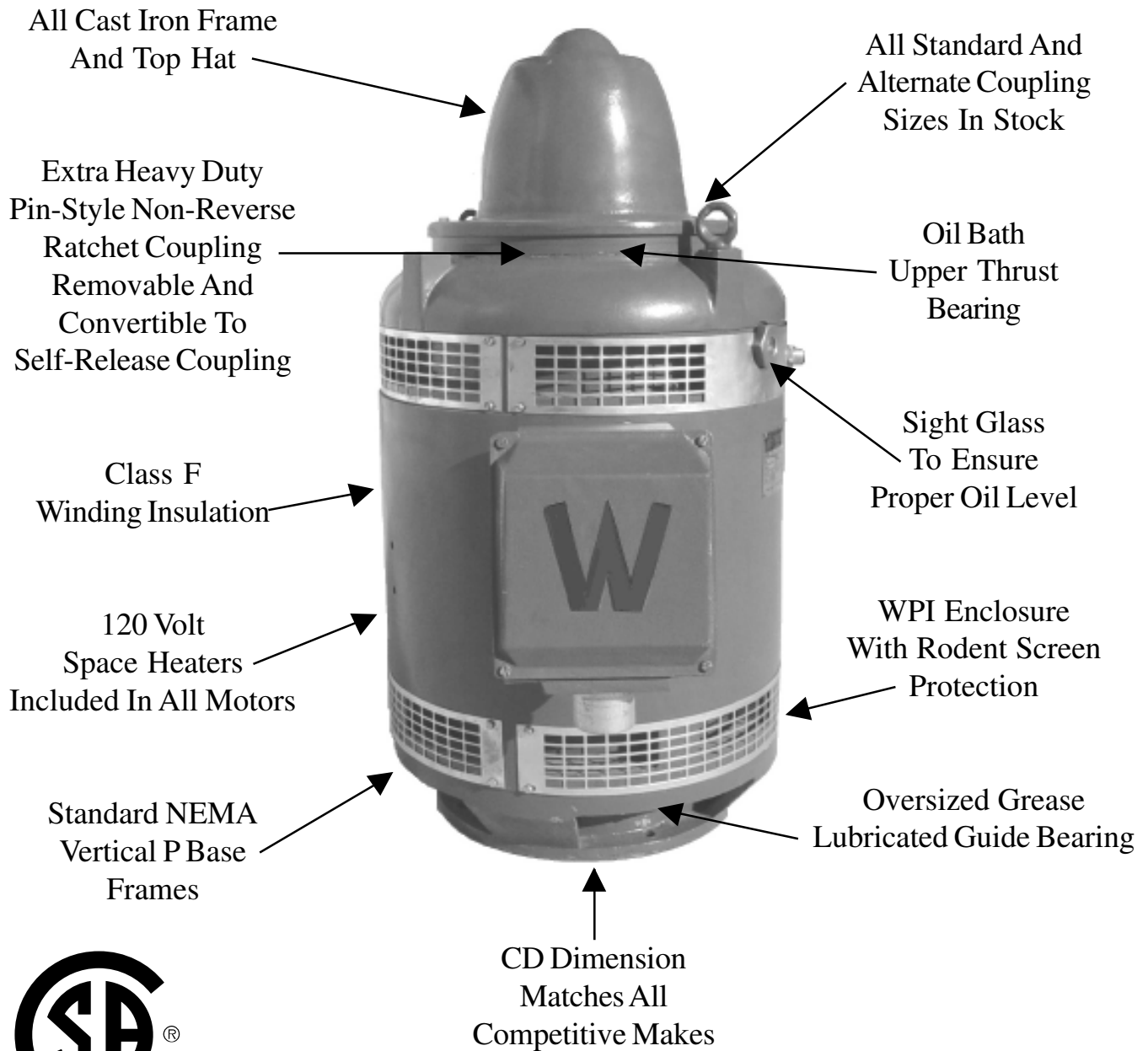

# Vertical Hollow Shaft Three-Phase Motors



## Motor Selection Chart

HP	RPM	Voltage	Frame Size	Base Diameter	Model Number	List * Price
25	1800	230/460	284TPA	12	VHS25-18-2/4-284TPA	\$3,105.59
25	1800	230/460	284TPH	16.5	VHS25-18-2/4-284TPH	\$3,105.59
30	1800	230/460	286TPA	12	VHS30-18-2/4-286TPA	\$3,289.25
30	1800	230/460	286TPH	16.5	VHS30-18-2/4-286TPH	\$3,289.25
40	1800	230/460	324TP	16.5	VHS40-18-2/4-324TP	\$3,678.85
40	1800	230/460	324TPH	12	VHS40-18-2/4-324TPH	\$3,678.85
50	1800	460	326TP	16.5	VHS50-18-460-326TP	\$4,146.35
50	1800	460	326TPH	12	VHS50-18-460-326TPH	\$4,146.35
60	1800	460	364TP	16.5	VHS60-18-460-364TP	\$4,502.55
75	1800	460	365TP	16.5	VHS75-18-460-365TP	\$6,495.02
100	1800	460	404TP	16.5	VHS100-18-460-404TP	\$7,101.67
125	1800	460	405TP	16.5	VHS125-18-460-405TP	\$7,658.23
150	1800	460	444TP	16.5	VHS150-18-460-444TP	\$9,105.28
150	1800	460	444TPA	20	VHS150-18-460-444TPA	\$9,105.28
200	1800	460	445TP	16.5	VHS200-18-460-445TP	\$13,663.48
200	1800	460	445TPA	20	VHS200-18-460-445TPA	\$13,663.48
250	1800	460	445TPA	20	VHS250-18-460-445TPA	\$15,466.73

# Vertical Hollow Shaft Three-Phase Motors



## Coupling Selection Chart

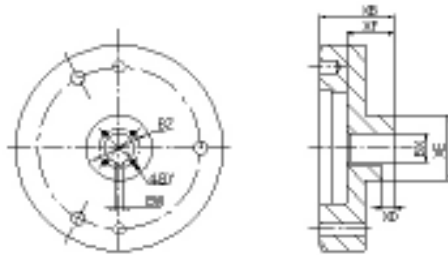

Frame Size	Model Number	Nominal BX	BY	BZ	XB	XE	XF	SQ Key (EW)	List Price
280TP	WCK280-.75	3/4	10-32	1-3/8	2-9/16	2-1/4	1-5/8	3/16	\$114.49
	WCK280-.875	7/8	10-32	1-3/8	2-9/16	2-1/4	1-5/8	3/16	
	WCK280-1	1	10-32	1-3/8	2-9/16	2-1/4	1-5/8	1/4	
	WCK280-1.0625	1-1/16	10-32	1-3/8	2-9/16	2-1/4	1-5/8	1/4	
	WCK280-1.1875	1-3/16	1/4-20	1-3/4	2-9/16	2-1/4	1-5/8	1/4	
	WCK280-1.25-.25	1-1/4	1/4-20	1-3/4	2-9/16	2-1/4	1-5/8	1/4	
	WCK280-1.25-.375	1-1/4	1/4-20	1-3/4	2-9/16	2-1/4	1-5/8	3/8	
320TP	WCK320-1	1	1/4-20	1-3/4	2-15/16	2-7/8	1-15/16	1/4	\$123.96
	WCK320-1.1875	1-3/16	1/4-20	1-3/4	2-15/16	2-7/8	1-15/16	1/4	
	WCK320-1.25-.375	1-1/4	1/4-20	1-3/4	2-15/16	2-7/8	1-15/16	3/8	
	WCK320-1.25-.25	1-1/4	1/4-20	1-3/4	2-15/16	2-7/8	1-15/16	1/4	
	WCK320-1.3125	1-5/16	1/4-20	1-3/4	2-15/16	2-7/8	1-15/16	3/8	
	WCK320-1.4375	1-7/16	1/4-20	2-1/8	2-15/16	2-7/8	1-15/16	3/8	
	WCK320-1.5	1-1/2	1/4-20	2-1/8	2-15/16	2-7/8	1-15/16	3/8	
360TP	WCK360-1	1	1/4-20	1-3/4	2-15/16	2-7/8	1-15/16	1/4	\$143.71
	WCK360-1.1875	1-3/16	1/4-20	1-3/4	2-15/16	2-7/8	1-15/16	1/4	
	WCK360-1.25-.25	1-1/4	1/4-20	1-3/4	2-15/16	2-7/8	1-15/16	1/4	
	WCK360-1.25-.375	1-1/4	1/4-20	1-3/4	2-15/16	2-7/8	1-15/16	3/8	
	WCK360-1.3125	1-5/16	1/4-20	1-3/4	2-15/16	2-7/8	1-15/16	3/8	
	WCK360-1.4375	1-7/16	1/4-20	2-1/8	2-15/16	2-7/8	1-15/16	3/8	
	WCK360-1.5	1-1/2	1/4-20	2-1/8	2-15/16	2-7/8	1-15/16	3/8	
400TP	WCK400-1.1875	1-3/16	1/4-20	2-1/8	3-13/32	3-1/8	2-13/32	1/4	\$165.02
	WCK400-1.25-.25	1-1/4	1/4-20	2-1/8	3-13/32	3-1/8	2-13/32	1/4	
	WCK400-1.25-.375	1-1/4	1/4-20	2-1/8	3-13/32	3-1/8	2-13/32	3/8	
	WCK400-1.4375	1-7/16	1/4-20	2-1/8	3-13/32	3-1/8	2-13/32	3/8	
	WCK400-1.5	1-1/2	1/4-20	2-1/8	3-13/32	3-1/8	2-13/32	3/8	
	WCK400-1.5625	1-9/16	1/4-20	2-1/2	3-13/32	3-1/8	2-13/32	3/8	
	WCK400-1.6875	1-11/16	1/4-20	2-1/2	3-13/32	3-1/8	2-13/32	3/8	
	WCK400-1.8125	1-13/16	1/4-20	2-1/2	3-13/32	3-1/8	2-13/32	3/8	
440TP	WCK440-1.4375	1-7/16	1/4-20	2-1/2	4	3-11/16	2-7/8	3/8	\$274.78
	WCK440-1.5	1-1/2	1/4-20	2-1/2	4	3-11/16	2-7/8	3/8	
	WCK440-1.3125	1-5/16	1/4-20	2-1/2	4	3-11/16	2-7/8	3/8	
	WCK440-1.6875	1-11/16	1/4-20	2-1/2	4	3-11/16	2-7/8	3/8	
	WCK440-1.75	1-3/4	1/4-20	2-1/2	4	3-11/16	2-7/8	3/8	
	WCK440-1.9375	1-15/16	1/4-20	2-1/2	4	3-11/16	2-7/8	1/2	
	WCK440-2.1875	2-3/16	1/4-20	3-1/4	4	4	2-7/8	1/2	

\* Same Specifications For C-Flange Mount Motors