

# Permanent Split Capacitor Double Shaft Fan & Blower

## 5.6" Diameter, Open Dripproof, Air Over

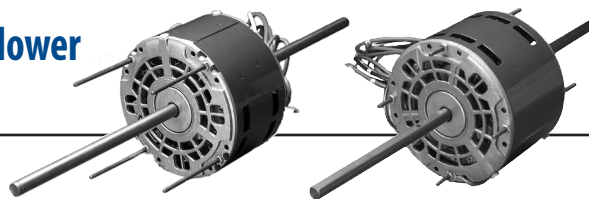

### APPLICATIONS:

Design for blowers utilizing a double-shaft motor.

### FEATURES:

- Automatic Reset Thermal Overload Protector
- CCW Rotation Lead End
- Sleeve Bearings have All Angle Thrust System
- Continuous Duty, Air Over
- Green Ground Lead
- Connection and Capacitor Information Furnished on Nameplate
- Designed for use with 370V Capacitors
- Mounting Holes in Shell for Mounting Capacitor
- When supplied, Capacitor and Mounting Hardware are supplied detached
- 20" Leads
- Class B Insulation
- Discount Symbol: DS-3HAC

- Hub Rings are 2 1/4" Diameter, furnished detached, with extra Metal Outer Rings for adapting to 2 1/2" Diameter

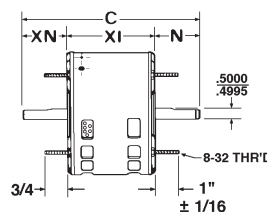

Figure A

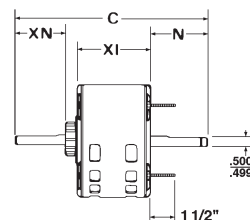

Figure B

### Hub or Stud Mount, Without Capacitor and Mounting Kit, Single Speed (Fig. B)

HP	RPM/ Spds.	Volts	Catalog Number	List Price	Bearings	Cap MFD	Amps	Shaft N	Shaft XN	Shell XI	Total C	Ship Wgt.	Notes	OEM
1/10	1075	115	2821	\$115	Slv	-	3.7	4.6	-	4.9	14.1	11	6, LA	
1/8	1075	277	1012	\$143	Slv	5.0	0.8	8.45	-	3.56	21.6	10	4, LA	SI
1/4	1075	208-230	1189	\$204	Slv	5.0	1.9	6.0	-	4.3	16.3	14	5, LA	
1/3	1075	115	1329	\$140	Slv	-	4.4	7.0	-	5.4	19.4	16	LA	
1/2	1075	208-230	2554	\$184	Slv	7.5	2.4	9.1	9.1	4.8	24.1	18		YK

### Hub or Stud Mount, With Capacitor and Mounting Kit, Two Speed (Fig. B)

HP	RPM/ Spds.	Volts	Catalog Number	List Price	Bearings	Cap MFD	Amps	Shaft N	Shaft XN	Shell XI	Total C	Ship Wgt.	Notes	OEM
1/4	1075/2	115	1244	\$136	Slv	5.0	4.4	7.0	7.0	4.4	19.4	16	2	
	1625/2	115	1242	\$144	Slv	3.0	3.6	7.0	7.0	3.9	18.9	13	2	
	1625/2	230	1243	\$148	Slv	3.0	1.8	7.0	7.0	3.9	18.9	12	2	
1/2	1075/2	230	1248	\$101	Slv	5.0	3.8	7.0	7.0	4.9	19.9	19	2	

### Hub or Stud Mount, With Capacitor and Mounting Kit, Three Speed (Fig. B)

HP	RPM/ Spds.	Volts	Catalog Number	List Price	Bearings	Cap MFD	Amps	Shaft N	Shaft XN	Shell XI	Total C	Ship Wgt.	Notes	OEM
1/6	1075/3	115	1216	\$133	Slv	5.0	3.0	8.0	8.0	3.6	20.1	12		
	1075/3	230	1215	\$135	Slv	4.0	1.5	8.0	8.0	4.1	20.1	12		
	1075/3	115	1240	\$128	Slv	5.0	2.9	7.0	7.0	3.7	18.7	12	2	
	1075/3	230	1241	\$130	Slv	4.0	1.5	7.0	7.0	3.7	18.7	11	2	
	1625/3	230	1885	\$200	Slv	5.0	1.4	8.0	8.0	3.8	20.3	14		
	1625	115	8527	\$176	SLV	-	2.2	9.0/7.0	-	4.6	20.6	11	LA	
1/3	1075/3	230	1213	\$138	Slv	5.0	2.5	8.0	8.0	4.3	20.1	18		
	1075/3	230	5108	\$161	Slv	5.0	2.3	4.3	4.6	4.3	14.2	16		WP
	1075/3	230	1247	\$154	Slv	5.0	2.5	7.0	7.0	4.7	19.7	18	2	
	1625/3	230	1887	\$184	Slv	5.0	2.2	8.0	8.0	4.3	20.8	13		
1/2	1075/3	230	5824	\$166	Slv	5.0	4.5	5.7	5.7	6.3	18.9	18	1	
	1075/3	230	1824	\$160	Slv	5.0	4.5	8.0	8.0	5.4	22.0	19		

Note 1 With Two 5/8" Shaft Adapters and Hubs on Both Ends.  
Length Adapter Not Supplied

Note 2 Resilient Mounting

Note 3 Totally Enclosed Air Over

Note 4 OEM Replacement for Singer<sup>®</sup>

Note 5 Class A Insulation

Note 6 Resilient Base

Note 7 Reversible Rotation

† All non-Emerson Electric Co. marks shown within this document are properties of their other respective owners.

# Permanent Split Capacitor Double Shaft Fan & Blower

## 5.6" Diameter, Open Dripproof, Air Over

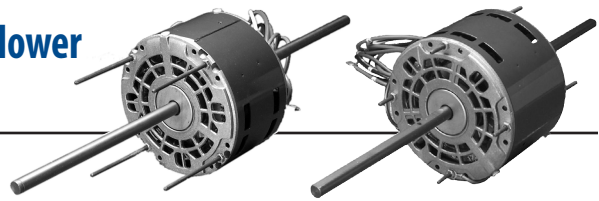

### APPLICATIONS:

Design for blowers utilizing a double-shaft motor.

Discount Symbol: DS-3HAC

### Hub or Stud Mount, Without Capacitor and Mounting Kit, Three Speed (Fig. B)

HP	RPM/Spds.	Volts	Catalog Number	List Price	Bearings	Cap MFD	Amps	Shaft N	Shaft XN	Shell XI	Total C	Ship Wgt.	Notes	OEM
1/8	1075/3	115	8523	\$141	Slv	5.0	2.1	7.0	9.0	3.7	20.1	11		
1/6	1075/3	115	12160	\$88	Slv	5.0	3.0	8.0	8.0	3.6	20.1	11		
	1075/3	230	3133	\$89	Slv	4.0	1.5	8.0	8.0	3.8	20.4	12		
1/5	1000/3	208-230	8682	\$104	Slv	7.5	1.9	4.3	4.3	5.8	14.3	13	LA	WP
1/4	1075/3	230	3134	\$95	Slv	5.0	1.9	8.0	8.0	4.6	20.1	13		
1/3	1075/3	230	3135	\$103	Slv	5.0	2.5	8.0	8.0	4.6	21.1	14		
1/2	1075/3	230	3136	\$110	Slv	5.0	4.5	8.0	8.0	5.4	22.0	20		
	1100/3	208-230	8683	\$128	Slv	10.0	2.0	4.3	4.3	5.8	12.3	16	LA	WP

### Hub or Stud Mount, Without Capacitor and Mounting Kit, Four Speed (Fig. B)

HP	RPM/Spds.	Volts	Catalog Number	List Price	Bearings	Cap MFD	Amps	Shaft N	Shaft XN	Shell XI	Total C	Ship Wgt.	Notes	OEM
1/15	1075	115	8521	\$166	Slv	-	1.26	10.5	-	4.7	25.7	10	LA	
1/10	1625	115	8522	\$163	Slv	5.0	1.96	8.0	-	5.4	21.4	11	LA	

### Stud Mount, Without Capacitor and Mounting Kit, Three Speed, Economizer® High Efficiency (Fig. A)

HP	RPM/Spds.	Volts	Catalog Number	List Price	Bearings	Cap MFD	Amps	Shaft N	Shaft XN	Shell XI	Total C	Ship Wgt.	Notes	OEM
1/8	1075/3	115	1186	\$183	Slv	5.0	2.1	6.0	6.0	3.9	15.8	12	3	
	1075/3	208-230	1187	\$186	Slv	5.0	0.9	6.0	6.0	3.9	15.8	12	3	
1/5	1075/3	208-230	1188	\$199	Slv	5.0	1.4	6.0	6.0	3.9	15.8	12	3	
1/4	1625/3	230	8725	\$155	Slv	6.0	1.6	7.0	7.0	4.1	18.1	12		
1/3	1625/3	230	8726	\$161	Slv	7.5	1.9	7.0	7.0	4.3	18.3	13		

### Resilient Base, Without Capacitor & Mounting Kit, Two Speed

HP	RPM/Spds.	Volts	Catalog Number	List Price	Bearings	Cap MFD	Amps	Shaft N	Shaft XN	Shell XI	Total C	Ship Wgt.	Notes	OEM
1/10	1075	115	2819	\$123	Slv	-	3.7	4.7	-	4.9	14.3	10	LA	
1/6	1625	115	1238	\$176	Slv	-	2.3	7.0	-	4.9	18.9	11	7, LA	

### Resilient Base, Without Capacitor & Mounting Kit, Three Speed

HP	RPM/Spds.	Volts	Catalog Number	List Price	Bearings	Cap MFD	Amps	Shaft N	Shaft XN	Shell XI	Total C	Ship Wgt.	Notes	OEM
1/10	1550	115	2817	\$190	Slv	-	3.8	8.4	-	5.6	22.4	12	LA	
	1050	115	2828	\$144	Slv	-	4.8	8.4	-	5.1	21.9	13	LA	

### Ring Mount, Without Capacitor & Mounting Kit, Three Speed

HP	RPM/Spds.	Volts	Catalog Number	List Price	Bearings	Cap MFD	Amps	Shaft N	Shaft XN	Shell XI	Total C	Ship Wgt.	Notes	OEM
1/15	1075	115	1040	\$153	Slv	-	1.0	6.0	-	4.4	16.4	9	LA	

Note 1 With Two 5/8" Shaft Adapters and Hubs on Both Ends.  
Length Adapter Not Supplied

Note 2 Resilient Mounting

Note 3 Totally Enclosed Air Over

Note 4 OEM Replacement for Singer®†

Note 5 Class A Insulation

Note 6 Resilient Base

Note 7 Reversible Rotation

† All non-Emerson Electric Co. marks shown within this document are properties of their other respective owners.