

BEHRINGER®

Mahle Pi320 High Flow



The Challenge:

Typically, pressure filters are limited to approximately 100 gpm capacity. If a system requires pressure filters to handle flows above 100 gpm, the most common solution is to connect multiple filters in parallel and divide the flow equally between the filters. This solution requires additional space, installation time and more tubing, fittings and other mounting hardware.

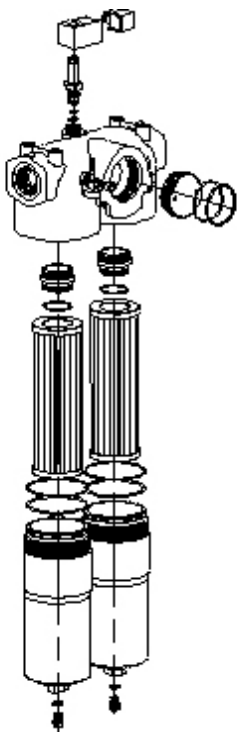

The Solution:

The Mahle Pi320 high flow filter series is capable of flows to 170 gpm. The compact design allows for higher flow rates in a single filter, there is no need to mount additional filters in parallel. No added cost of assembly and mounting hardware is required.

Advantages:

- Highly efficient SM-X Elements
- Large dirt-holding capacity
- Compact design
- Various micron rating available
- NPT, SAE and SAE flange connections
- Visual, electrical and electronic clogging indication