

# **BEHRINGER®**

## **DO3/DO5 Stacking Pressure Filters**



### **The Challenge:**

Placement of pressure filters is crucial to adequately protecting the system's most sensitive components. Due to the layout of some hydraulic systems, the pressure filters can sometimes be mounted in a less than optimal location; with long runs of tubing between it and the components to be protected.

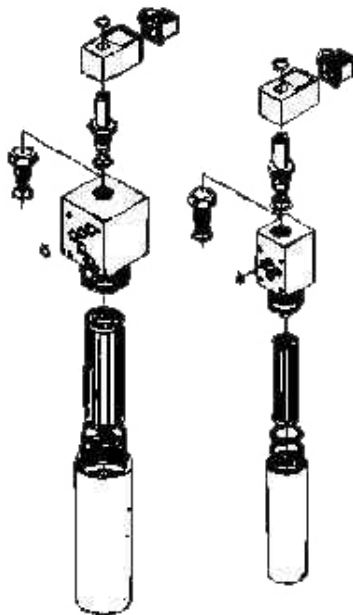

### **The Solution:**

The Mahle Modular Stacking filters offers the best protection of directional control and/or proportion valves by eliminating any area before the sensitive components for dirt to enter the system. The compact, space-saving design also allows for easier and quicker installation.

### **Advantages:**

- Highly efficient SM-X Elements
- Large dirt-holding capacity
- Compact design
- Visual, electrical and electronic clogging indication
- Variety of micron ratings available

**BEHRINGER**®

**BEHRINGER CORP., 17 RIDGE ROAD, BRANCHVILLE, NEW JERSEY 07826**  
973\*948\*0226 fax: 973\*948\*2562 [www.behringersystems.com](http://www.behringersystems.com) [cserv@behringersystems.com](mailto:cserv@behringersystems.com)