

# BEHRINGER®

## Behringer's New Sanitary Clamp

In Inventory

**SIZE RANGE:** 1/2" through 6" tube.

**MATERIAL:** 304 Stainless

**FINISH:** 26 RA

**SERVICE:** Used in connection of sanitary tube & fittings

**ORDERING:** Specify figure number, name, clamp type number and tube size.

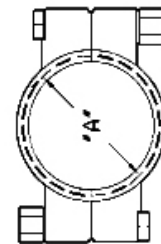
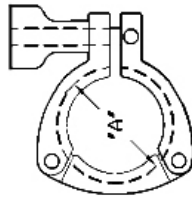
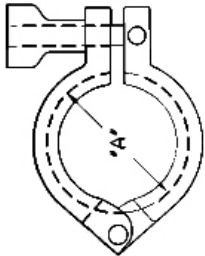

STANDARD CLAMP	
SANITARY CLAMP TYPE 1	
Size Range: 1/2" to 6" TUBE O.D.	
SIZE (TUBE O.D.)	Ø A
1/2 - 3/4 "	1.1"
1-1 1/2"	2.1"
2"	2.6"
2 1/2"	3.1"
3"	3.7"
4"	4.8"
6"	6.7"

3 SEGMENT CLAMP	
SANITARY CLAMP TYPE 2	
Size Range: 1 1/2" to 4" TUBE O.D.	
SIZE (TUBE O.D.)	Ø A
1 1/2"	2.1"
2"	2.6"
2 1/2"	3.1"
3"	3.7"
4"	4.8"

PRESSURE CLAMP	
SANITARY CLAMP TYPE 3	
Size Range: 1 1/2" to 4" TUBE O.D.	
SIZE (TUBE O.D.)	Ø A
1 1/2"	2.1"
2"	2.6"
2 1/2"	3.1"
3"	3.7"
4"	4.8"