

ELBOWS (Cont.)

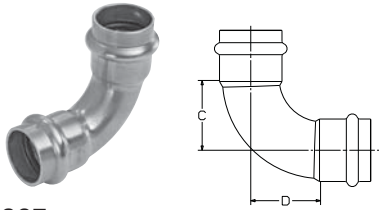

PC607
90° Elbow P x P – Wrot

NOM. SIZE	APPROX. NET WT./LBS.	DIM. C INCHES	DIM. D INCHES
1/2	.109	3/4	3/4
3/4	.200	1	1
3/4 x 1/2	.190	1 ³ / ₁₆	1 ¹ / ₁₆
1	.290	1 ¹¹ / ₃₂	1 ¹¹ / ₃₂
1 1/4	.402	1 ¹¹ / ₁₆	1 ¹¹ / ₁₆
1 1/2	.724	2	2
2	1.103	2 ⁵ / ₈	2 ⁵ / ₈
2 1/2	1.364	1 ²⁷ / ₃₂	1 ²⁷ / ₃₂
3	1.998	2 ³ / ₃₂	2 ³ / ₃₂
4	4.060	2 ²⁵ / ₃₂	2 ²⁵ / ₃₂

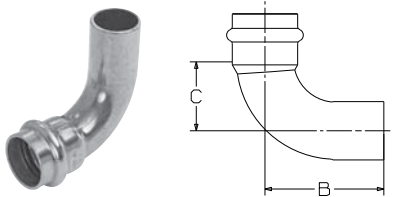

PC607-2
90° Elbow Ftg x P – Wrot

NOM. SIZE	APPROX. NET WT./LBS.	DIM. B INCHES	DIM. C INCHES
1/2	.104	1 ²³ / ₃₂	2 ⁵ / ₃₂
3/4	.193	1 ³¹ / ₃₂	1 ⁵ / ₃₂
1	.272	2 ⁹ / ₃₂	1 ¹¹ / ₃₂
1 1/4	.619	2 ³¹ / ₃₂	1 ⁷ / ₈
1 1/2	.974	3 ²¹ / ₃₂	2 ¹ / ₄
2	1.469	4 ¹⁵ / ₃₂	2 ¹⁵ / ₁₆
2 1/2	1.356	3 ¹⁵ / ₃₂	1 ²⁹ / ₃₂
3	2.065	3 ¹³ / ₁₆	2 ³ / ₃₂
4	3.920	4 ³ / ₄	2 ²⁵ / ₃₂

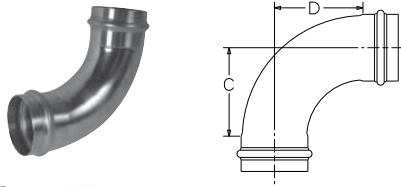

PC607-LT
90° Long Radius Elbow
P x P – Wrot

NOM. SIZE	APPROX. NET WT./LBS.	DIM. C INCHES	DIM. D INCHES
2 1/2	2.066	3 ¹¹ / ₁₆	3 ¹¹ / ₁₆
3	2.810	4 ¹ / ₃₂	4 ¹ / ₃₂
4	5.696	5 ¹ / ₄	5 ¹ / ₄

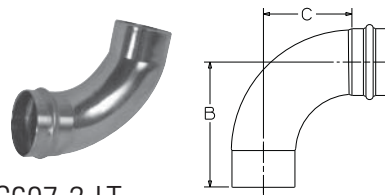

PC607-2-LT
90° Long Radius Elbow
Ftg x P - Wrot

NOM. SIZE	APPROX. NET WT./LBS.	DIM. B INCHES	DIM. C INCHES
2 1/2	2.114	5 ⁷ / ₃₂	3 ¹¹ / ₁₆
3	3.037	5 ³ / ₄	4 ¹ / ₃₂

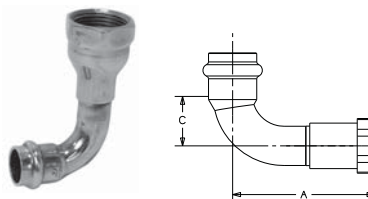

PC607-3
90° Elbow P x F - Wrot

NOM. SIZE	APPROX. NET WT./LBS.	DIM. A INCHES	DIM. C INCHES
1/2 x 3/8	.148	2 ¹ / ₄	2 ⁵ / ₃₂
1/2 x 3/4	.243	2 ²³ / ₃₂	2 ⁵ / ₃₂

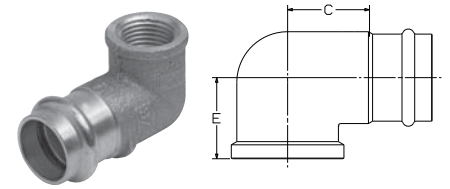

PC707-3
90° Elbow P x F – Cast

NOM. SIZE	APPROX. NET WT./LBS.	DIM. C INCHES	DIM. E INCHES
1/2	.231	1	7/8
3/4	.374	1 ⁵ / ₃₂	1 ¹ / ₁₆
3/4 x 1/2	.318	1 ¹ / ₈	1 ¹ / ₃₂
1	.611	1 ¹³ / ₃₂	1 ¹¹ / ₃₂
1 1/4	.901	1 ¹⁹ / ₃₂	1 ¹⁹ / ₃₂
1 1/2	1.327	1 ¹⁹ / ₃₂	1 ¹¹ / ₁₆
2	1.327	2 ¹ / ₄	2 ⁵ / ₃₂

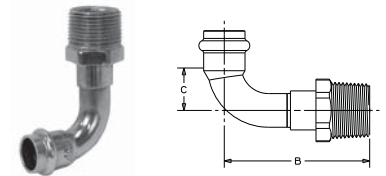

PC607-4
90° Elbow P x M - Wrot

NOM. SIZE	APPROX. NET WT./LBS.	DIM. B INCHES	DIM. C INCHES
1/2 x 3/4	.245	2 ¹¹ / ₁₆	2 ⁵ / ₃₂

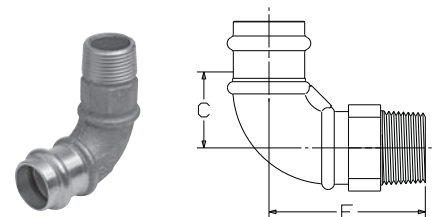

PC707-4
90° Elbow P x M – Cast

NOM. SIZE	APPROX. NET WT./LBS.	DIM. C INCHES	DIM. E INCHES
1/2	.263	1 ¹ / ₈	1 ²³ / ₃₂
3/4	.445	1 ³ / ₃₂	2 ¹¹ / ₃₂
3/4 x 1/2	.445	1 ⁵ / ₁₆	1 ⁷ / ₈
1	.714	1 ¹¹ / ₃₂	2 ¹³ / ₁₆
1 1/4	1.273	1 ¹³ / ₁₆	3 ¹ / ₂
1 1/2	1.273	2 ⁵ / ₃₂	3 ²⁵ / ₃₂
2	3.099	2 ¹¹ / ₁₆	5 ³ / ₃₂

NOTE: Some items not certified by NSF to NSF/ANSI 61. See manufacturer's listing for approved sizes and applications, or contact NIBCO Technical Services for a complete listing of current certifications.