

COUPLINGS (Cont.)

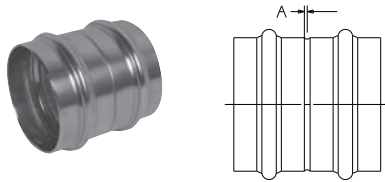

PC600-RS
Coupling P x P – Wrot

NOM. SIZE	APPROX. NET WT./LBS.	DIM. A INCHES
2 1/2	.688	1/16
3	1.028	1/16
4	1.969	1/8

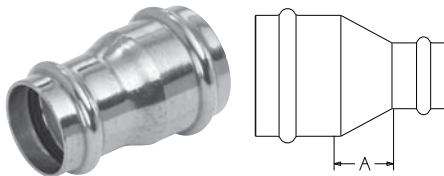

PC600-R
Reducing Coupling P x P – Wrot

NOM. SIZE	APPROX. NET WT./LBS.	DIM. A INCHES
3/4 x 1/2	.115	15/32
1 x 1/2	.154	11/32
1 x 3/4	.165	7/16
1 1/4 x 3/4	.232	17/32
1 1/4 x 1	.218	19/32
1 1/2 x 3/4	.362	3/8
1 1/2 x 1	.227	11/16
1 1/2 x 1 1/4	.388	5/16
2 x 3/4	.508	17/32
2 x 1	.603	1 1/8
2 x 1 1/4	.603	1 3/16
2 x 1 1/2	.603	7/8
2 1/2 x 1	.594	29/32
2 1/2 x 1 1/4	.587	13/16
2 1/2 x 1 1/2	.606	11/16
2 1/2 x 2	.608	9/16
3 x 1 1/2	.938	1 1/32
3 x 2	.940	31/32
3 x 2 1/2	.951	1/2
4 x 2	1.935	1 1/4
4 x 2 1/2	1.807	1
4 x 3	1.960	27/32

COUPLINGS (Cont.)

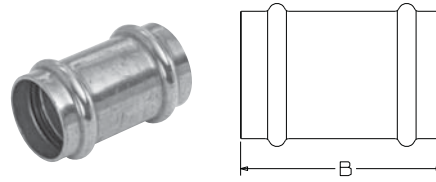

PC601 (No Stop)
Repair Coupling P x P – Wrot

NOM. SIZE	APPROX. NET WT./LBS.	DIM. B INCHES
1/2	.087	1 3/4
3/4	.141	2 1/4
1	.179	2 1/4
1 1/4	.232	2 15/32
1 1/2	.464	3 11/32
2	.637	3 5/8
2 1/2	.669	2 15/16
3	.979	3 5/16
4	1.878	4 5/16

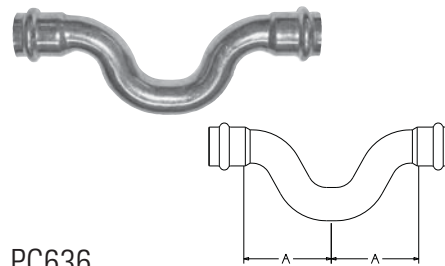

PC636
Crossover Coupling P x P – Wrot

NOM. SIZE	APPROX. NET WT./LBS.	DIM. A INCHES
1/2	.402	1 25/32
3/4	.402	2 9/32

ELBOWS

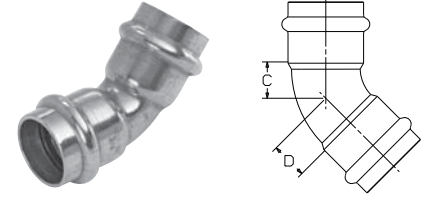

PC606
45° Elbow P x P – Wrot

NOM. SIZE	APPROX. NET WT./LBS.	DIM. C INCHES	DIM. D INCHES
1/2	.089	11/32	11/32
3/4	.169	7/16	7/16
1	.226	9/16	9/16
1 1/4	.312	3/4	3/4
1 1/2	.566	7/8	7/8
2	.842	1 3/32	1 3/32
2 1/2	1.041	29/32	29/32
3	1.536	1 1/8	1 1/8
4	3.226	1 11/16	1 11/16

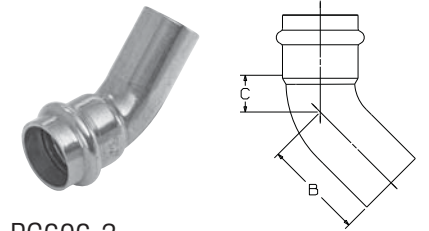

PC606-2
45° Elbow Ftg x P – Wrot

NOM. SIZE	APPROX. NET WT./LBS.	DIM. B INCHES	DIM. C INCHES
1/2	.087	1 11/32	1 1/32
3/4	.155	1 7/16	7/16
1	.214	1 19/32	9/16
1 1/4	.295	1 27/32	1 1/16
1 1/2	.551	2 3/8	7/8
2	.551	2 5/8	1 3/32
2 1/2	1.050	2 3/16	29/32
3	1.526	2 19/32	1 5/32
4	3.284	3 3/32	1 1/2

NOTE: Some items not certified by NSF to NSF/ANSI 61. See manufacturer's listing for approved sizes and applications, or contact NIBCO Technical Services for a complete listing of current certifications.