

Cylinder Valves

1900 Series Cylinder Valves



1935L64Y

This durable line of angle pattern valves features a low profile shrouded handle which protects the valve against damage. Dyna-Pak TFE wafer packing provides a leak tight seal with low operating torque even at 6000 psi (414 bar) pressure.

Features

- 316SS or Monel construction
- Low profile aluminum shrouded stem handle protects stem against damage
- Dyna-Pak packing provides leak tight seal with low operating torque
- Packing below the stem threads prevents process fluid from contacting stem threads
- Non-rotating hardened 17-4PH stainless steel or replaceable PCTFE stem tip prevents galling and extends valve life
- Hardened 450 stainless steel combination packing nut and thread gland for long stem thread cycle life
- Integral stem backseat provides added safety and prevents accidental removal of stem
- Variety of end connections satisfy most cylinder valve applications
- Bonnet lock prevents accidental removal of threaded bonnet
- Angle flow pattern
- Lock-nut secures packing nut against accidental removal
- Flat wrench pads on body for easy valve installation
- Integral stem backstop for added safety

Technical Data	
MAXIMUM OPERATING PRESSURE	6000 psig (414 bar)
OPERATING TEMPERATURE RANGE	-65° F to +450° F [-54° C to +232° C] (metal stem tip) -20° F to +250° F [-29° C to +121° C] (PCTFE stem tip)
ORIFICE	Metal Stem Tip - 0.156 PCTFE Stem Tip - 0.187
CV FACTOR	Metal Stem Tip - 0.42 PCTFE Stem Tip - 0.63

Materials of Construction		
DESCRIPTION	316SS VALVES	MONEL VALVES
Body	316SS	Monel®
Stem	316SS	Monel®
Stem Tip	Soft	PCTFE
	Hard	17-4 PHSS Monel®
Packing (Dyna-Pak)	TFE/316SS Wafers	TFE/Monel® Wafers
Handle	Aluminum	Aluminum

Handle Turns vs Cv

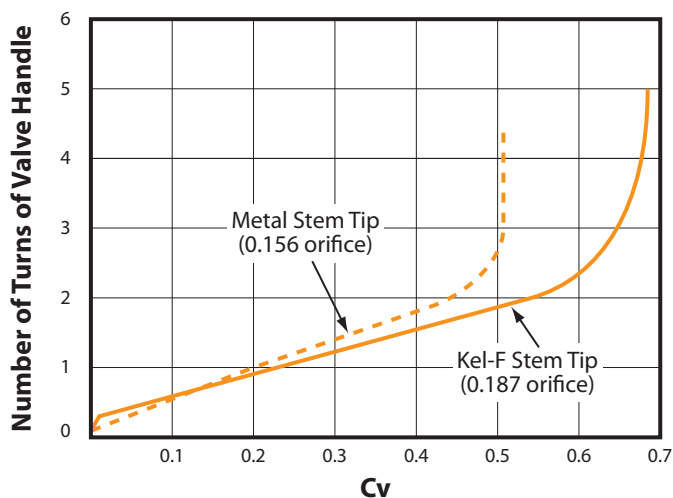

Pressure Temperature Curve

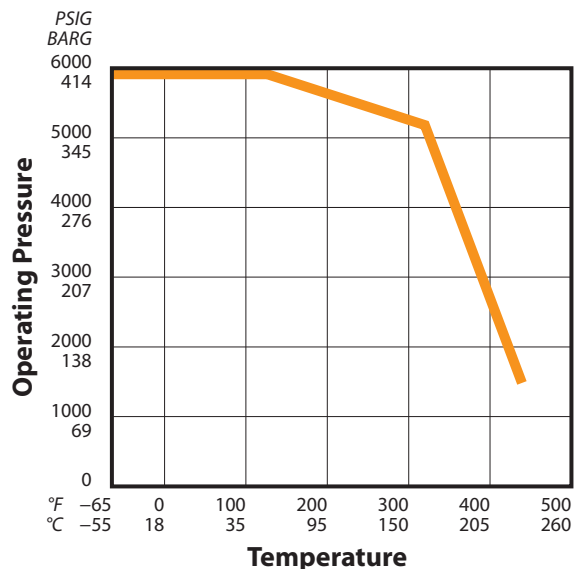

Cylinder Valves

1900 Series Cylinder Valves

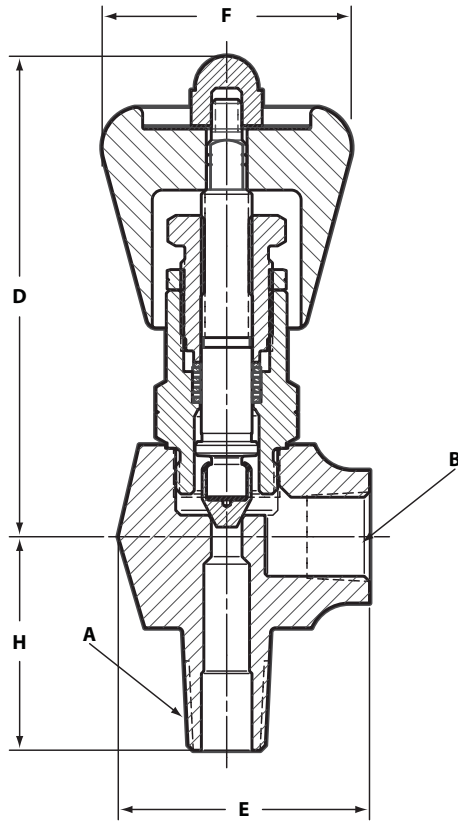

1925L[Y]

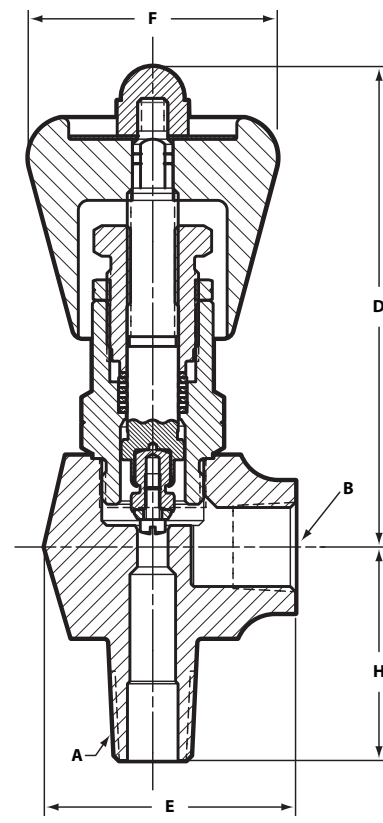

1965L[]

Dimensions & How to Order 1900 Series Angle Pattern Valves								
BASIC MATERIAL	STEM TIP	END CONNECTIONS		ORDERING NUMBER	DIMENSIONS, IN. [MM]			
		INLET A	OUTLET B		D	E	F	H
316 SS	Metal	¼ NPT Male	¼ NPT Female	1925L4Y	3 ³ / ₁₆ [81]	1½ [38]	1¾ [44]	1 ⁵ / ₁₆ [33]
	PCTFE	¼ NPT Male	¼ NPT Female	1965L4Y	3 ³ / ₁₆ [81]	1½ [38]	1¾ [44]	1 ⁵ / ₁₆ [33]
	Metal	⅜ NGT Male*	¼ NPT Female	1925L64Y	3 ³ / ₁₆ [81]	1½ [38]	1¾ [44]	1 ³ / ₈ [35]
	PCTFE	⅜ NGT Male*	¼ NPT Female	1965L64Y	3 ³ / ₁₆ [81]	1½ [38]	1¾ [44]	1 ³ / ₈ [35]
Monel	PCTFE	¼ NPT Male	¼ NPT Female	1965L4M	3 ³ / ₁₆ [81]	1½ [38]	1¾ [44]	1 ⁵ / ₁₆ [33]

* NGT Male Ended Valves: Screw thread standard per Federal Services Handbook H-28, section 9. These threads allow longer thread engagement into the cylinder.

Dimensions are for reference only and are subject to change