

Class 250 Iron Body Automatic Stop Check Valves

Bolted Bonnet • Angle Pattern • Renewable Seat and Disc* • Bronze Mounted

250 PSI/17.2 Bar Saturated Steam to 406° F/207° C
500 PSI/34.5 Bar Non-Shock Cold Working Pressure
to -20° F to 150° F/-29° C to 66° C◆

CONFORMS TO MSS SP-85

MATERIAL LIST

PART	SPECIFICATION
1. Handwheel Nut	Steel ASTM A 307
2. Identification Plate	Aluminum
3. Handwheel	Cast Iron ASTM A 126 Class B
4. Stem	Brass ASTM B 16 Alloy C36000
5. Yoke Bushing	Cast Bronze ASTM B 584 Alloy C84400
6. Bonnet	Cast Iron ASTM A 126 Class B
7. Gland Follower Stud	Steel ASTM A 307 (not shown)
8. Gland Follower Nut	Brass ASTM F 467 Alloy C27000 (not shown)
9. Gland Follower	Ductile Iron ASTM A 536
10. Packing Gland	Zinc Plated Powdered Iron ASTM B 783 or Brass ASTM B 16
11. Packing	TFE Braided
12. 1 Butterfly Handle Nut	Steel ASTM A 307
13. 1 Butterfly Handle	Cast bronze ASTM B 584 Alloy C84400
14. 1 Control Valve Stem	Bronze ASTM B 371 Alloy C69400
15. 1 Control Valve Pack Nut	Cast Bronze ASTM B 584 Alloy C84400
16. 1 Control Valve Pack Gland	Brass ASTM B 16 Alloy C36000
17. 1 Control Valve Packing	Synthetic Fibers with Graphite
18. 1 Control Valve Body	Cast Bronze ASTM B 584 Alloy C84400
19. Hex Head Cap Screw	Steel ASTM A 307
20. Body Gasket	Reinforced Graphite
21. 1 Dashpot Gasket	Reinforced Graphite
22. 1 Dashpot	Cast Bronze ASTM B 584 Alloy C84400
23. 1 Piston-Disc	Cast Iron ASTM A 126 Class B
24. 1 Piston Ring (2)	TFE Composite Material
25. 1 Disc Face Ring	Cast Bronze ASTM B 584 Alloy C84400
26. 1 Seat Ring	Cast Bronze ASTM B 584 Alloy C84400
27. Body	Cast Iron ASTM A 126 Class B
28. 2 Piston Ring Collar	Brass ASTM B 16 Alloy C36000
29. 2 Disc Cage	Bronze ASTM B 62 Alloy C83600
30. 2 Teflon Disc	TFE
31. 2 Disc Plate and Nut	Bronze ASTM B 62 Alloy C83600
32. 2 Piston Rod Plug	Brass ASTM B 16 Alloy C36000
33. 2 Piston Rod Plug Pin	Red Bronze ASTM B 140 Alloy C31400

¹ 4" thru 8" size only. (4" thru 8" have Cast Iron Disc with Bronze Disc Face Ring.)

² 2½" and 3" size only. (2½" and 3" have Teflon Disc Ring (-Y series).)

DIMENSIONS—WEIGHTS—QUANTITIES

Size	Dimensions										Weight		
	In.	mm.	A	B	C	D	E	In.	mm.	Lbs.	Kg.		
2½	65	5.75	146	12.63	321	8	203	7.50	191	1.00	25	80	36
3	80	6.25	159	14.00	356	10	254	8.25	210	1.13	29	102	46
4	100	7.00	178	16.50	419	10	254	10.00	254	1.25	32	168	76
6	150	8.75	222	20.75	527	14	356	12.50	318	1.44	37	311	141
8	200	10.50	267	23.81	605	16	406	15.00	381	1.63	41	520	236

* With proper machining facilities available.
Valve must be installed vertically.



F-869-B
Flanged
Series D

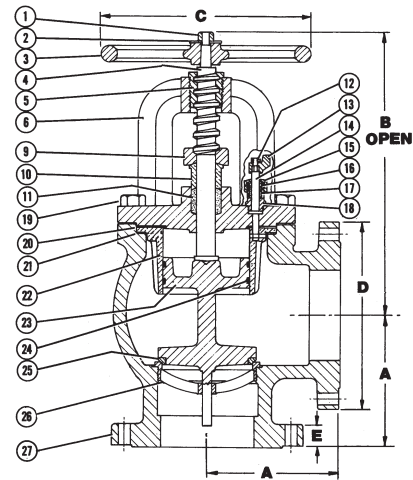

F-869-B
Flg x Flg

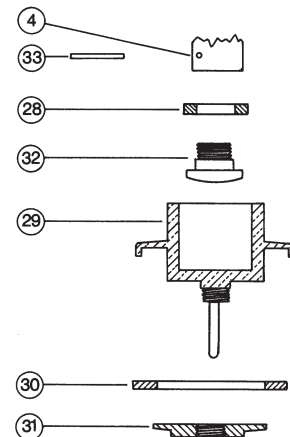

Freezing Weather Precaution – Subsequent to testing a piping system, valves should be in an open position to allow complete drainage.

◆ For detailed Operating Pressure, refer to Pressure Temperature Chart on page 111.