

FLANGES

Figure 61 Flange Adapter (ANSI Class 125/150)

The Figure 61 Flange Adapter is capable of pressures up to 300 PSI (20,7 bar) depending on copper tubing size and type. It provides a direct transition from flanged components to a grooved copper tube system. I.P.S. size flange bolt patterns conform to ANSI Class 125 and 150. The Figure 61 Flange Adapter is supplied with NSF 61 approved grade EPDM EN Gasket.

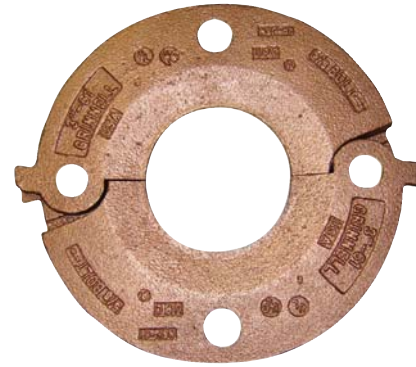
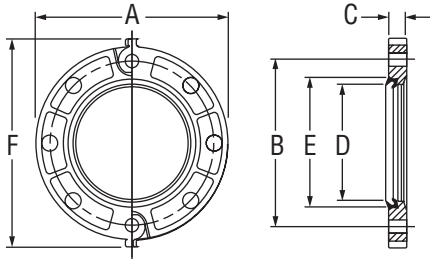

Tech Data: G515

**COPPER
GROOVED
SYSTEM**

Nominal Size Inches mm	Copper Tubing O.D. Inches mm	Nominal Dimensions						Bolts**		Approx. Weight lbs kg
		A Inches mm	B Inches mm	C Inches mm	D* Inches mm	E* Inches mm	F Inches mm	Qty.	Size Inches	
2	2.125	6.38	4.75	0.75	2.13	3.41	7.25	4	5/8 x 3	4.1
50	54,0	162,1	120,7	19,1	54,0	86,6	184,2			1,9
2½	2.625	7.00	5.50	0.88	2.63	3.91	7.88	4	5/8 x 3	5.7
65	66,7	178,0	140,0	22,0	67,0	99,0	200,0			2,6
3	3.125	7.50	6.00	0.94	3.13	4.53	9.88	4	5/8 x 3	6.7
80	79,4	190,5	152,4	23,9	80,0	115,1	251,0			3,0
4	4.125	9.00	7.50	0.94	4.13	5.53	9.90	8	5/8 x 3	8.5
100	104,8	228,6	190,5	23,9	105,0	140,5	251,5			3,9
5	5.125	10.00	8.50	1.00	5.13	6.72	11.38	8	¾ x 3½	10.3
125	130,2	254,0	215,9	25,4	130,0	170,7	289,1			4,7
6	6.125	11.00	9.50	1.00	6.13	7.78	11.88	8	¾ x 3½	11.5
150	155,6	279,4	241,3	25,4	156,0	197,6	301,8			5,2

* Dimensions D and E represent minimum and maximum sealing surfaces.

** Bolts are not supplied. Bolt lengths shown are standard; it is the responsibility of the purchaser to verify correct length for the intended application.

Note: Phenolic Type "F" flange washer adapters are required when the Figure 61 Flange Adapter is used against surfaces such as:

- Rubber surfaces
- Adapting to AWWA cast flanges
- Rubber faced wafer valves
- Serrated flange surfaces

Figure 61 Flange Adapters are not recommended for applications that incorporate tie rods for anchoring or on a standard fitting within 90° of each other.

Please refer to General Notes on page 17.