

Fig. 422 - Light Weight Pipe Alignment Guide

Size Range — 3/4" thru 8" pipe size

Material and Finish — Carbon Steel, black and galvanized.

Function — For maintaining alignment of piping through its axial expansion and contraction cycles.

Order By — Figure number, pipe size and insulation thickness.

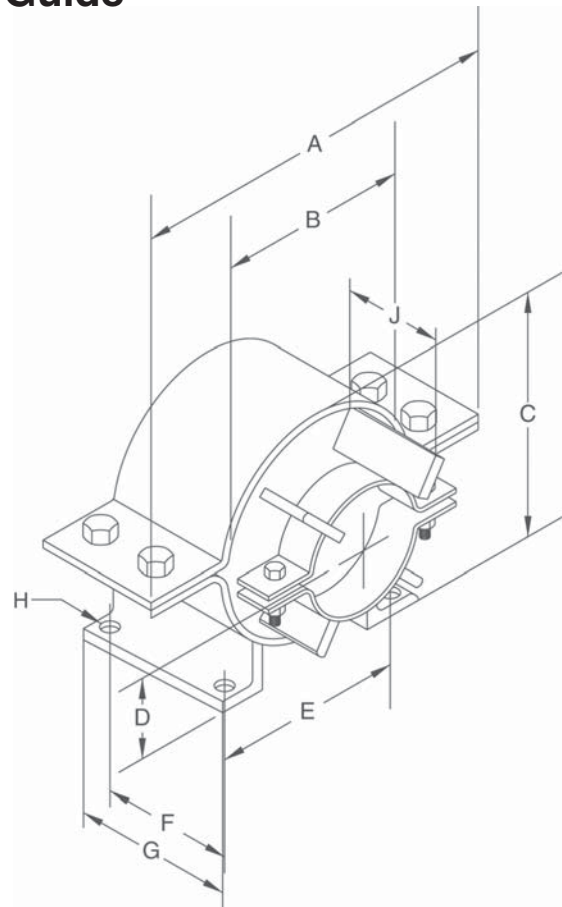

Dimensions • Weights

Pipe Size	A	B	C	D	E	F	G	Hole Size H	Max. Insul. Thickness	Approx. Wt./100
3/4	6 ⁵ / ₈	4 ³ / ₈	5 ⁵ / ₁₆	3 ¹ / ₈	5	1 ¹ / ₂	3	5/8	1 ⁵ / ₈	400
1	8 ¹ / ₂	6 ¹ / ₄	5 ⁵ / ₈	3 ¹ / ₂	6 ¹ / ₄	1 ¹ / ₂	3	5/8	1 ⁵ / ₈	400
1 ¹ / ₄	8 ¹ / ₂	6 ¹ / ₄	5 ⁵ / ₈	3 ¹ / ₂	6 ¹ / ₄	1 ¹ / ₂	3	5/8	1 ⁵ / ₈	630
1 ¹ / ₂	8 ¹ / ₂	6 ¹ / ₄	5 ⁵ / ₈	3 ¹ / ₂	6 ¹ / ₄	1 ¹ / ₂	3	5/8	1 ⁵ / ₈	630
2	8 ¹ / ₂	6 ¹ / ₄	5 ⁵ / ₈	3 ¹ / ₂	6 ¹ / ₄	1 ¹ / ₂	3	5/8	1 ⁵ / ₈	630
2 ¹ / ₂	9 ¹ / ₂	7 ¹ / ₄	7 ⁵ / ₈	4	6 ³ / ₄	1 ¹ / ₂	3	5/8	2 ¹ / ₈	760
3	11 ³ / ₄	9 ¹ / ₂	9 ³ / ₄	5	7 ³ / ₈	1 ¹ / ₂	3	5/8	2 ¹ / ₈	1260
3 ¹ / ₂	11 ³ / ₄	9 ¹ / ₂	9 ³ / ₄	5	7 ³ / ₈	1 ¹ / ₂	3	5/8	2 ¹ / ₈	1260
4	11 ³ / ₄	9 ¹ / ₂	9 ³ / ₄	5	7 ³ / ₈	1 ¹ / ₂	3	5/8	2 ¹ / ₈	1260
5	13 ⁵ / ₈	10 ⁵ / ₈	11 ⁹ / ₁₆	6 ¹ / ₄	7 ³ / ₈	2	4	5/8	2 ¹ / ₈	1260
6	15 ⁵ / ₈	12 ⁵ / ₈	13 ⁹ / ₁₆	7 ¹ / ₄	8	2	4	5/8	2 ⁵ / ₈	1920
8	18 ¹ / ₄	15 ¹ / ₄	16 ¹ / ₈	8 ¹ / ₂	9 ³ / ₄	2	4	3/4	2 ⁵ / ₈	2860

Size	J	Max. Movement
1" - 4"	4	4
5" - 8"	6	6