

The SVF Series BWEV is a full ported, two-piece, seal-welded ball valve designed for use in Railroad Tank Car applications. The BWEV is an economical, manually operated valve that meets industry requirements for performance and dependability.

**Features**

**1/4 - 3"**

- ▲ AAR# E979020
- ▲ Two-piece, seal-welded body maintains valve integrity in the most demanding applications
- ▲ 316 Stainless Steel body, ball and stem
- ▲ Full port opening
- ▲ Designed to ANSI B16.34 and BS 5351
- ▲ Threaded end connector
- ▲ Vinyl grip handle
- ▲ Light weight and economical
- ▲ Blowout-proof stem



**AAR# E979020**

**Materials**

Item	Description	Material
1	Body	ASTM A351 GR, CF8M
2	Body Connector	ASTM A351 GR, CF8M
3	Ball	AISI 316
4	Stem	AISI 316
5	Seat	RTFE
6	Body Connector Seal	PTFE

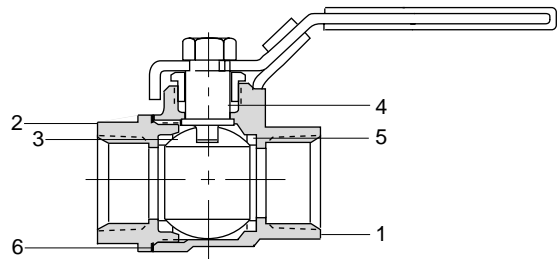

*Shown with optional locking device.*

**Dimensions & Weights (ins., lbs)**

Size	A	B	C	D	Wt.
1/4"	2.40	4.25	2.00	0.45	0.75
3/8"	2.45	4.25	2.00	0.50	0.75
1/2"	2.45	4.50	2.10	0.59	0.75
3/4"	3.00	5.00	2.20	0.78	1.75
1"	3.60	6.50	2.70	1.00	2.33
1 1/4"	4.00	6.75	3.00	1.26	3.75
1 1/2"	4.65	7.60	3.30	1.50	5.00
2"	5.45	7.60	3.80	2.00	8.75
2 1/2"	6.50	9.80	5.40	2.55	15.65
3"	7.60	9.80	5.80	3.15	26.00

