

Zirconia Ceramic Lined Ball Valves

ABOUT US

CATALOGS

DISTRIBUTORS

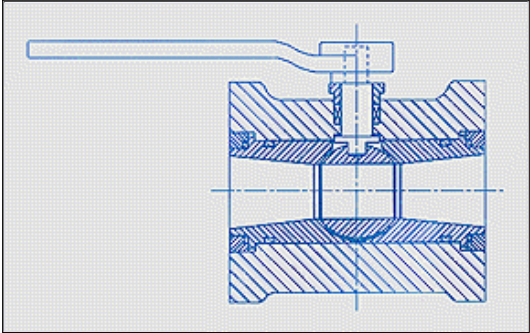

Size Range: 1" - 6"

Body: Graphite reinforced vinyl ester

Ball: Zirconia Ceramic

Seat Inserts: Zirconia Ceramic

Nil-Cor has combined two advanced materials technologies: graphite fiber reinforced vinyl ester resin and tough new zirconia ceramic to produce the best performing and lowest cost valve for corrosive/erosive fluids. Available in sizes 1" through 6". Manual, automated on/off or precision factory assembled modulating control valves are available. Nil-Cor is the smart choice for your toughest erosive applications.

Typical Applications

Ferric chloride crystals	Lime mud	Pulverized coal & carbon
Fly ash	Limestone/FGD	Titanium dioxide
Green or white liquor	Magnesium hydroxide	Trona
Sludge	Metal oxide sludge	Salt
Gypsum	Potash	Silica
Kaolin	Pulp	Sulfite crystals