



## Safe Ball® Lockwing Gas Service Bypass Valve



ISO EN 9001:2000



**125 LWBP**  
**1" FxF Bypass**



**175 LWIBP**  
**3/4" Insulated Bypass**



**125 LWUBP**  
**1" Union End Bypass**

### Description

The 125/175 LWBP Safe Ball® Lock-Wing bypass valve utilizes Jomar's proven hot forged brass, 100% full-port, maintenance free ball valve design, with a patented ( U.S.A. Patent No. 6,648,009) security shutter and unique lockwing tab. The by-pass allows periodic meter maintenance or change-out to be performed without interruption of service to the customer.

### Model

175LWIBP	3/4"	Insulated Bypass
125LWBP	1"	Female x Female Bypass
125LWUBP	1"	Union End Bypass Non-Insulated

### Specifications

Service Designation 125 and 175 PSIG. Temperature Range -40°F to 366°F. 100% Leak tested 1.5 times service designation.

- 100% full port
- Hostafon®-TFM 1600 seats
- Tamper resistant lockwing cap
- Double Viton® Stem O-rings
- 100% leak tested
- Applicable parts meet or exceed DOT 192 and ANSI B16.33
- Threads conform to ANSI B 1.20.1
- Gas port is 1/4" NPT

### Warranty

The Company, for a period of one year from the date of shipment, warrants each product or system of its own manufacture to the original purchaser to be free from defects in material and workmanship under normal use, service and maintenance.

Note: Information subject to change without notice.



Jomar International Ltd.  
7243 Miller Drive  
Warren, MI 48092  
Phone: 800-325-5690  
Fax: 800-628-4194  
www.jomar.com

© Copyright 2006 Printed in U.S.A.  
125/175 By Pass  
0406

# 125/175 LWBP

## Safe Ball® Lockwing Gas Service Bypass Valve



### Description

The 125/175 LWBP Safe Ball® Lock-Wing Bypass valve utilizes Jomar's proven hot forged brass, full-port, maintenance free ball valve design, with a patented ( U.S.A. Patent No. 6,648,009) security shutter and unique locking wing tab. The by-pass allows periodic meter maintenance or change-out to be performed without interruption of service to the customer.

- Safe - access to gas port is protected by extra tab on Lockwing cap (plug cannot be removed when valve is in normal full open position).
- Simple - security shutter stops flow to gas port when closed, allowing safe removal of gas port plug.
- Economical - saves time and money when performing periodic metering change-outs.

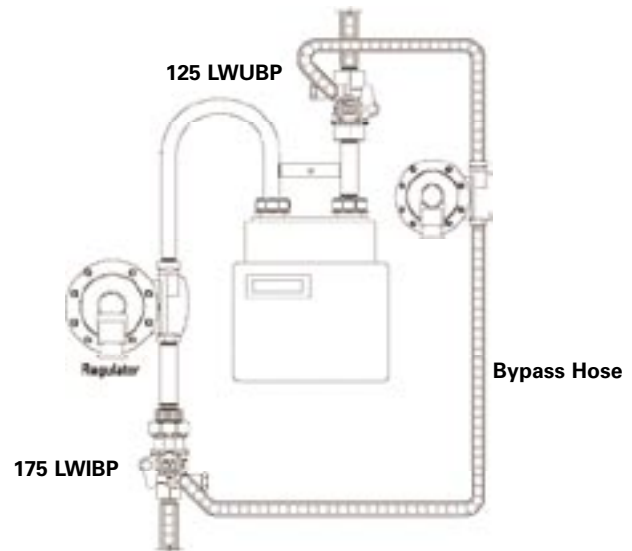

### Dimensions in Inches

Computer Valve Number	Valve Size	A	B	C	D	E	F
<b>Insulated Bypass</b>							
243-004	3/4"	4.94	2.09	.95	.95	.59	1.87
<b>Female x Female Bypass</b>							
244-005	1"	3.64	2.09	.95	.95	.59	2.24
<b>Union End Bypass Non-Insulated</b>							
244-105	1"	4.63	2.09	.95	.95	.59	2.24

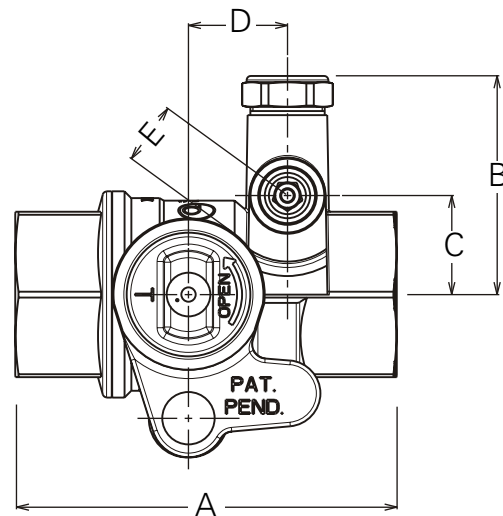
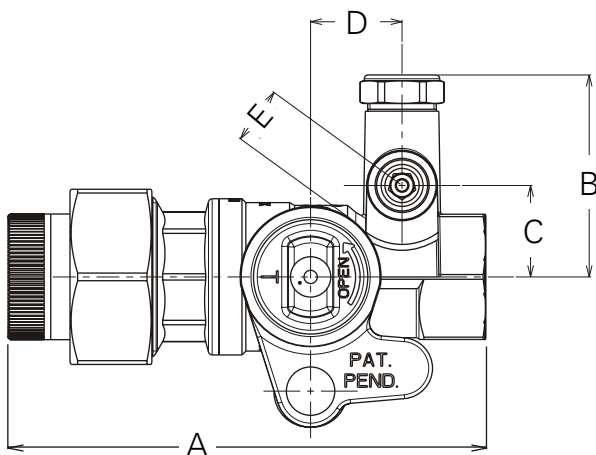

Note: Information subject to change without notice.



Jomar International Ltd.  
7243 Miller Drive  
Warren, MI 48092  
Phone: 800-325-5690  
Fax: 800-628-4194  
www.jomar.com

© Copyright 2006 Printed in U.S.A.  
125/175 By Pass  
0406