

Penn Machine

Class 2000 Threaded 90°

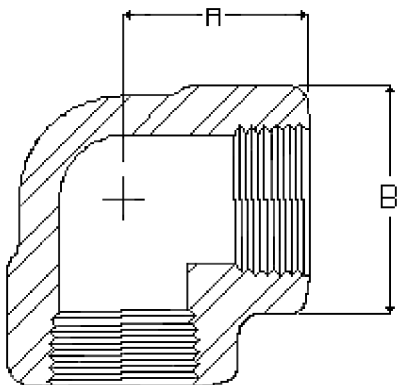

PENN CATALOG F2002 FIG NO. 02001
ASME-B16.11-2001

[Click here for the reducing fitting correct ordering practice](#)

Nominal Pipe Size	1/8"	1/4"	3/8"	1/2"	3/4"	1"	1-1/4"	1-1/2"	2"	2-1/2"	3"	4"
Dimension A	7/8	7/8	31/32	1-1/8	1-5/16	1-1/2	1-3/4	2	2-3/8	3	3-3/8	4-3/16
Dimension B	7/8	7/8	1-1/16	1-5/16	1-1/2	1-13/16	2-3/16	2-1/2	3	3-5/8	4-5/16	5-7/8
Approx. Wt. (lbs)	.20	.18	.25	.51	.73	1.07	1.63	2.31	3.61	7.60	11.93	24.05

Penn Machine

Class 2000 Threaded Tee

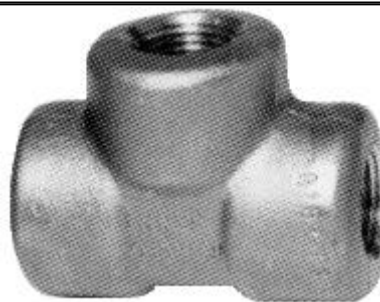
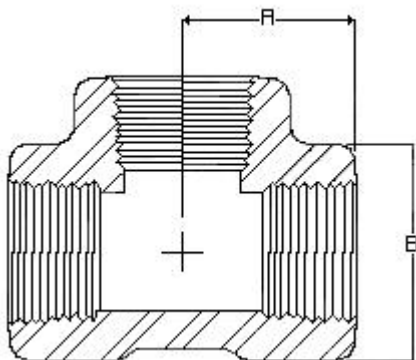

PENN CATALOG F2002 FIG NO. 02002
ASME-B16.11-2001

[Click here for the reducing fitting correct ordering practice](#)

Nominal Pipe size	1/8"	1/4"	3/8"	1/2"	3/4"	1"	1-1/4"	1-1/2"	2"	2-1/2"	3"	4"
Dimension A	7/8	7/8	31/32	1-1/8	1-5/16	1-1/2	1-3/4	2	2-3/8	3	3-3/8	4-3/16
Dimension B	7/8	7/8	1-1/16	1-5/16	1-1/2	1-13/16	2-3/16	2-1/2	3	3-5/8	4-5/16	5-7/8
Approx. Wt. (lbs)	.31	.24	.37	.67	.91	1.38	1.96	3.10	4.98	9.31	13.32	28.02

[Fitting catalog](#) | [Product catalog](#) | [Request quote/information](#) | [Home](#)

Web site created by Penn Machine. Send questions or comments to [James Friant](#).