



Moniteur's new Scout VPT series provides cost effective low profile position sensing for actuators utilizing NAMUR accessory mounting. These advanced sensors are available in both PNP and NAMUR output versions for compatibility with today's modern plant control systems.

Principle of Operation

- * Simple in concept, the Scout VPT is easy and quick to assemble. The Position Transmitter "puck" mounts directly to the NAMUR accessory output shaft of your actuator. The double sensor block mounts to the accessory holes of the actuator. There is no adjustment or calibration required once the VPT has been installed.
- * All Scout VPTs use Inductive Sensors. Inductive sensors are "solid state" (without moving parts) and are the most reliable of sensing methods, with a MTBF over 20 million cycles. Inductive Sensors have three parts of operation - the oscillator, triggering circuit and switching amplifier. The oscillator generates a high-frequency electromagnetic field in the sensor's target area. When a ferrous metal target enters the electromagnetic field (target area), eddy currents created in the target by the oscillator increase the load on the oscillator. At a specific load, the trigger circuit senses the reduction in oscillation and signals the switching amplifier to change the signal. Inductive Sensors consume electric power to operate, and must have approvals to be used in hazardous areas (see table below).
- * NAMUR inductive sensors operate without the amplifier circuitry in the sensor, allowing use in all hazardous areas, provided the required signal amplifier is installed externally in the safe area.

Applications

- * Compact valve position indication for applications where minimal space is available.
- * Intrinsically Safe. NAMUR Inductive Sensors are rated Intrinsically Safe and must be used with an approved current and voltage limiting barrier.
- * To locally ascertain valve position, the SCOUT Sensors include lights in the housing.

Mounting

- * The position indicator kit includes the target puck and all mounting hardware for NAMUR standard actuators. See diagram at right.

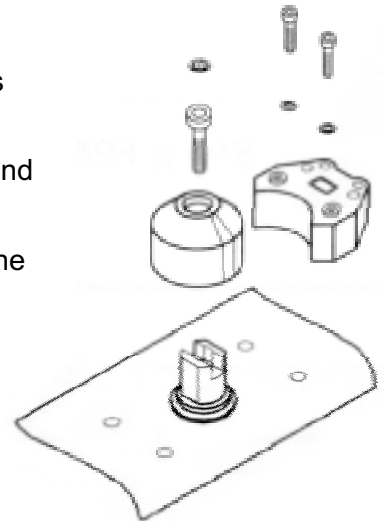

Specifications - SCOUT Inductive Sensors

Sensor	Operation	Supply Voltage	Load Current / Target Absent	Load Current / Target Present	FM Approval
VFNN-0K20	PNP	5-60 VDC	< 0.7 mA	4-100 mA	-
VFNN-0820	NAMUR	5-25 VDC	< 1 mA	3 - 15 mA	Intrinsically Safe**

Intelligent Part Number System

V	F	N	N	-	0	K	2	0	-	1
Series	Cover	Moniteur	Bearing		Shaft	Switch	Quantity	Conduit		Mounting

Base unit includes:	Double Sensor Module SS Mounting Hardware	Target Puck For 80 x 30 x 20 Actuator Male "Micro" Connector
----------------------------	--	---

Description	Code
Series: Scout	V
Cover Flat Cover	F
Moniteur No Indicator	N
Bearing No Bearing	N
Shaft No Shaft	N

Description	Code
Switch Type (2 switches) PNP Inductive NAMUR Inductive	K 8
Switch Quantity	2
Conduit DIN Micro (Male)	0
Mounting 80 x 30 x 20 80 x 30 x 30 130 x 30 x 30 130 x 30 x 50	1 2 3 4
See Moniteur Scout Mounting Selection Guide	

Dimensions

