

Moniteur

SCOUT Compact VPT

Compact Valve Position Monitoring and Built-in Solenoid Integration with EASYConnect



The SCOUT Valve Position Transmitter's approach to low profile position sensing is a millenium-sized advance for the NAMUR actuator market. Available in many output versions, incorporating the SCOUT VPT in your plant advances your automated valves into the forefront of control technology!



Features

Solid State Inductive Sensors standard on all SCOUT VPTs offer a virtually unlimited cycle life.

Available in many circuit configurations - Choose from AC, DC PNP, DC 2-wire and NAMUR for direct integration into your plant's process control system.

Fully Enclosed Sensor Electronics with no exposed resins make the Scout the ideal choice for corrosive, humid or washdown environments.

Moniteur's optional EASYConnect solenoid mounting allows solenoid power to be routed through the sensor block, making additional junction housings unnecessary.

Indicator LEDs located on the sensor block clearly verify network, sensor and solenoid operation, and valve position locally.

Simple Installation - The Position Transmitter target mounts directly to the NAMUR output shaft of your actuator, while the sensor block mounts to the holes. No adjustment or calibration is required once the VPT has been installed.

A Full line of complementary cables and connectors take the guesswork out of selecting the right accessories for your Scout.

Mounting

The position indicator kit includes the target puck and all mounting hardware for actuators with NAMUR accessory mounting. See exploded diagram at right.

Scout VPTs with EASYConnect include 18" flying leads and an optional DIN solenoid connector to complete your automated valve package.

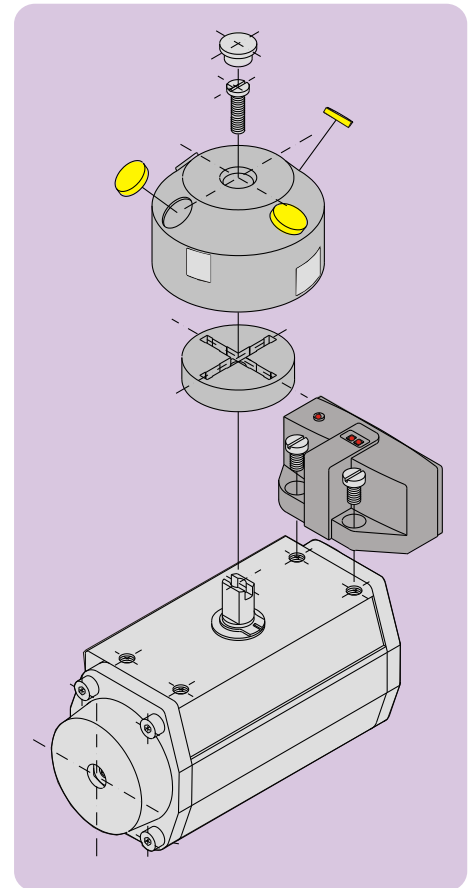

Quick Selection Guide

Type	Part No.	Type	Part No.
AC/DC - 2 wire / Standard	SC-1CN	DC - 2 wire / Standard	SC-4CN
AC/DC - 2 wire / EASYConnect	SC-1CE	DC - 2 wire / EASYConnect	SC-4CE
DC PNP/ Standard	SC-3CN	NAMUR/ Standard	SC-5CN
DC PNP/ EASYConnect	SC-3CE	NAMUR/ EASYConnect.	SC-5CE

Remember to add the suffix denoting the desired NAMUR mounting pattern.

Intelligent Part Number System



Base unit includes: Double Sensor Module Target For 80 x 30 Actuator
SS Mounting Hardware Male Connector According to Sensor Type

Description	Code
Series: Scout	SC
Sensor Block	
AC/DC - 2 wire	1
AC - 2 wire	2
DC - PNP	3
DC - 2 wire	4
NAMUR	5

Description	Code
EASY IN:	
With Male Connector	C
With B7 Male Connector	B
Without Connector (72 in. Flying Leads)	N
EASY OUT:	
Without EASYConnect	N
With EASYConnect (18 in. Flying Leads For Solenoid)	E

Description	Code
Target	
80 x 30	1
130 x 30	2
See Moniteur Scout Mounting Selection Guide	

Dimensions (mm)

Sensor Block

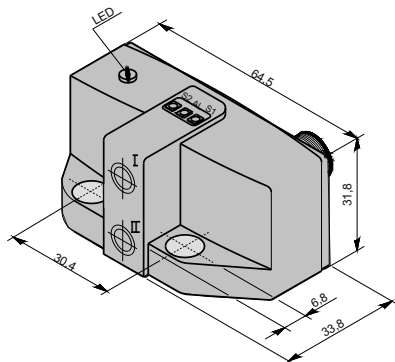

Target For 80 x 30 mm

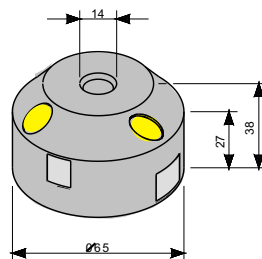

Target For 130 x 30 mm

