

SOCKET WELD FITTINGS HALF COUPLING

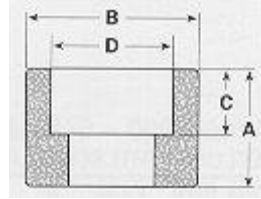

Class 3000

Pipe Size	1/81	1/42	3/81	1/21	3/41	1	1 1/4	1 1/2	2	2 1/2	3	4
Dimension A	1 1/32	1 1/32	1 1/32	1 9/32	1 15/32	1 5/8	1 11/16	1 3/4	2 1/4	2 15/16	2 3/8	2 5/8
Dimension B	3/4	1	1 1/16	1 1/4	1 1/2	1 7/8	2 1/4	2 1/2	3	3 5/8	4 5/16	5 15/32
Dimension C	3/8	3/8	3/8	3/8	1/2	1/2	1/2	1/2	5/8	5/8	5/8	3/4
Dimension D	.420	.555	.690	.855	1.065	1.330	1.675	1.915	2.406	2.906	3.535	4.545
Approx. Wt. #	.10	.17	.19	.30	.45	.78	1.05	1.26	2.11	3.27	4.26	7.06

Class 6000

Pipe Size	1/81	1/42	3/81	1/21	3/41	1	1 1/4	1 1/2	2	2 1/2	3	4
Dimension A	1 1/32	1 1/32	1 1/32	1 9/32	1 15/32	1 5/8	1 11/16	1 3/4	2 1/4	2 15/16	2 3/8	2 5/8
Dimension B	7/8	1	1 1/8	1 3/8	1 11/16	2	2 1/2	2 3/4	3 5/8	4 1/4	5	6
Dimension C	3/8	3/8	3/8	3/8	1/2	1/2	1/2	1/2	5/8	5/8	5/8	3/4
Dimension D	.420	.555	.690	.855	1.065	1.330	1.675	1.915	2.406	2.906	3.535	4.545
Approx. Wt. #	.15	.18	.24	.42	.71	1.06	1.65	2.01	4.67	6.27	8.57	12.38

Class 9000

Pipe Size	1/81	1/42	3/81	1/21	3/41	1	1 1/4	1 1/2	2	2 1/2	3	4
Dimension A	---	---	---	1 9/32	1 15/32	1 5/8	1 11/16	1 3/4	2 1/4	---	---	---
Dimension B	---	---	---	1 11/16	2	2 1/2	2 3/4	3	3 5/8	---	---	---
Dimension C	---	---	---	3/8	1/2	1/2	1/2	1/2	5/8	---	---	---
Dimension D	---	---	---	.855	1.065	1.330	1.675	1.915	2.406	---	---	---
Approx. Wt. #	---	---	---	.74	1.14	1.99	2.34	2.76	4.85	---	---	---

[Back to Capitol's Table of Contents](#)