

Butterfly Lever



10-Position, Lockable Lever Handle

Description

Ten-position locking lever handles fit Jomar 600 series (Lug) and 900 series (Wafer) butterfly valves. Available in sizes 2" - 12".

Dimensions in Inches

Computer No.	Size	A	B	C	Weight
BLH2-3	2"-3"	10.64	1.26	2.05	2.00
BLH4	4"	10.64	1.26	2.05	2.00
BLH5-6	5" - 6"	10.64	1.26	2.05	2.00
BLH8	8"	14.18	1.77	2.96	4.30
BLH10-12	10" - 12"	19.70	1.77	2.96	5.84

Lever Handle



Warranty

The Company, for a period of one year from the date of shipment, warrants each product or system of its own manufacture to the original purchaser to be free from defects in material and workmanship under normal use, service and maintenance.

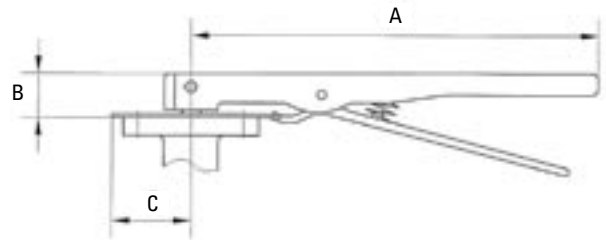

Architect/Engineer approval

Job Name _____ Date _____
Model Specified _____ Quantity _____
Variations Specified _____
Customer/Wholesaler _____
Contractor _____
Architect _____

Note: Information subject to change without notice.



Jomar International Ltd.
7243 Miller Drive
Warren, MI 48092
Phone: 800-325-5690
Fax: 800-628-4194
www.jomar.com

© Copyright 2006 Printed in U.S.A.
Lever Handle
04/06

Butterfly Gear Operator



Worm Gear Actuator

Description

Jomar worm gear actuators are designed to directly mount to Jomar 600 series (Lug) and 900 series (Wafer) butterfly valves. Allows easy operation during high line pressures.

Dimensions in Inches

Computer No.	Valve Size	A	B	C	D	E	F	G	Weight
BG02-3	2"-3"	2.05	1.77	2.92	5.91	2.05	6.00	2.96	11.50
BG04	4"	2.05	1.77	2.92	5.91	2.05	6.00	2.96	11.50
BG05-6	5"-6"	2.05	1.77	2.92	5.91	2.05	6.00	2.96	11.50
BG08	8"	2.96	2.47	3.98	11.82	2.96	9.85	3.39	28.66
BG010	10"	2.96	2.47	3.98	11.82	2.96	9.85	3.39	28.66
BG012-14	12"-14"	3.19	3.15	4.65	11.82	3.19	8.94	3.27	33.00



Gear Operator

Warranty

The Company, for a period of one year from the date of shipment, warrants each product or system of its own manufacture to the original purchaser to be free from defects in material and workmanship under normal use, service and maintenance.

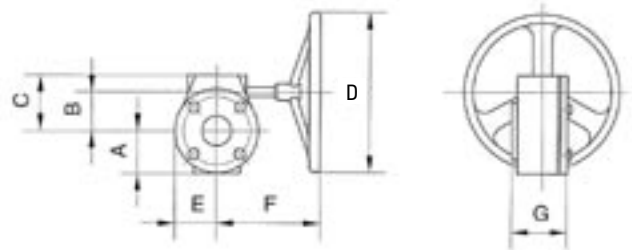

Architect/Engineer approval

Job Name _____ Date _____
 Model Specified _____ Quantity _____
 Variations Specified _____
 Customer/Wholesaler _____
 Contractor _____
 Architect _____

Note: Information subject to change without notice.



Jomar International Ltd.
 7243 Miller Drive
 Warren, MI 48092
 Phone: 800-325-5690
 Fax: 800-628-4194
 www.jomar.com