

Dielectric Unions



Galvanized x Copper

Description

The most effective method for preventing piping system deterioration from accelerated corrosion due to galvanic and stray current is the use of dielectric unions.

Features

- Prevents accelerated corrosion
- Pressure rating: 250 PSI
- -20°F to 180°F - Buna Seats
- -20°F to 220°F - Teflon Seats

Approvals

- Meets ANSI B16.39.
- IPS ANSI B1.20.1
- Solder end ANSI B16.18

Warranty

The Company, for a period of one year from the date of shipment, warrants each product or system of its own manufacture to the original purchaser to be free from defects in material and workmanship under normal use, service and maintenance.

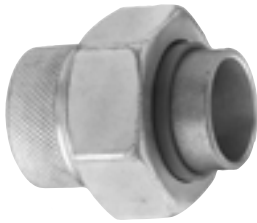

FIP x Solder



Male x Solder

Architect/Engineer approval

Job Name _____ Date _____
Model Specified _____ Quantity _____
Variations Specified _____
Customer/Wholesaler _____
Contractor _____
Architect _____

Note: Information subject to change without notice.



Jomar International Ltd.
7243 Miller Drive
Warren, MI 48092
Phone: 800-325-5690
Fax: 800-628-4194
www.jomar.com

© Copyright 2006 Printed in U.S.A.
Dielectric GxC
04/06

Galvanized x Copper



Description

The most effective method for preventing piping system deterioration from accelerated corrosion due to galvanic and stray current is the use of dielectric unions.

Dimensions in Inches

Computer No.	Size	A	B	C	D	E
701-103	1/2"	1.63	1.04	.72	1.85	.82
701-104	3/4"	1.85	1.26	.72	2.03	1.07
701-105	1"	2.14	1.54	.72	2.27	1.32
701-106	1-1/4"	2.56	1.86	.85	2.52	1.57
701-107	1-1/2"	2.95	2.15	.97	2.53	1.83
701-108	2"	3.76	2.74	1.06	2.85	2.38
REDUCING						
701-204	3/4" x 1/2"	1.64	.82	.72	2.80	1.04
701-205	1" x 3/4"	1.85	1.07	.72	2.89	1.23
MIP x Solder						
701-303	1/2"	1.64	.82	.72	2.80	1.04
701-304	3/4"	1.85	1.07	.72	2.89	1.23
701-305	3/4" x 1/2"	1.64	.82	.72	2.58	1.23

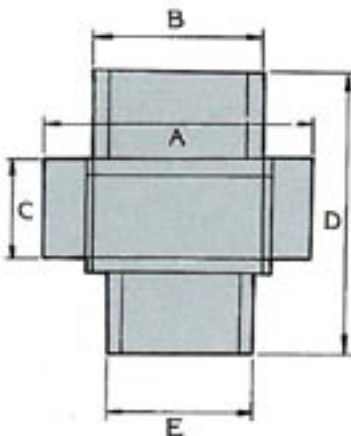

Material Specification

No.	Part Name	Materials
1	Body	Forged Steel
2	Tailpiece	Forged Brass
3	Union Nut	Forged Steel
4	Insulator	Plastic (nylon w/ fiber filled)
5	Gasket	BUNA-N (180°)

* For higher temperature service, teflon seats are available (220°)

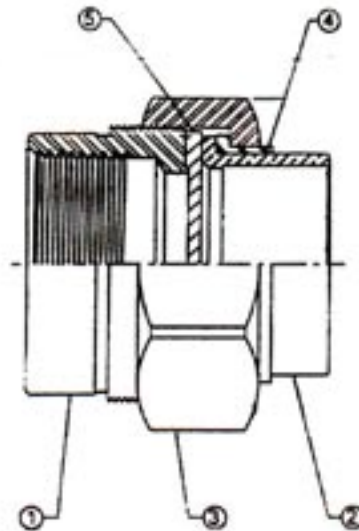

Note: Information subject to change without notice.