

SOCKET WELD FITTINGS CAPS · ASME B16.11

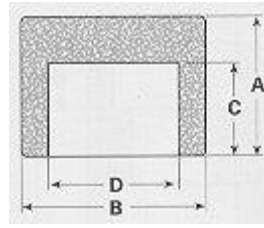

Class 3000

Pipe Size	1/81	1/42	3/81	1/21	3/41	1	1 1/4	1 1/2	2	2 1/2	3	4
Dimension A	11/16	11/16	3/4	13/16	15/16	1 1/16	1 1/16	1 1/8	1 5/16	1 7/16	1 5/8	1 7/8
Dimension B	3/4	1	1 1/16	1 1/4	1 1/2	1 7/8	2 1/4	2 1/2	3	3 5/8	4 5/16	5 1/2
Dimension C	3/8	3/8	3/8	3/8	1/2	1/2	1/2	1/2	5/8	5/8	5/8	3/4
Dimension D	.420	.555	.690	.855	1.065	1.330	1.675	1.915	2.406	2.906	3.535	4.545
Approx. Wt. #	.07	.14	.14	.20	.34	.64	.84	1.12	1.80	2.95	5.00	8.77

Class 6000

Pipe Size	1/81	1/42	3/81	1/21	3/41	1	1 1/4	1 1/2	2	2 1/2	3	4
Dimension A	3/4	3/4	13/16	13/16	1	1 1/8	1 1/8	1 3/16	1 3/16	1 9/16	2 11/16	2 11/16
Dimension B	7/8	1	1 1/8	1 3/8	1 11/16	2	2 1/2	2 3/4	3 5/8	4 1/4	5	6
Dimension C	3/8	3/8	3/8	3/8	1/2	1/2	1/2	1/2	5/8	5/8	5/8	3/4
Dimension D	.420	.555	.690	.855	1.065	1.330	1.675	1.915	2.406	2.906	3.535	4.545
Approx. Wt. #	.12	.14	.19	.30	.50	.79	1.22	1.56	3.47	5.20	7.64	12.75

Class 9000

Pipe Size	1/81	1/42	3/81	1/21	3/41	1	1 1/4	1 1/2	2	2 1/2	3	4
Dimension A	---	---	---	1 1/16	1 3/16	1 1/4	1 1/4	1 3/8	1 9/16	---	---	---
Dimension B	---	---	---	1 1/16	2	2 1/2	2 3/4	3	3 5/8	---	---	---
Dimension C	---	---	---	3/8	1/2	1/2	1/2	1/2	5/8	---	---	---
Dimension D	.420	.555	.690	.855	1.065	1.330	1.675	1.915	2.406	2.906	3.535	4.545
Approx. Wt. #	---	---	---	.59	.93	1.58	1.81	2.30	3.87	---	---	---

[Back to Capitol's Table of Contents](#)