

CleanStar® C60/C67 HPW with PFA T-body 1”

Ultra pure PFA diaphragm valve 2/2 way, manually operated (C67) and pneumatically operated (C60) with zero deadleg PFA T-valve body

- T-body design minimizes “dead legs” reducing “chemical holdout” and rinse times.
- Eliminates the need for tee fittings reducing associated pressure loss and overall cost of installation.
- Requires less mounting space, ideal for compact distribution boxes

Technical details refer to technical data sheet C60/C67 with straight through body.

Main tube				Branch/valve				Cv-Value (gal/min)
Ref. no.	Size	Connections	Ref. no.	Ref. no.	Size	Connections	Ref. no.	
16	1” tube	Flare-connection	75 a. 77	12	3/4” tube	Flare-connection	75 a. 77	4.7
16	1” tube	Flare-connection	75 a. 77	8	1/2” tube	Flare-connection	75 a. 77	2.9

How to order

C67 / Y8 / T / 75 / 30 / 5A / 1 / HPW / X16 / 75

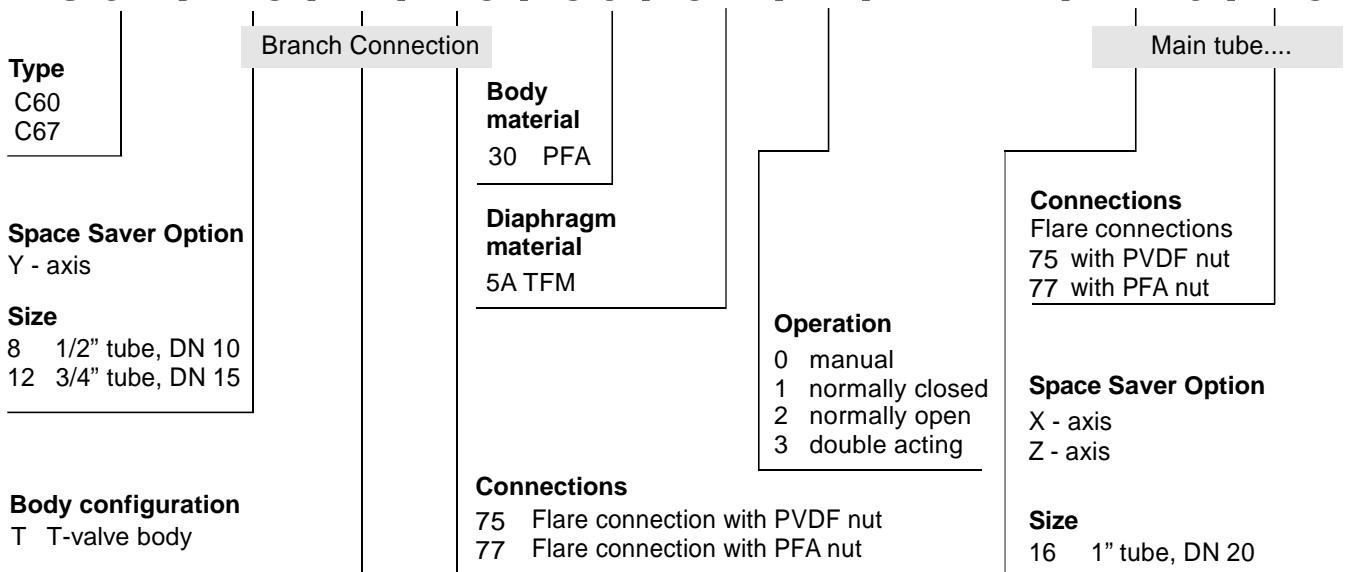

Dimensions

Flare connections (Ref. No. 75 and 77)

C 67

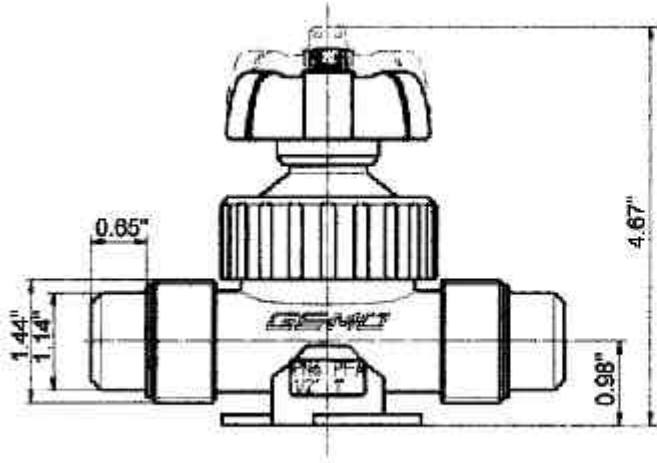

C 60

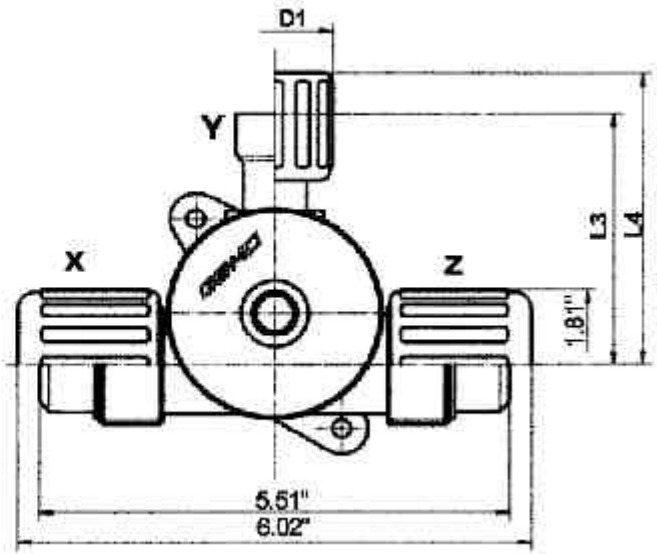
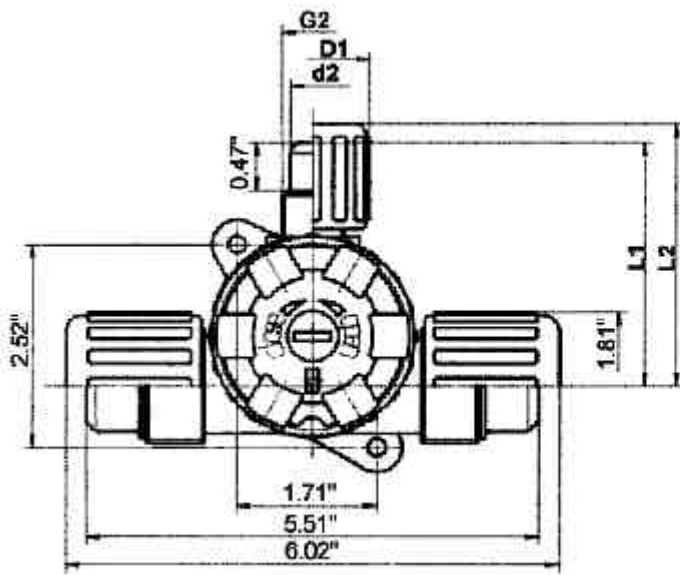
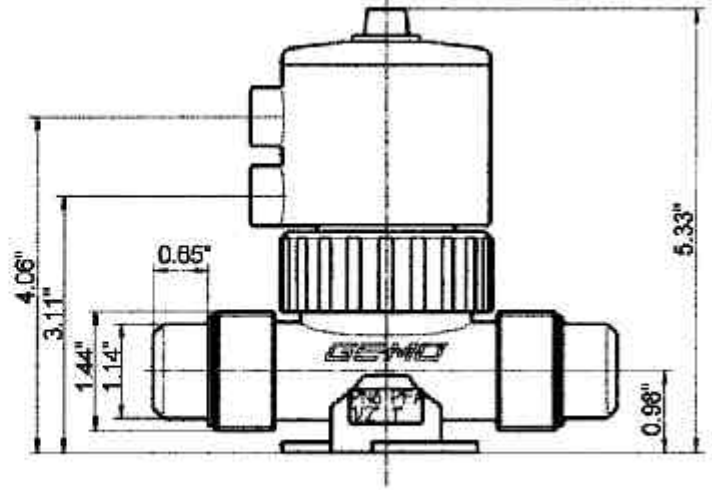

Space saver (pos. X, Y and/or Z)

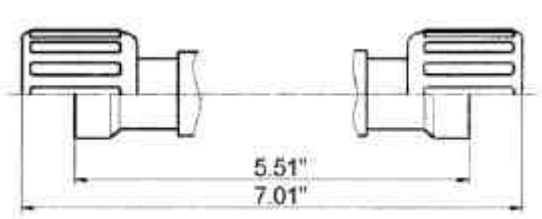

Size spigot	D1	G2	L1	L2	L3	L4	I2	d2	CV Value (gal/min)	Size main tube	d1
1/2"	1.06"	3/4"-20	3.01"	3.25"	3.01"	3.43"	0.59"	0.55"	2.9	1"	1.31"
3/4"	1.36"	1"-20	3.01"	3.25"	3.01"	3.48"	0.59"	0.80"	4.7	1"	1.31"