

Penn Machine

Class 6000 Square Head Plug

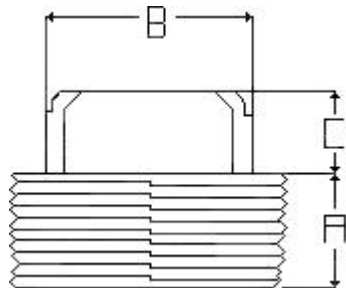

PENN CATALOG F2002 FIG NO. 06013
ASME-B16.11-2001

Nominal Pipe Size	1/8"	1/4"	3/8"	1/2"	3/4"	1"	1-1/4"	1-1/2"	2"	2-1/2"	3"	3-1/2"	4"	5"	6"
Dimension A	3/8	7/16	1/2	9/16	5/8	3/4	13/16	13/16	7/8	1-1/16	1-1/8	1-3/16	1-1/4	1-7/8	2
Dimension B	9/32	3/8	7/16	9/16	5/8	13/16	15/16	1-1/8	1-5/16	1-1/2	1-11/16	1-7/8	2-1/2	3-1/4	4-1/4
Dimension C	1/4	1/4	5/16	3/8	7/16	1/2	9/16	5/8	11/16	3/4	13/16	7/8	1	1-5/8	1-7/8
Approx. Wt. (lbs)	.02	.03	.06	.11	.18	.35	.60	.82	1.36	2.21	3.47	4.73	8.64	16.93	27.92

Penn Machine

Class 6000 Threaded Hex Plug

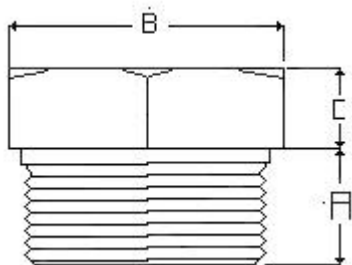

PENN CATALOG F2002 FIG NO. 06014
ASME-B16.11-2001

Nominal Pipe Size	1/8"	1/4"	3/8"	1/2"	3/4"	1"	1-1/4"	1-1/2"	2"	2-1/2"	3"	3-1/2"	4"	5"	6"
Dimension A	7/16	1/2	9/16	11/16	3/4	7/8	7/8	15/16	1	1-3/16	1-3/8	1-1/2	1-1/2	1-1/2	1-3/4
Dimension B	7/16	5/8	11/16	7/8	1-1/16	1-3/8	1-3/4	2	2-1/2	3	3-5/8	4-1/4	4-3/4	5-3/4	6-3/4
Dimension C	1/4	1/4	5/16	5/16	3/8	3/8	9/16	5/8	11/16	3/4	13/16	1	1	3/4	3/4
Approx. Wt. (lbs)	.03	.05	.09	.16	.27	.48	.95	1.32	2.23	3.81	4.75	8.37	13.00	15.61	22.32

[Fitting catalog](#) | [Product catalog](#) | [Request quote/information](#) | [Home](#)

Web site created by Penn Machine. Send questions or comments to [James Friant](#).