

120V PUCK

120V Puck lights provide versatile and dimmable lighting that does not require a transformer! Up to ten of these economical and easy to install pucks can be connected and either surface or recess mounted. Frosted lens covers eliminate glare and diffuse light evenly for task and accent lighting applications. Available in both kits and bulk to build your own plug-in or hardwire system. Choose between halogen and long life xenon in four stylish finishes.



FEATURES

- Easy to install kits – simply daisy chain together and plug in
- Hardwire box available (sold separately) for use when 120V power is stubbed out from the wall
- Dimmable with standard incandescent dimmers
- 120V lamps included, no transformer required
- Frosted twist-lock lens reduces glare
- Link up to ten pucks together
- Recess or surface mount
- Choose between xenon and halogen; kits and bulk



Black

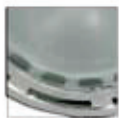

Chrome



White

KITCHEN COUNTERS CABINETS ARCHITECTURAL BUILT-INS COMPUTER DESKS
RETAIL ENVIRONMENTS DISPLAY CASES MEDICAL FACILITIES WORKSTATIONS



Surface Mount

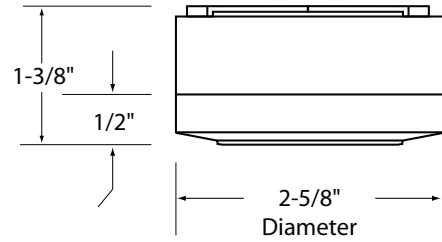

Recess Mount

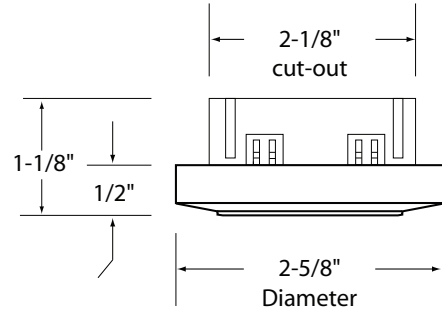

Bulk Puck Light



End Puck (one per kit)

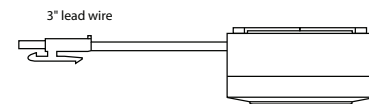

TECHNICAL SPECIFICATIONS

Voltage	120V, 60Hz AC operation
Construction	Heavy-duty, hard durable plastic
Dimensions	H = 1-3/8" (surface), 1/2" (recessed), Dia = 2-5/8"
Lead wires	Each puck light has 3" lead wire and 3" tail wire with molex connectors for linking purposes. Kits will have one puck light with only a lead wire (no tail wire) and this puck must be used as the last puck light in the run.
Switching	Control with hardwire box's rocker switch, switched outlet or with inline switch on power cord
Cut-out	2-1/8" hole size for recessed mounting
Wattage	20 watts per puck
Power cord	Single puck kits include a six-foot 18AWG power cord; kits with multiple puck lights include a six-foot power cord and enough 12" linking extensions to daisy chain pucks to each other.
Maximum run	Do not link more than ten puck lights in any single run
Linking	Kits include 12" linking extension(s) to connect puck lights. To build a bulk system, order linking extensions separately (see ACCESSORIES on page 33). Linking extensions are interconnectable up to five.
Packaging	Four color retail blister pack for kits; Two color box for bulk
Lamp specs	120V xenon = 3100°K White, 8,000 hours, 1-3/16" M.O.L.; 120V halogen = 2800°K White, 2,500 hours, 1-3/16" M.O.L.
Dimmers	Plug-in transformers are compatible with ALTPDIM (Hinge/Touch Pad Dimmer). Hardwire installations are dimmable with most standard incandescent dimmers (requires its own switch leg).
Diffuser	Frosted glass diffuser



120V PUCK

INSTALLATION EXAMPLE

Figure 1

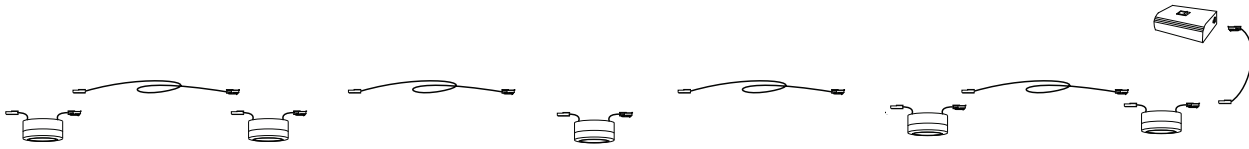
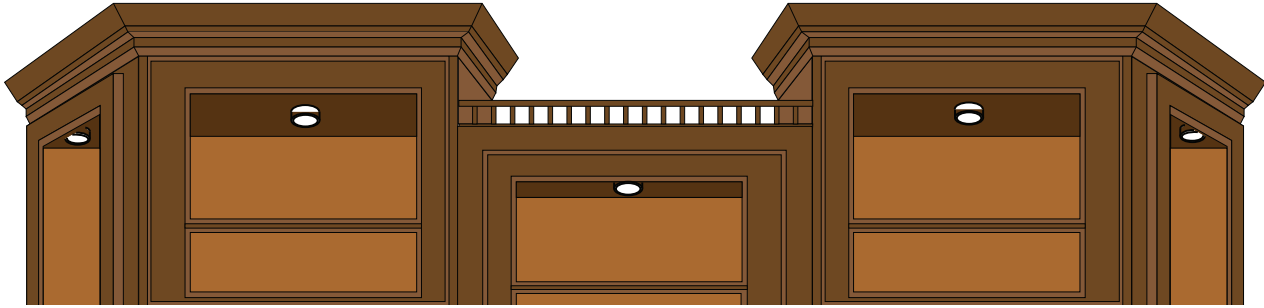

BILL OF MATERIALS

See layout examples above and accessories list on facing page for assistance in determining a bill of materials.

- Determine installation type (hardwire or plug-in)
- Consider using kits for plug-in installations and adding bulk pucks and extensions as needed
- For hardwire installations, order hardwire box, bulk pucks, and extensions as needed, allowing for distances between pucks and to hardwire box location

Lamps are included with each fixture.

Bill of materials for Figure 1 (above):

- (1) ALSLBOX
- (5) LVPX20BK-B
- (4) ALLVPEX24
- (1) ALLVPEX12

ORDERING INFORMATION

PRODUCT

LVPX		—	
120V	20 = One puck		BK = Black
Xenon Kits	40 = Two pucks		CH = Chrome
	80 = Four pucks*		WH = White

LVPX20		—	B
120V	BK = Black		
Xenon	CH = Chrome		
Bulk	GD = Gold		
	WH = White		

*LVPX80 is only available in BK and WH.

ALLVP20	
120V	BK = Black
Halogen	CH = Chrome
1-Light Kits	WH = White

ALLVP20		—	B
120V	BK = Black		
Halogen	CH = Chrome		
Bulk	GD = Gold		
	WH = White		

Note: LVPX kits contain one end puck to be used as the last puck in the run. See Power cord and Linking notes on page 31.

ORDERING INFORMATION

OPTIONAL

ALSL	<input type="checkbox"/>	LVPX20	<input type="checkbox"/>
	BOX = Black BOX-W = White	120V Xenon Bulk	-PC6 PC6WH EX12 EX12WH EX24 EX24WH
ALTPDIM			
LVPX20BP			
ALLVP20B			

ACCESSORIES

-		ALSLBOX ALSLBOX-WH-B	Slim-line hardwire box allows for direct wire of 120V xenon puck light products, 2 moxex outlets, 15 amp maximum, On/Off switch 4"L x 2.5"W x 1"H
-		ALLVP-PC6 ALLVPPC6WH	Power cord for 120V Puck lights. 6' cord with slide on plug, roll switch and female plug. 72" length, 18AWG c/UL/us Listed
-		ALLVPEX12 ALLVPEX12WH ALLVPEX24 ALLVPEX24WH	Linkable extensions – blister pack. 12" or 24" extensions to link up to ten puck lights together. Available in Black and White. 18AWG with male and female moxex connectors c/UL/us Listed
pg 128		ALTPDIM	Hinge or Touch Pad Dimmer. 300 watts maximum, 3 levels + off. Touch pad also included. 5' power cord with 8' extension cord c/UL/us Listed
pg 131		LVPX20BP	Twin pack of 20 watt 120V xenon lamps MOL = 1-3/8"
pg 131		ALLVP20B	Twin pack of 20 watt 120V halogen lamps MOL = 1-3/8"