

LOCK & PROTECT YOUR VALVES

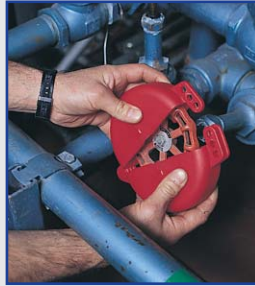

WITH "THE ORIGINAL" LOCKOUT

SAFELY • EFFICIENTLY • INEXPENSIVELY

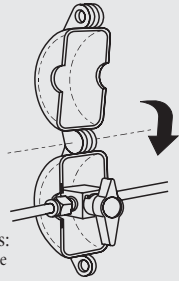

Special Application For Small Valves:
Modification: Drill a hole aligned with the first and close the lockout to completely cover the valve.

The V-SAFE valve cover consists of two flattened half moons that completely cover the valve wheel.

- Made of strong "Polypropylene" plastic.
- Fully dielectric.
- Highly resistant to cracking and abrasion.
- Resistant to extreme temperature changes from - 50° F (- 46° C) to 360° F (183° C).

TECHNICAL DATA

5 different sizes to cover valve handles from 1" to 14" diameter

Models	Inside Diameter A	Inside Height B	Outside Diameter C	Outside Height D	Lock Hole E	Valve Handle Size
VS02	2.750" 70 mm.	1.250" 32 mm.	3.000" 76 mm.	1.500" 38 mm.	0.312" 8 mm.	1" - 2 1/2"
VS04	5.000" 130 mm.	1.250" 32 mm.	5.500" 140 mm.	1.750" 44 mm.	0.375" 9.5 mm.	2 1/2" - 5"
VS06	6.500" 170 mm.	1.500" 38 mm.	7.000" 177 mm.	2.000" 50 mm.	0.375" 9.5 mm.	5" - 6 1/2"
VS09	10.000" 257 mm.	2.000" 50 mm.	10.500" 267 mm.	2.500" 63 mm.	0.375" 9.5 mm.	6 1/2" - 10"
VS13	14.000" 355 mm.	2.500" 63 mm.	14.500" 368 mm.	3.000" 73.8 mm.	0.375" 9.5 mm.	10" - 14"



Colors recommended in ANSI Z353.1
COLOR CHOICES

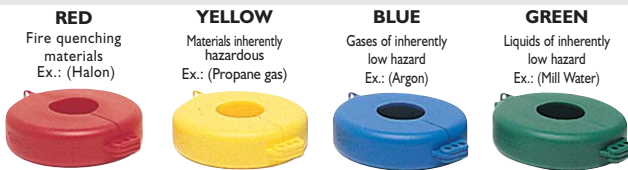

RED
Fire quenching materials
Ex.: (Halon)

YELLOW
Materials inherently hazardous
Ex.: (Propane gas)

BLUE
Gases of inherently low hazard
Ex.: (Argon)

GREEN
Liquids of inherently low hazard
Ex.: (Mill Water)

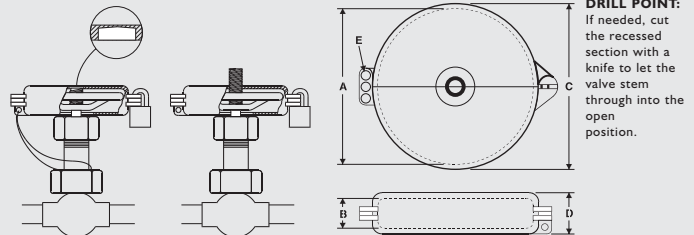

ELECTRICAL PLUG LOCKOUTS



PROTECT YOUR EMPLOYEES WITH THE E-SAFE LOCK-A-PLUG

The E-SAFE "LOCK-A-PLUG" completely encloses the plug from any accidental reconnection. The electrical cable is inserted through the opening and then closed. The single entry (LP110) or multiple entry (LP550) locking system avoids usage by unauthorized personnel during critical times. The E-SAFE is a practical and positive protection system. Made out of "Polypropylene" plastic, it is totally dielectric, resists cold or hot temperatures up to 300° F / 149° C, has a sliding closure and an integrated multiple lockout.

LP110

Will accept 110 volts and certain models of the 220 volt plug up to 13/4" x 13/4" x 3 1/4" (44.5 mm. x 44.5 mm. x 82 mm.) in size with a maximum cable diameter of 0.500" (12mm.).

INSTALLATION INSTRUCTIONS

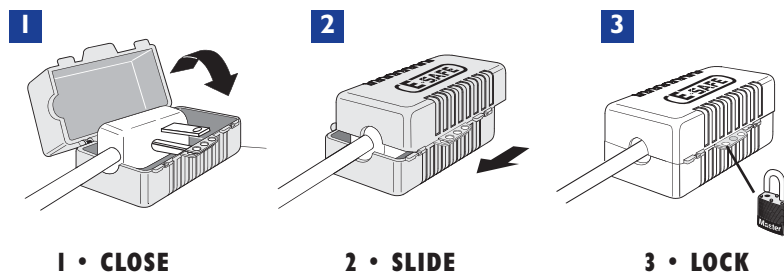

TECHNICAL DATA

Dimensions: E-SAFE LOCK-A-PLUG

Models	Inside Length A	Inside Height B	Inside Width C	Cable Hole D	Lock Hole E
LP110	3.250" 82 mm.	1.750" 44.5 mm.	1.750" 44.5 mm.	0.500" 12 mm.	0.312" dia 8 mm.
LP550	6.750" 170 mm.	3.000" 76 mm.	3.000" 76 mm.	1.000" 25 mm.	0.375" dia 9.5 mm.

LP550

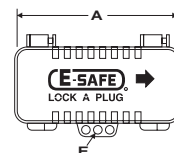

LP110

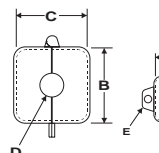

LP550

Will accept 220 volts and 550 volt plugs up to 3" x 3" x 6 3/4" (76 mm. x 76 mm. x 170 mm.) in size with maximum cable diameter of 1.000" (25 mm.).