

1800 SERIES VALVE AND EXTINGUISHER CABINETS



REGULARLY FURNISHED: 20 ga. box, 20 ga. tubular steel door with 20 ga. frame and a continuous steel hinge (brass pin). Steel corner seams welded and ground smooth. Recessed, semi-recessed and surface mounted cabinets are furnished with square edges. All components are powder-coated with an electrostatically-applied, thermally-fused, recoatable white polyester finish. Wall mounting and size of cabinet as selected by model number.

OPTIONAL MATERIALS:

Door and Frame available in aluminum, stainless steel, brass, or bronze. Red powder-coated finish available. When red finish is specified for door and frame, the box remains white, except for surface mounted cabinets. Refer to page 9.

OPTIONAL CONSTRUCTION:

Rolled-radius edges available, add Suffix “-RR”.

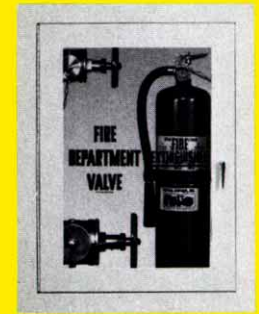

1870 SERIES

FOR USE WITH

- 2½" / 6.4 cm FIRE DEPT VALVE
- PORTABLE FIRE EXTINGUISHER

FUNCTION: 1870 Series cabinets accommodate a 2½" / 6.4 cm fire dept valve with cap, chain and a portable fire extinguisher on shelf above the valve.

ORDERING INFORMATION

- Select cabinet model number
- Select cabinet door style (Refer to page 10)
- Select type of fire dept valve with cap and chain (Refer to Section 4000)
- Select type and size of fire extinguisher (Maximum sizes are 20 lb./9 kg dry chemical, or 10 lb./4.5 kg carbon dioxide. Refer to Section 3000)

SPECIFICATION: Combination fire extinguisher and fire dept valve cabinet shall be Model No. _____ as manufactured by Potter-Roemer, Cerritos, CA 800-366-FIRE; door style Suffix _____, containing a 2½" / 6.4 cm Model No. _____ fire dept valve with Model No. _____ cap and chain Model No. _____ fire extinguisher. (If reducer and 1½" / 3.8 cm cap is required, specify 10" / 25.4 cm deep can recessed.)

FOR USE WITH

- 1½" / 3.8 cm FIRE DEPT VALVE
- 2½" / 6.4 cm FIRE DEPT VALVE
- PORTABLE FIRE EXTINGUISHER

FUNCTION: 1880 Series cabinets accommodate a 1½" / 3.8 cm and 2½" / 6.4 cm fire dept valve with cap, chain and a portable fire extinguisher.

ORDERING INFORMATION

- Select cabinet model number
- Select cabinet door style (Refer to page 10)
- Select type of fire dept valve with cap and chain (Refer to Section 4000)
- Select type and size of fire extinguisher (Maximum sizes are 10 lb./4.5 kg dry chemical or 5 lb./2.3 kg carbon dioxide. Refer to Section 3000)

SPECIFICATION: Combination fire extinguisher and fire dept valve cabinet shall be Model No. _____ as manufactured by Potter-Roemer, Cerritos, CA 800-366-FIRE; door style Suffix _____, containing a 1½" / 3.8 cm Model No. _____; a 2½" / 6.4 cm Model No. _____ fire dept valve with Model No. _____ cap and chain; Model No. _____ fire extinguisher. (If reducer and 1½" / 3.8 cm cap is required, specify 10" / 25.4 cm deep can recessed.)

Model No.	Wall Mounting	MAX. CAPACITY			Overall Frame		Wall Opening Required			Trim T	Inlet Location				Shelf ZZ	ADA
		K	L	M	N	O	W	H	D		W	X	Y	Z		
		in. cm	in. cm	in. cm	in. cm	in. cm	in. cm	in. cm	in. cm	in. cm	in. cm	in. cm	in. cm	in. cm	in. cm	in. cm
1870 VALVE AND EXTINGUISHER CABINET WITH SHELF																
1870	Recessed	14	40	8	17¾	43¾	15	41	8½	5/8	—	—	4	4	12	Yes
		35.5	101.6	20.3	45	111.1	38.1	104.1	21.5	1.5	—	—	10.2	10.2	30.4	
1871	Trimless	14	40	8¾	17	43	15	41	9¼	—	—	—	4	4	12	Yes
		35.5	101.6	22.2	44.4	109.2	38.1	104.1	23.4	—	—	—	10.2	10.2	30.4	
1872	Semi-Recessed	14	40	8	17½	43½	15	41	6½	2	—	—	4	4	12	Yes
		35.5	101.6	20.3	44.4	110.5	38.1	104.1	16.5	5	—	—	10.2	10.2	30.4	
1875	Surface	16	42	9¼	—	—	—	—	—	9¼	—	—	—	—	12	No
		40.6	106.6	23.4	—	—	—	—	—	23.4	—	—	—	—	30.4	
1880 VALVE AND EXTINGUISHER CABINET WITH SHELF																
1880	Recessed	18	24	8	21¾	27¾	19	25	8½	5/8	4	4	4	4	—	Yes
		45.7	61	20.3	55.2	70.4	48.2	63.5	21.5	1.5	10.2	10.2	10.2	10.2	—	
1881	Trimless	18	24	8¾	21	27	19	25	9¼	—	4	4	4	4	—	Yes
		45.7	61	22.2	53.3	68.6	48.2	63.5	23.4	—	10.2	10.2	10.2	10.2	—	
1882	Semi-Recessed	18	24	8	21½	27½	19	25	6½	2	4	4	4	4	—	Yes
		45.7	61	20.3	54.6	69.8	48.2	63.5	16.5	5	10.2	10.2	10.2	10.2	—	
1885	Surface	20	26	9¼	—	—	—	—	—	9¼	—	—	—	—	—	No
		50.8	61	23.4	—	—	—	—	—	23.4	—	—	—	—	—	

All dimensions in English and Metric.

1880 SERIES

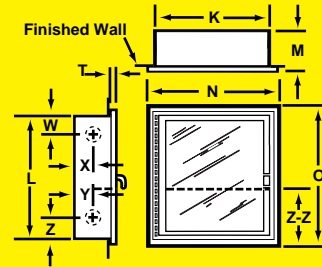

RECESSED

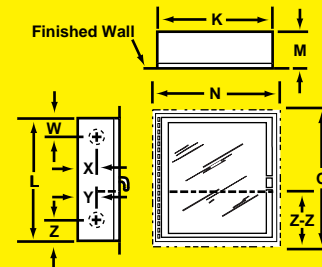

TRIMLESS

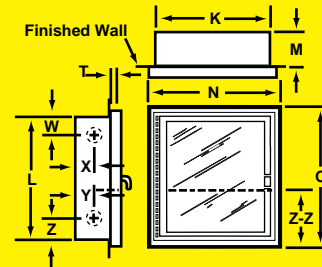

SEMI-RECESSED

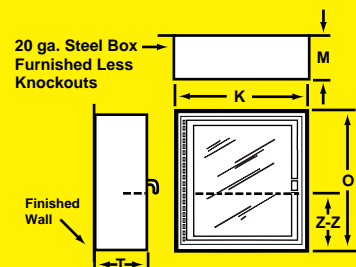

SURFACE

20 ga. Steel Box
Furnished Less
Knockouts