

Test Plugs



Gauge Adaptor

Description & Features:

- Facilitates quick pressure and temperature readings at recommended test points within process

Applications:

- Mainly used in heating, ventilation and air conditioning industries

Specifications	
Material/Body	Brass
Diaphragm/Core	EPDM
Temperature Rating	350°F (176°C)
Maximum Pressure Rating	1,000 psi (6895 kPa)
Connection	1/4" NPT or 1/2" NPT

Order Codes (products in bold are normally in stock)

Brass Test Plug	
1/4" NPT Connection Male	STP001
1/2" NPT Connection Male	STP002

Gauge Adaptor	
2.75 OAL x 1.75" x 0.125" probe	STP003
2.25 OAL x 1.75" x 0.125" probe	STP004

Note: Other sizes and materials available upon request

Gauge Adaptor 2.25"

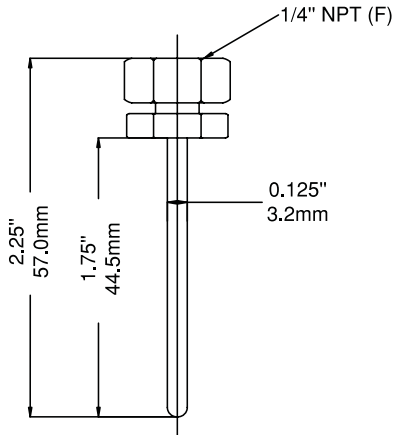

Gauge Adaptor 2.75"

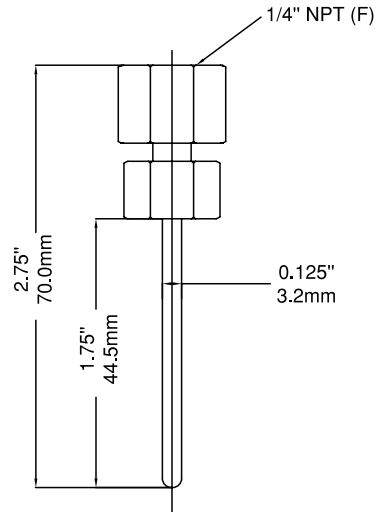

0.25" Test Plug

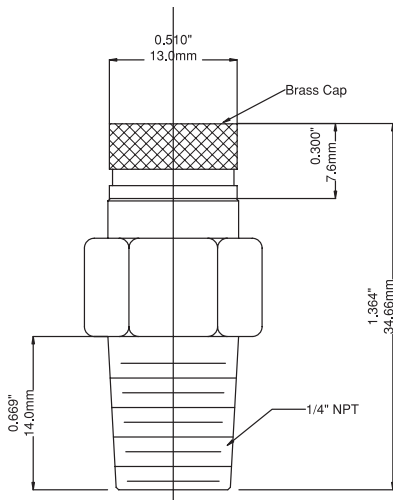

0.5" Test Plug

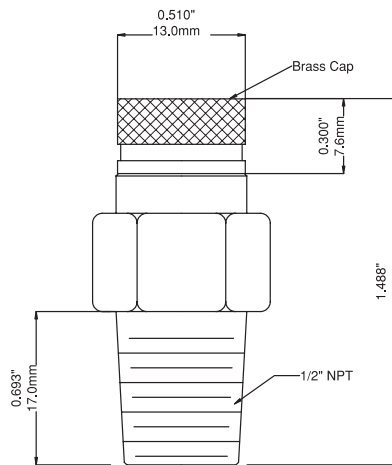

Series Number (for custom, non-standard product)



- SERIES**
- CONNECTION SIZE**
- 1/4"
- 3/8"
- 1/2"
- CONNECTION THREAD**
- NPT
- BSP
- BSPT

- 4
- 3
- 2
- N
- B
- T