

15 to 1,000 psi (105 to 6,900 kPa)



Description & Features:

- Compact (one piece), lightweight and economical
- CRN registered
- 1 year warranty

Applications:

- Ideally suited for applications where space limitations exist
- Primarily utilized to protect gauges and transmitters from corrosive media
- Utilized in many OEM applications

Specifications	
Housing	AISI 316 SS
Diaphragm	AISI 316L SS, welded
Minimum Operating Pressure	15 psi
Maximum Operating Pressure	1,000 psi (6,900 kPa)
Gauge Connection	1/4", 1/2" NPT female
Process Connection	1/4", 1/2" NPT female
Process Temperature	-49°F to 302°F (-45°C to 150°C)

Order Codes (products in bold are normally in stock)

1/4" NPT x 1/4" NPT	1/4" NPT x 1/2" NPT	1/2" NPT x 1/2" NPT
D40973	D40972	D40974

Option suffix for above order codes only:

SF-D = Silicone fill (seal only)

D40 #40 Diaphragm Seal

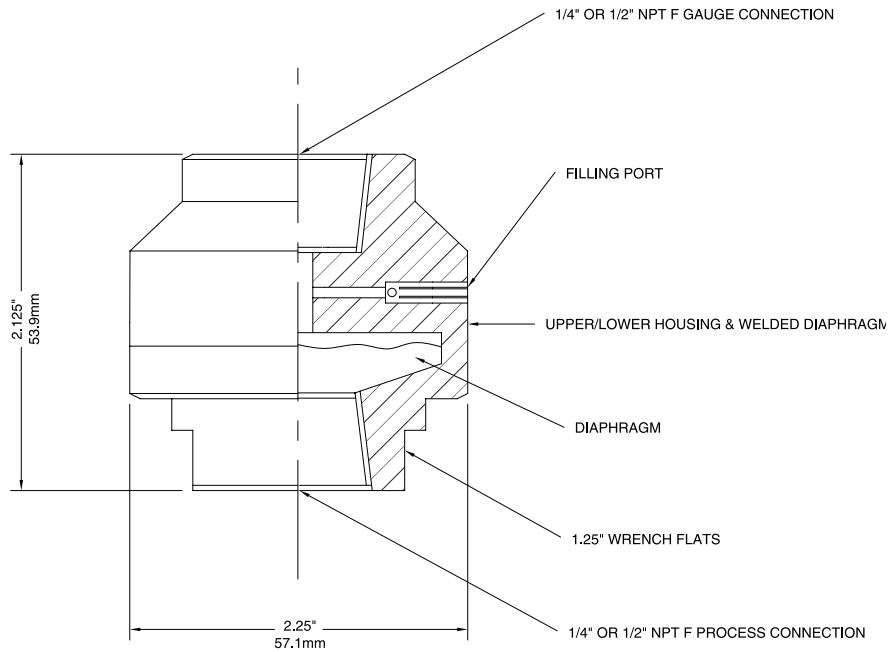

Series Number

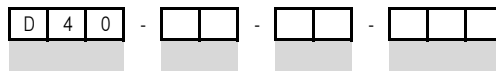

SERIES

GAUGE CONNECTION

1/4" NPT female	4	N
3/8" BSP female	3	B
1/2" BSPT female	2	T

PROCESS CONNECTION

1/4" NPT female	4	N
3/8" BSP female	3	B
1/2" BSPT female	2	T

OPTIONS

1m SS Remote Capillary	1
1.6m SS Remote Capillary	6
2m SS Remote Capillary	2
3m SS Remote Capillary	3
4m SS Remote Capillary	4
5m SS Remote Capillary	5
8m SS Remote Capillary	8
Others	X
No Armour	0
SS Armour	S
Glycerine/water-filled (-10/120C)	A
Silicone-filled (-20/200C)	B
Silicone-filled (-90/100C)	C
Halocarbon (-40/175C)	D
Fluorolube-filled	E
High Temperature Oil (-20/400C)	F