

D40 #40 Diaphragm Seal

15 to 1,000 psi (105 to 6,900 kPa)



Description & Features:

- Compact (one piece), lightweight and economical
- CRN registered
- 1 year warranty

Applications:

- Ideally suited for applications where space limitations exist
- Primarily utilized to protect gauges and transmitters from corrosive media
- Utilized in many OEM applications

Specifications	
Housing	AISI 316 SS
Diaphragm	AISI 316L SS, welded
Minimum Operating Pressure	15 psi
Maximum Operating Pressure	1,000 psi (6,900 kPa)
Gauge Connection	1/4", 1/2" NPT female
Process Connection	1/4", 1/2" NPT female
Process Temperature	-49°F to 302°F (-45°C to 150°C)

Order Codes (products in bold are normally in stock)

1/4" NPT x 1/4" NPT	1/4" NPT x 1/2" NPT	1/2" NPT x 1/2" NPT
D40973	D40972	D40974

#40 Diaphragm Seal D40

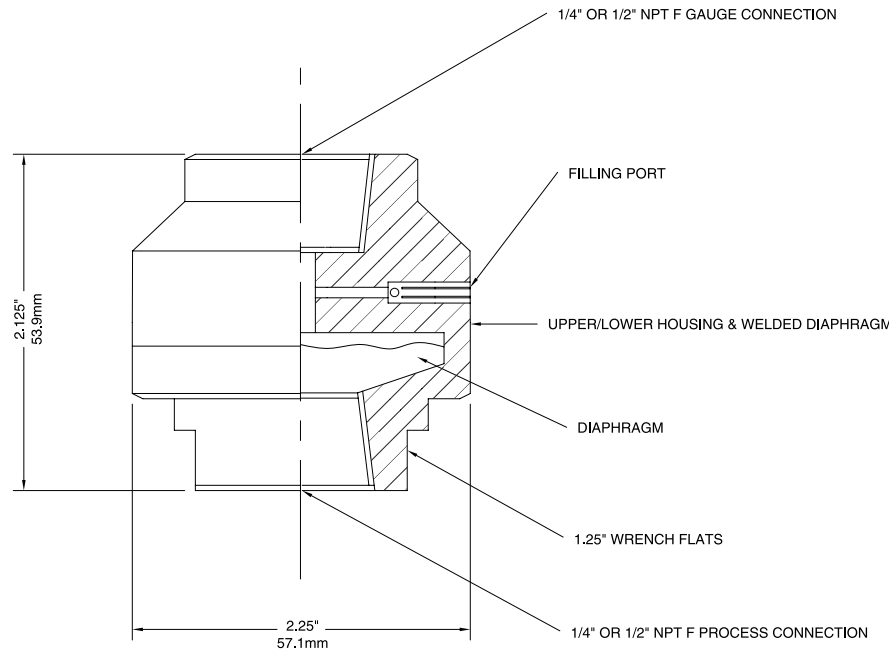

Series Number



SERIES

GAUGE CONNECTION

- 1/4" NPT female
- 3/8" BSP female
- 1/2" BSPT female

- 4 N
- 3 B
- 2 T

PROCESS CONNECTION

- 1/4" NPT female
- 3/8" BSP female
- 1/2" BSPT female

- 4 N
- 3 B
- 2 T

OPTIONS

- 1m SS Remote Capillary
- 1.6m SS Remote Capillary
- 2m SS Remote Capillary
- 3m SS Remote Capillary
- 4m SS Remote Capillary
- 5m SS Remote Capillary
- 8m SS Remote Capillary
- Others
- No Armour
- SS Armour
- Glycerine/water-filled (-10/120C)
- Silicone-filled (-20/200C)
- Silicone-filled (-90/100C)
- Halocarbon (-40/175C)
- Fluorolube-filled
- High Temperature Oil (-20/400C)

- 1
- 6
- 2
- 3
- 4
- 5
- 8
- X
- 0
- S
- A
- B
- C
- D
- E
- F