



Description & Features:

- Economical 2" (50mm) gauge with built-in safety features
- Safety blowout back steel case
- Easy to read coloured pressure zones on the dial
- UL Listed
- 3 year warranty

Applications:

- Beverage dispensing, regulators and tanks. Low pressures are used on the down stream side of a regulator. High pressures are used for measuring cylinder gas or tank pressures



Specifications	
Dial	1.5" (40mm), 2" (50mm)
Case	Steel with blowout back, painted black
Lens	Acrylic
Ring	Steel, painted black
Socket	Brass
Connection	1/8" or 1/4" NPT, bottom or back
Bourdon Tube	Brass
Movement	Brass
Pointer	Aluminum, painted black
Over-Pressure Limit	25% of full scale value
Working Pressure	Maximum 75% of full scale value
Ambient/Process Temperature	-40°F to 150°F (-40°C to 65°C)
Accuracy	±3-2-3% ANSI/ASME Grade B
Enclosure Rating	IP52

Order Codes

Dial Size	1.5" (40mm)	2" (50mm)	
Connection	1/8" NPT Back	1/8" NPT Back	1/4" NPT Bottom
0 - 30 psi	PCG9014	-	PCG9020
0 - 60 psi	PCG9015	-	PCG9021
0 - 100 psi	-	PCG9017	PCG9022
0 - 160 psi	PCG9016	PCG9018	PCG9023
0 - 300 psi	-	PCG9019	PCG9024
0 - 2,000 psi	-	-	PCG9025
0 - 3,000 psi	-	-	PCG9026

Note: Other configurations available. Dual scale available upon request

UL252A recognized - low pressures 30-300 psi

UL404 listed - high pressures 2000 psi and 3000 psi

1.5" Back Connection, 1/8" NPT

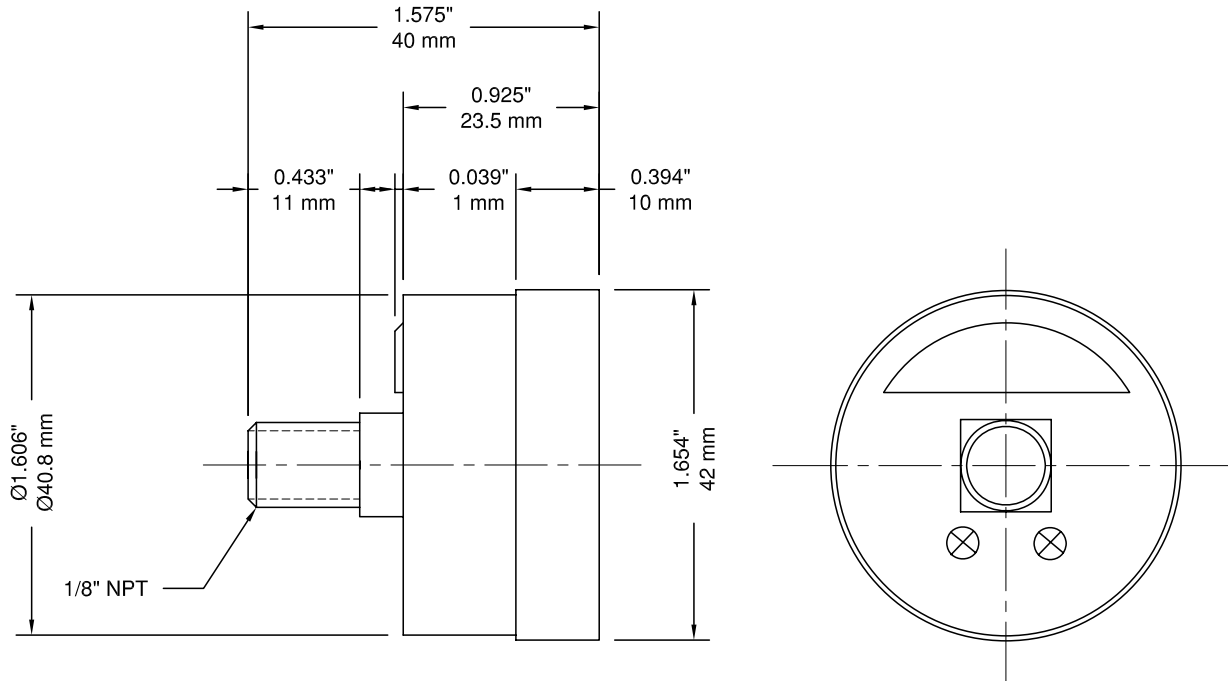

2" Back Connection, 1/8" NPT

