

# LGT/MGT/VGT/HGT Girder Tiedowns

The LGT, MGT, VGT and HGT are girder tiedowns for moderate to high load capacity applications. The LGT and VGT are also suitable for retrofit applications.

LGT connectors provide a low profile connection to the studs for easy installation of drywall. Simple to install and can be installed on the inside or outside of the wall. LGT connectors also provide exceptional bearing enhancement for heavy download applications. The LGT series has been extended to include the new LGT4-SDS3 for 4-ply girders.

The Variable Girder Tiedown (VGT) is a higher capacity alternative to the LGT and MGT for girder trusses. It attaches with Simpson Strong-Tie® Strong-Drive® screws (SDS) to the side of truss and features a predeflected crescent washer that allows it to accommodate top chord pitches up to 8:12. The VGT is also available with one flange concealed for attachment to trusses with no tail.

The HGT offers the highest uplift capacity for girders and can be installed on trusses and beams with top chord slopes up to 8:12.

**MATERIAL:** HGT, VGT—7 gauge, LGT2—14 gauge, MGT, LGT3, LGT4—12 gauge.

**FINISH:** HGT—Simpson Strong-Tie gray paint; LGT, MGT, VGT—Galvanized

**INSTALLATION:** • When the HGT-3 is used with a 2-ply girder or beam, shimming is required. Fasten to act as one unit.

- Before installing fasteners, ensure LGT3-SDS2.5 makes complete contact with bottom of truss.
- SDS screws included with LGT3, LGT4 and VGT Series.
- VGT—Screw holes are configured to allow for double installation on a two-ply (minimum) truss.
- VGT—The product can be installed in a single application or in pairs to achieve a higher uplift capacity.
- VGT—When installed on trusses with no overhangs, specify VGTR/L.
- VGT—Install washer component (provided) so that top of washer is horizontal as well as parallel with top of wall top plate.
- LGT3-SDS2.5—The four large hexagon holes are intended for CMU and concrete applications.
- See page 146-147 for masonry applications.

**OPTIONS:** LGT3 and LGT4 are available with reduced widths of  $W = 4\frac{1}{16}"$  and  $W = 6\frac{3}{8}"$  — order as LGT3N-SDS2.5 and LGT4N-SDS3.

**CODES:** See page 12 for Code Reference Key Chart.

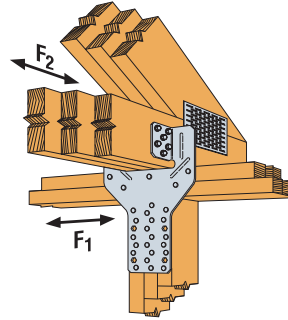
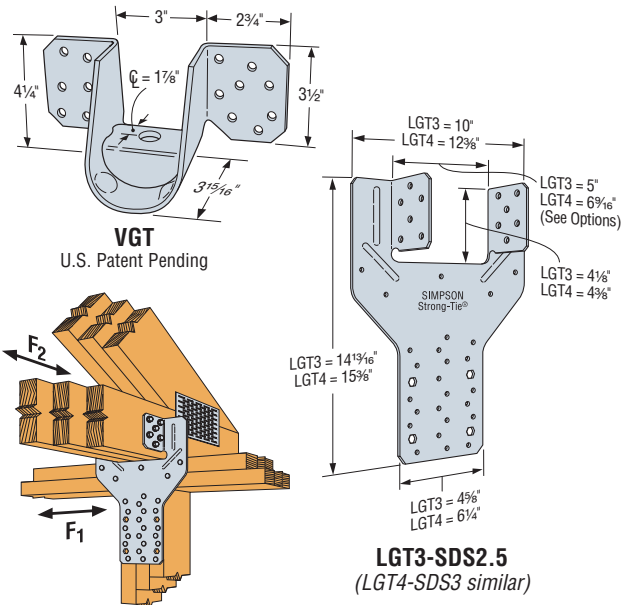

**Typical LGT3-SDS2.5 Installation**

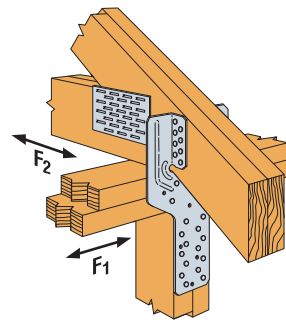

**Typical LGT2 Installation**

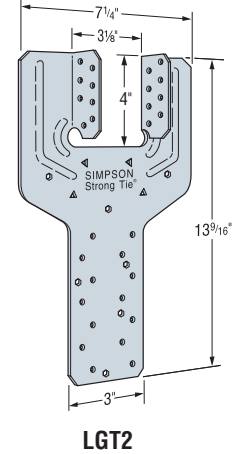

**LGT2**

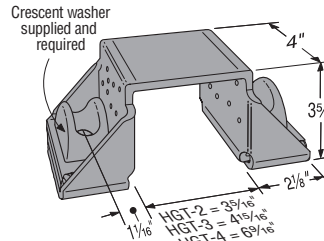

**HGT-2**  
(HGT-3, HGT-4 similar)

Install two LBP5/8" washers on top of each crescent washer (total four 5/8" washers) for wood installation. All washers and crescent washers are required. Crescent washers are supplied.

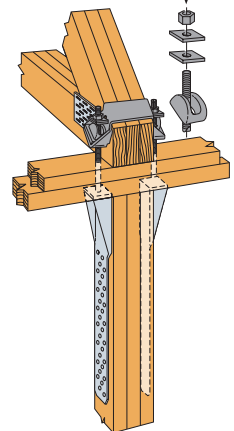

**Typical HGT-3 Installation with HTT22s**

Model No.	Qty.	No. of Plies	O.C. Dim. Between Anchors	Fasteners		DF/SP Allowable Uplift Loads (160)	SPF/HF Allowable Uplift Loads (160)	Code Ref.
				Nails or Anchor Diameter	Girder			
LGT2	1	2 ply	—	14-16d Sinkers	16-16d Sinkers	2050	1785	F26
LGT3-SDS2.5	1	3 ply	—	26-16d Sinkers	12-SDS 1/4"x2 1/2"	3685	2655	
LGT4-SDS3	1	4 ply	—	30-16d Sinkers	16-SDS 1/4"x3"	4060	2925 <sup>b</sup>	
MGT	1	2 ply	—	1-5/8"	22-10d	3965	3300	
VGT	1	2 ply min.	—	1-5/8"	16-SDS 1/4"x3"	4940	3555	
	2	2 ply min.	—	2-5/8"	32-SDS 1/4"x3"	7185	5175	
	3	3 ply min.	—	2-5/8"	32-SDS 1/4"x3"	8890	6400	
VGTR/L	1	2 ply min.	—	1-5/8"	16-SDS 1/4"x3"	2230	1605	
	2	2 ply min.	—	2-5/8"	32-SDS 1/4"x3"	5545	3990	
HGT-2	1	2 ply	5 3/4"	2-5/8"	16-10d	10980	6485	
HGT-3	1	3 ply	7 3/8"	2-5/8"	16-10d	10530	9035	IL15,
HGT-4	1	4 ply	9"	2-5/8"	16-10d	9250	9250	F16

1. Attached members must be designed to resist applied loads.
2. Allowable loads have been increased 60% for wind or earthquake loading with no further increase allowed; reduce where other loads govern.
3. LGT2—F<sub>1</sub> load = 700 lbs.; F<sub>2</sub> load = 170 lbs. with installation of 4-16d sinkers optional nail holes.
4. LGT3—F<sub>1</sub> load = 795 lbs.; F<sub>2</sub> load = 410 lbs.
5. LGT4—F<sub>1</sub> load = 2000 lbs.; F<sub>2</sub> load = 675 lbs. with installation of 7-16d sinkers in optional nail holes.
6. LGT4—Uplift for DF/SP girder and SPF studs is 3860 lbs.
7. MGT can be installed with straps vertical for full table load provided all specified nails are installed to either a solid header or minimum double 2x6 web.
8. LGT connectors can provide bearing enhancement loads for truss download reactions. The DF/SP allowable load shall be 2060 lbs. for LGT2 and 4100 lbs. for LGT3 and LGT4 (for SPF/HF values use a 0.68 multiplier). For more information refer to technical bulletin T-HTIEBEARING (see page 191 for details).
9. Girder tiedowns installed on the outside of the wall require a 3 1/2" overhang to achieve table loads.
10. **NAILS:** 16d Sinker = 0.148" dia. x 3 1/4" long, 10d = 0.148" dia. x 3" long. See page 16-17 for other nail sizes and information.

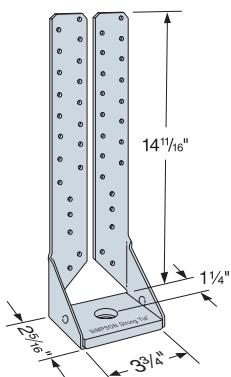

**MGT**

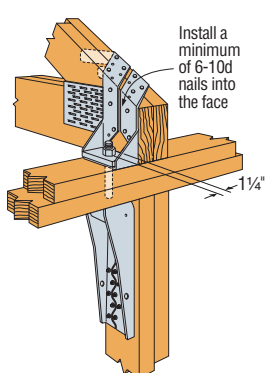

**Typical MGT Installation with HDU4**

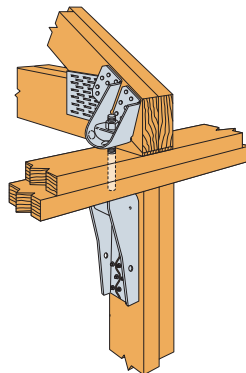

**Typical VGTR Single Installation with HDU2**

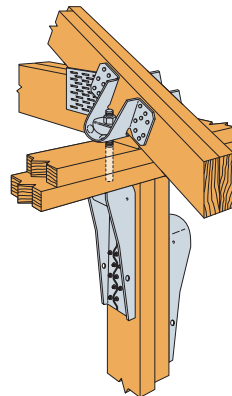

**Typical VGT Double Installation with HDU4's**