

HANGER OPTIONS

MBHA

See Hanger Options General Notes.

SKEWED SEAT

- Seat can be skewed at 45° only. The maximum allowable download is 3495 lbs. and 1585 lbs. uplift for Height 7¼". For all other models, use the table listed download and uplift of 2390 lbs.

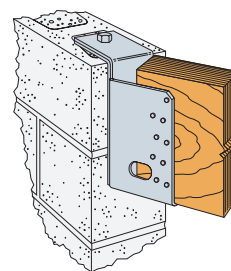

Typical MBHA
Skewed Right
Installation

WM/WMI/WMU

See Hanger Options General Notes.

INSTALLATION: • Bevel-cut the joist for skewed hangers (*see illustration*).

HANGER HEIGHT

- For hanger heights exceeding the joist height, the allowable load is 0.50 of the table load.

SLOPED AND/OR SKEWED SEAT

- WM/WMI may be skewed and/or sloped to 45° maximum.
- The allowable load is 100% of the table load.

OFFSET TOP FLANGE

- The top flange may be offset left or right for placement at the end of a header. The allowable load is 0.50 of the table roof load.

UPLIFT (WMU Only)

- No modifications on WMU.

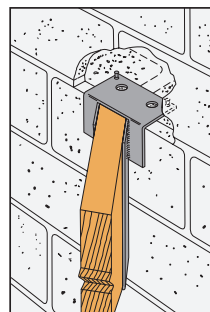

Typical WM Sloped Down,
Skewed Right Block Wall Installation

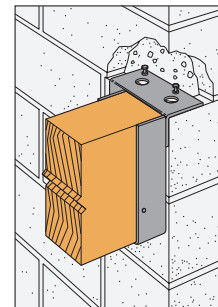

Typical WM
Top Flange Offset Left

GH Girder Hanger

See Hanger Options General Notes.

SKEWED SEAT

- GH hangers may be skewed to a maximum of 45°; bevel cut required.
- The allowable loads are 100% of the table load.
- Specify GHD for saddle-style hangers. GHD may not be skewed.

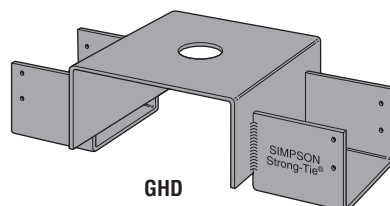

GHD

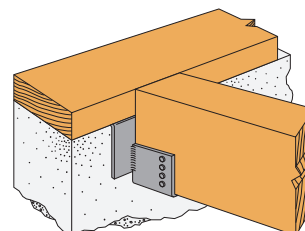

Typical GH
Installation
Skewed Right