

HTC Heavy Truss Clips

For alignment control between a roof truss and nonbearing walls; the 2½" slot permits vertical truss chord movement when loads are applied.

MATERIAL: 18 gauge

FINISH: Galvanized

INSTALLATION: • Use all specified fasteners; see General Notes.

- The HTC has a 2½" slot to accommodate truss movement
- This connector has high lateral capacity.
- The S/HTC is available for steel truss applications.

CODES: See page 12 for Code Reference Key Chart.

Model No.	Dimensions			Fasteners		Allowable Loads ¹ (160)				Code Ref.
	Top Plate	Base	Slot	Without Gap ²		With 1¼" Gap ³		F ₁	F ₂	
				F ₁	F ₂	F ₁	F ₂			
HTC4	2x4 Plate	6-10d	3-10d	390	305	85	280	170		
	2x6 Plate	6-10d	3-10d	485	280	155	280			

1. Loads may not be increased for short-term loading.
2. Truss or rafter must be bearing on top plate to achieve the allowable loads under "WITHOUT GAP."
3. When installed with maximum 1¼" space between rafter or truss and top plate use loads under "WITH 1¼" GAP." Where loads are not required, space is not limited to 1¼".
4. **NAILS:** 10d = 0.148" dia. x 3" long.
See page 16-17 for other nail sizes and information.

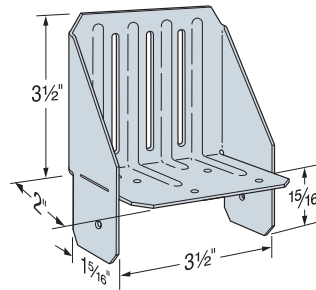

HTC4

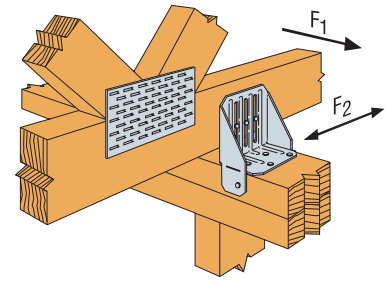

Typical HTC4 Installation on a 2x4 Plate

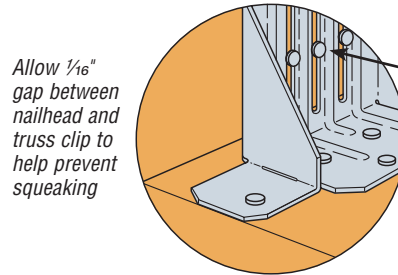

Allow 1/16" gap between nailhead and truss clip to help prevent squeaking

Nails should not be driven completely flush against the connector, to allow vertical truss movement.

Typical HTC4 Installation on a 2x6 Plate

STC/STCT/DTC Roof Truss Clips

For alignment control between a roof truss and nonbearing walls; the 1½" slot permits vertical truss chord movement when loads are applied.

MATERIAL: 18 gauge

FINISH: Galvanized

INSTALLATION: • Use all specified fasteners; see General Notes.

- Use STC or DTC depending on required loads. STC, installed with Drywall Stop (DS), helps prevent fasteners tearing through the ceiling sheetrock (see illustration).
- Use STCT where truss or rafter is separated from the top plate of the nonbearing wall.
- Install slot nails in the middle of the slot.

CODES: See page 12 for Code Reference Key Chart.

Model No.	Fasteners		Allowable Loads ¹ (160)					Code Ref.	
	Base	Slot	Without Gap ²		¼" Max Gap		¼" < Gap ≤ ½"		
			F ₁	F ₂	F ₁	F ₂	F ₁		F ₂
STC	2-8d	1-8d	85	55	35	35	30	40	170
STCT	2-8d	1-8d	—	—	—	—	—	—	
DTC	4-8d	2-8d	125	210	85	135	55	70	

1. Loads may not be increased for short-term loading.
2. Truss or rafter must be bearing on top plate to achieve the allowable loads under "WITHOUT GAP."
3. Clips are required on both sides of the truss to achieve F₁ loads in both directions (stagger parts to avoid nail interferences).
4. **NAILS:** 8d = 0.131" dia. x 2½" long.
See page 16-17 for other nail sizes and information.

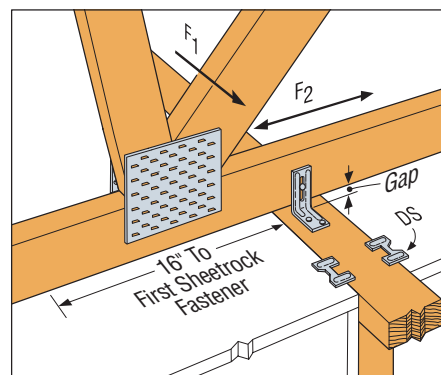
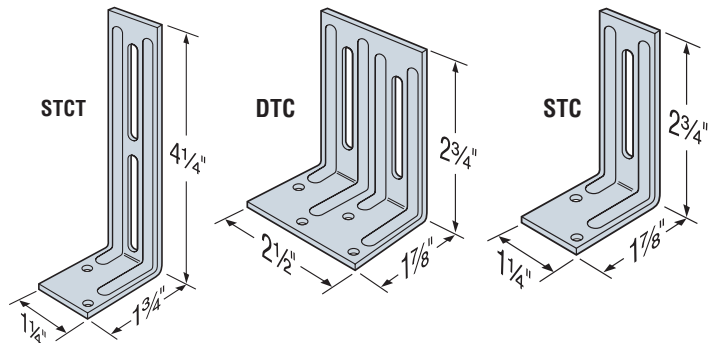

Typical STC Installation with DS

Nails should not be driven completely flush against the connector, to allow vertical truss movement.